

FILED FOR RECORD
SKAMMAGAWASH
BY *Donald Karsch*

Aug 16 1 34 PM '02

Q. Young
AUDITOR
J. MICHAEL GARVISON**LAND CORNER RECORD**

GRANTOR/SURVEYOR/PUBLIC OFFICER: This corner record correctly represents work performed by me or under my direction, in conformance with the Survey Recording Act.

COMPANY OR AGENCY: USDA Forest Service

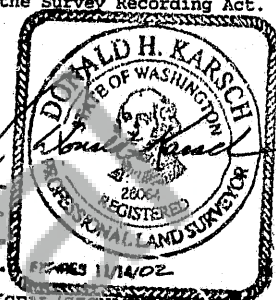
ADDRESS: Gifford Pinchot National Forest
10600 NE 51st Circle
Vancouver WA 98682*Don Karsch*
Forest Land Surveyor8/9/2002
Date

GRANTOR: PUBLIC

LEGAL: TWP: 4 NORTH RGE: 7 EAST CORNER CODE: RS-16
ADDITIONAL IDENTIFIER: (BLM designation, street, or plat names, block, lot, etc.)

COUNTY: SKAMMAGAWASH

WASHINGTON PLANE COORDINATES: N: E:

ORDER: ZONE: DATUM: (DATE OF ADJUSTMENT):

CORNER INFORMATION: Discuss the history, evidence found, and perpetuation of the corner. Diagram the references; provide the date of work; and if applicable, a reference to a map of record and/or the field book/page no. Use the back, if needed.

Corner History:

This corner was originally established by Larry Bishop, PLS #16337 in 1981, and monumented with a 2 1/4" x 30" galvanized steel pipe with a 2 1/4" brass cap. He also marked 2 bearing trees:

A 14" D. Fir - N65°W, 75.7 ft. scribed "CNNE 1/64 S27."

An 18" D. Fir - N40°E, 65.1 ft. scribed "CNNE 1/64 S27."

On July 16, 2002 I found the corner monument in good condition, set in collar of stones.

Found Bishop BT's:

A 14" D. Fir, now 18" snag about 35' tall bears N65°W, scribing visible.

A 24" x 6" pushed over stump found with visible scribing.

New BT's Established:

A 12" D. Fir bears N25°E 41.6' scribed "CN NE 1/64 BT"

A 12" D. Fir bears N55°W 36.3' scribed "CN NE 1/64 S27 BT"

Placed "BT" tags and "Land Survey Monument" signs on all BT's. Painted 5" red band and faces on all BT's.

Corner falls on flat ground, approximately 75' NE of water tank on private property. Forest Service property lines leading west and east are brushed, blazed, and posted w/USFS carsonite posts. Bearings are by compass w/ 21° East declination. Distances are to nail in side center of bearing tree.

Witnessed by: Georgene Wheatley, U.S.F.S., M. Garwood, K Roder, B. Bell, S. McAtee, S. Scherling, Stevenson High School

MARK THE CORNER LOCATION BELOW AND FILL IN THE CORNER CODE BLANK ON THE OTHER SIDE:
 For corners at the intersection of two lines, the corner code is the alphanumeric coordinate that corresponds to the appropriate intersection of lines.

For corners that are only on one line, the corner code is the line designation and the related line segment; i.e., a corner on line 5 between 'B' and 'C' is designated BC-5.

For corners that are between lines, the corner code is both line segments; i.e., a corner in the SE1/4 of the SE1/4 of section 18 is designated MN 4-5.

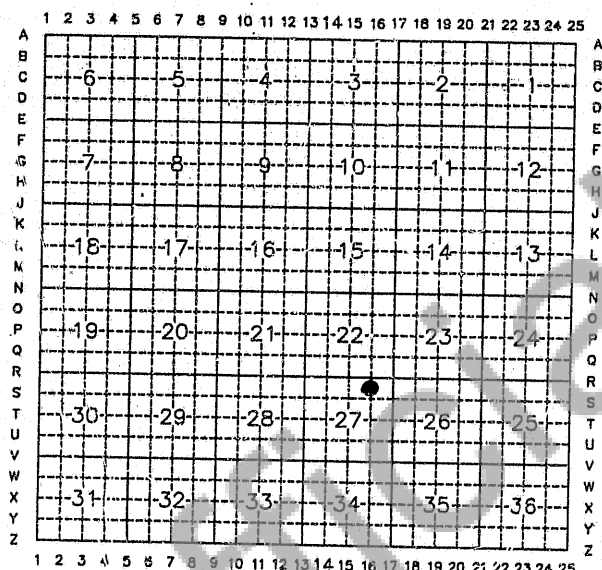

RCW 58.09.060 (2) requires the following information on this form: an accurate description and location, in reference to the corner position, of all monuments and accessories (a) found at the corner and (b) placed or replaced at the corner; (c) basis of bearings used to describe or locate such monuments or accessories; and (d) corollary information that may be helpful to relocate or identify the corner position.

PLACE FOR ADDITIONAL COMMENT:

SP

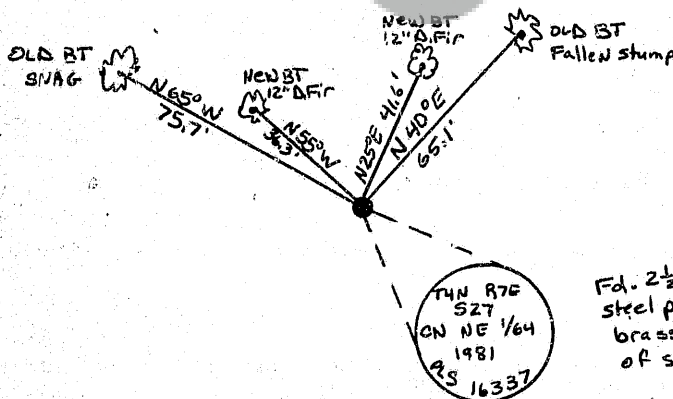

North
 210°
 250°

Fd. 2 1/2" x 30" galvanized
 steel pipe w/a 2 1/2"
 brass cap in a mound
 of stone.

T4N R7E
 S27
 CN NE 1/4
 1981
 9S 16337