

116537

BOOK 136 PAGE 128

**NOTICE OF CLASSIFICATION OF FOREST LAND  
OR  
APPROVAL OF DESIGNATED FOREST LAND**

Lona Keist  
 (Owner's name)  
 50 Cove Way  
 (Street address)  
 Brinnon, WA 98320  
 (City, State, Zip)

FILED FOR RECORD  
 AUDITOR'S RECORDING NO. 1000  
 BY SKA Co. Assessor  
 Jan 22 4 49 PM '93  
 P. Lowry  
 AUDITOR  
 GARY M. OLSON

(See definition of "forest land," "classified land" and "designated land" on back of form.)

You are hereby notified that the following land has been approved for ☐ classification under RCW 84.33.120, or

☒ designation under RCW 84.33.130 and 140:

31.99 acres in parcel number 02 05 33 0 0 1600 00

Registered  
 Indexed Dir  
 Indirect  
 Filled  
 Mailed

Upon removal from classification or designation as forest land, a compensating tax shall be imposed upon the land based on the following procedure:

True & Fair Value of Land at Time of Removal	LESS	Classified Forest Land Value at Time of Removal	MULTIPLIED BY	Last Levy Rate Extended Against Land	MULTIPLIED BY	Number of Years in Classification or Designation Not to Exceed 10
--	------	---	------------------	--	------------------	--

(The total tax due is equal to the compensating tax plus a recording fee.)

**NOTICE OF LANDOWNER NOT DESIRING FOREST LAND TO BE CLASSIFIED**

If it is not your desire to have such land assessed and valued as classified forest land, you must give the Assessor's Office written notice thereof on or before March 31, 19N/A within thirty (30) days of the date of this notice of June 22, 1993.

As owner(s) of the land described in this letter, I(we) hereby indicate by signature that I(we) do not desire to have this land classified as forest land by the Assessor. Owners application for Designated Forest

Owner(s) or Contract Purchaser(s) Signature(s) and Date: Land

(Signature)

(Date)

(Signature)

(Date)

(Signature)

(Date)

(Signature)

(Date)

Date of Notice June 22, 1993

Assessor

Glenda J. Kimmel  
 by Sharon DeBene  
 County Skamania



## APPLICATION FOR DESIGNATION OF FOREST LAND

BOOK 136 PAGE 129

The County Assessor must receive your application for forest land designation no later than December 31 for re-valuation the following year. "Forest Land" means all land in any contiguous ownership of 20 or more acres, which is primarily devoted to and used for growing and harvesting timber. Application must be made by the property owner. (RCW 84.33.130).

owner <u>Lava Forest</u>		FOR ASSESSOR'S USE ONLY	
address <u>50 Cole Highway</u>		Date Received: <u>1-29-93</u>	
city <u>BRINNON</u>	state <u>WA</u>	zip <u>98530</u>	Account # <u>02 05 33 00 1600 00</u>
telephone number ( )		19 <u>93</u> Assessment Year for 19 <u>94</u> Tax Collection	

Is all the land described by the Assessor's Account Number(s)? ☐ Yes ☒ No. If not, show if a area applied for using the sketch on back of this form.

31.00 ACRES attached map

Date land acquired 1/1/1 Has the land been subdivided or a plat filed? ☐ Yes ☒ No

Legal description of property R4 SE 1/4 NW 1/4

Sec 33 Twp 2N Rm 5E W.M.

Give a brief description of the timber on the land, or if harvested, your plan for restocking. See

MANAGEMENT PLAN

Give a summary of past, current, and continuing activity in growing and harvesting timber. See

attached

Do you have a forest management plan? If so, explain the nature and extent of implementation. ☒ Yes ☐ No

Is the land subject to a lease, option or other rights which permit it to be used for any purpose other than growing and harvesting timber? (Exclude coal and mineral rights.) If yes, explain. ☐ Yes ☒ No

Is the land used for grazing of domestic animals? If yes, list the kinds of animals and number of head. ☐ Yes ☒ No

Is all of the land subject to a (forest) fire patrol assessment? (RCW 78.04.380) If not, please explain. ☒ Yes ☐ No

\* Attach additional pages for explanation if needed.

FORM R/V 62 0021 (2-88)

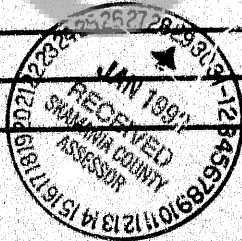

(CONTINUED ON BACK)



Yes

No

Are you and is your land in compliance with the restocking, forest management, fire protection, insect and disease control and forest debris laws? (Title 76 RCW.) If not, please explain.



## AFFIRMATION

AS OWNER(S) OF THE FOREGOING DESCRIBED LAND, I (WE) INDICATE BY SIGNATURE(S) BELOW THAT I (WE) ARE AWARE OF THE POTENTIAL TAX LIABILITY INVOLVED WHEN THE LAND CEASES TO BE DESIGNATED AS FOREST LAND. I (WE) ALSO DECLARE UNDER THE PENALTY OF PERJURY THAT THIS APPLICATION AND ANY ACCOMPANYING PAPERS HAVE BEEN EXAMINED BY ME (US) AND TO THE BEST OF MY (OUR) KNOWLEDGE ARE TRUE, CORRECT, AND COMPLETE STATEMENTS.

Date: 1/29/92Signature: Lona Hunt

SCALE 1" = 1000'

Sketch Location of Land Applied For:

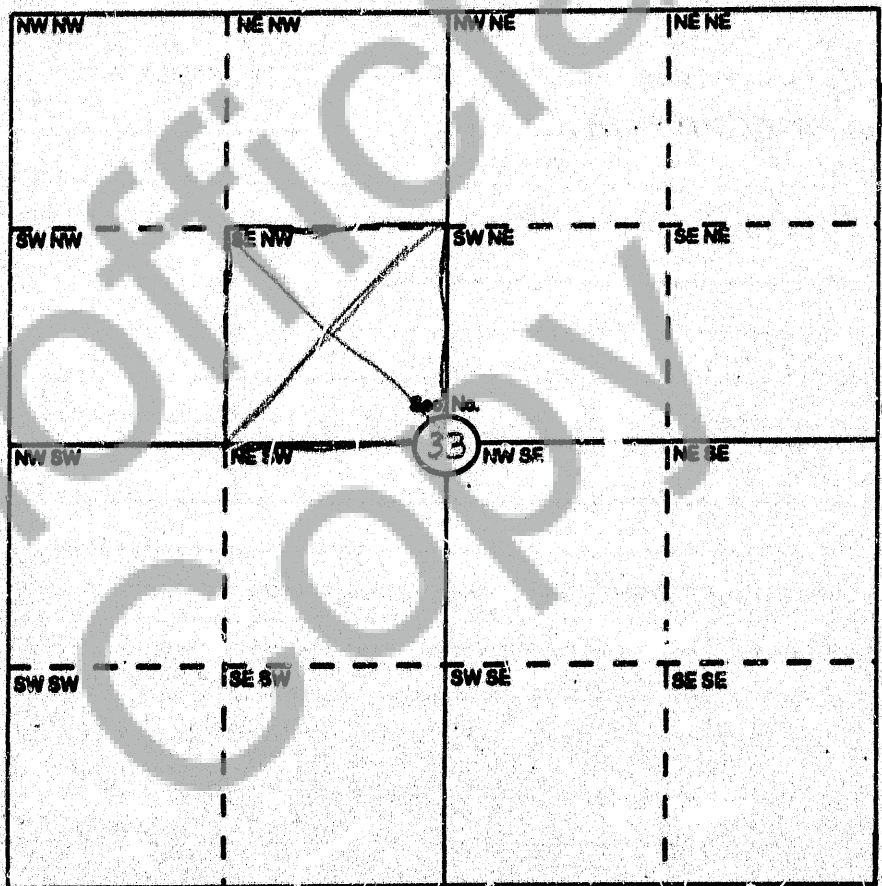
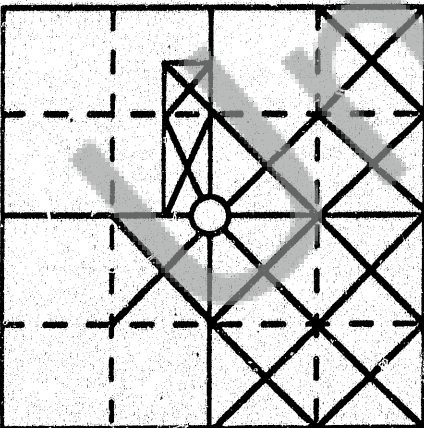
Section 33Township 2 NRange 5 ETotal Acres Applied For 31



FILED FOR RECORD

SKAMANIA CO. WASH.  
L1 Ska Co. Auditor's Record Number  
RECORD AFTER APPEAL PERIOD

JUN 25 9 29 AM '93

P. Lawry  
AUDITOR  
GARY M. OLSON

Registered

Indexed, Dir

Indirect

Filmed

Mailed

BOOK 136 PAGE 193

19 Assessment Year for 19 Tax Collection

## COUNTY ASSESSOR'S NOTICE OF REMOVAL OF

☐ CLASSIFIED FOREST LAND  
☒ DESIGNATED FOREST LAND

## AND STATEMENT OF COMPENSATING TAX

(RCW 84.33.120, 130, 140)

Daniel Lillegard &amp; Fay Olson, Co-Trustees

5155 Cecilia Street SE  
Salem, OR 97306

116565

You are hereby notified that the following property: 2 acres in parcel no. 03 07 36 2 0 0100 00

located in Lots 5 &amp; 6 covered by timberland lien recorded in Book G at

page 7

has been removed from forest ☐ classification ☒ designation as of 6/9/93 because the land no longer meets the definition and/or provisions of forest land as follows:

RCW 84.33.120(5) a) sale or transfer of all or a portion of such land to a

new owner . . . notice of continuance not signed by new owner . . . all

compensating taxes shall become due and payable . . . at

This removal shall be effective for the assessment year beginning January 1, 19 94.

You are hereby notified that a compensating tax has been assessed based upon the following:

True & Fair Value of Land at Time of Removal	LESS	Classified or Designated Value at Time of Removal	MULTIPLIED BY	Last Levy Rate Extended Against Land	MULTIPLIED BY	Years*	EQUALS	Compensating Tax
\$ 6,000	-	\$ 216	X	\$ 9.99266	X	10	=	\$ 578.00
RECORDING FEE							+	\$ 7.00
TOTAL TAX DUE							=	\$ 585.00

\* Number of years in classification or designation, not to exceed 10.

The compensating tax is due and payable to the County Treasurer 30 days from the date of this notice. The tax shall become a lien on the land and shall be subject to foreclosure in the same manner as provided in RCW 84.64.050.

You may apply for classification as either Open Space farm/Agricultural land or Open Space Timber Land under RCW 84.34. If the application is received within 30 days of this notice, no compensating tax would be due until the application is denied, or, if approved, the property is later removed from Open Space under RCW 84.34.108.

DATE OF NOTICE: 6-9-93DATE PAYMENT DUE: 7-9-93COUNTY ASSESSOR: Shandra J. Kernal  
by Shandra J. Kernal

FORM REV 62 0047 (3-89)