

118210

BOOK 146 PAGE 148

LAND CORNER RECORD

(THIS FORM PRESCRIBED BY THE PUBLIC LAND SURVEY OFFICE, DEPARTMENT OF NATURAL RESOURCES, PURSUANT TO RCW 58.09, ALPHA-NUMERIC INDEX DIAGRAM ON THE BACK.)

CORNER INDEXING INFORMATION:

TWP_ 3N RSE_ 5E CORNER CODE_ GH - 1-2
 (Willamette Meridian) (See instructions on back of U3)
 ADDITIONAL IDENTIFIER: (e.g., BLM designation for the corner, street intersection, plat name, block, lot, etc.)
 CLARK COUNTY GPS DESIGNATION : 18900 4109 ROAD
 GPS CONTROL SERIAL NUMBER : 0093
 POINT ALIAS : SILVER STAR

COUNTY: SKAMANIA

LAND SURVEYOR INFORMATION: (or Public Officer as per RCW 58.09.090)

This corner record correctly represents work performed by _____ under my direction in conformance with the Survey Recording Act.

COMPANY OR AGENCY: CLARK COUNTY SURVEYOR'S OFFICE

ADDRESS: 1300 ESTHER STREET
 SUITE 106
 VANCOUVER, WA 98660

WASHINGTON PLANE COORDINATES: N: E:

THIS POINT WAS OBSERVED IN THE 1992 CLARK COUNTY GLOBAL POSITIONING SYSTEM SURVEY. CONTACT THE COUNTY SURVEYOR'S OFFICE FOR POSITION INFORMATION.

ORDER: ZONE: DATUM (Date of adjustment):

AUDITOR'S USE

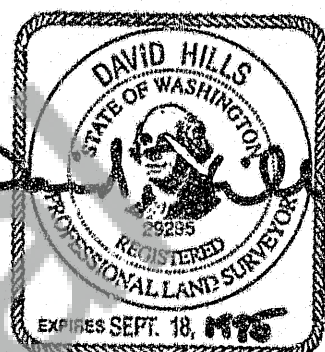

10/6/93

SEAL/SIGNATURE/DATE

CORNER INFORMATION: Use the space below to provide the following information regarding the corner: (1) Pertinent Corner History, (2) Evidence Found at the Corner, and (3) Corner Perpetuation Information. Please title and number the parts of your discussion accordingly. If additional space is needed use the back. (For (3), diagram the references. Also, provide the cross-reference to a map of record, if applicable, the surveyor's field book no./page no., and the date of work.) (See the back of this form for the requirements of the Survey Recording Act.)

NOTE: THIS DOCUMENT IS BEING RECORDED IN BOTH CLARK AND SKAMANIA COUNTIES. THE CLARK COUNTY VERSION IS INDEXED IN T3N R4E

THE POINT IS A 2-1/2 INCH DIAMETER BRASS DISK STAMPED "CLARK COUNTY CONTROL POINT 18900 1992" SET INTO BEDROCK ON A FLAT EXPOSED AREA ON SILVER STAR MOUNTAIN ABOUT 600 FEET SOUTHWESTERLY OF THE NORTHERLY TRAILHEAD AT THE END OF US FOREST SERVICE ROAD 4109.

THE STATION IS ABOUT 14 MILES EAST OF BATTLEGROUND IN SECTION 7 T3N R5E. TO REACH THE STATION FROM THE INTERSECTION OF YACOLT ROAD AND RAILROAD AVE IN THE TOWN OF YACOLT:

- * GO SOUTHEAST ON RAILROAD AVE 2.6 MILES TO SUNSET FALLS ROAD (COUNTY ROAD NO. 12),
- * LEFT (EAST) ON SUNSET FALLS ROAD 1.9 MILES TO DOLE VALLEY ROAD,
- * RIGHT (SOUTH AND EAST) ON DOLE VALLEY ROAD 2.5 MILES TO THE L-1100 ROAD,
- * LEFT (EAST) ON L-1100 2.0 MILES TO TARBELL CAMPGROUND (ROAD L-1210) CONTINUE EAST ON L-1100 2.1 MILES TO FORK IN THE ROAD, TAKE LEFT FORK 2.1 MILES TO US FOREST SERVICE ROAD 4109,
- * RIGHT (SOUTH) ON 4109 3.5 MILES TO TRAILHEAD PARKING AREA AT END OF ROAD,
- * WALK WEST AND SOUTH ON ABANDONED ROAD (SILVER STAR TRAIL) UPHILL ABOUT 600 FEET, LEAVE TRAIL RIGHT (WEST) AND WALK TO FLAT ROCKY AREA AND STATION POINT. THE STATION IS APPROXIMATELY 31 FEET EAST OF SMALL ROCK BLUFFS AND 550 FEET SOUTH OF A BARE GRASSY HUMP.

SEE REVERSE FOR SKETCH AND REFERENCE POINTS.

Registered
 Indexed, Dir
 Indirect
 Filmed
 Mailed

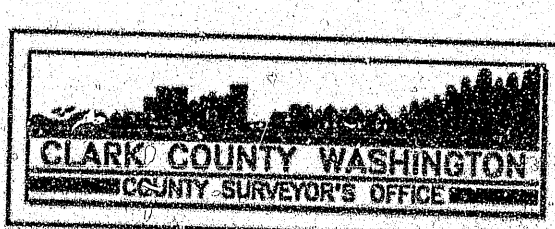

MARK THE CORNER LOCATION ON THE DIAGRAM BELOW AND FILL IN THE CORNER CODE BLANK ON THE OTHER SIDE.

(1) For corners located at the intersection of two lines (Section corners, quarter corners and sixteenth corners):

(a) The corner code is the alpha-numeric coordinate from the diagram below that corresponds to the appropriate intersection of lines.

(2) For corners that are not located at the intersection of two lines (Meander corners, DLC's, HES's, reservation boundaries, mining claims, etc.):

(a) For corners that are on one line only the corner code is the line designation and the related line segment; i.e., a corner on line 5 between "B" and "C" is designated BC-5.

(b) For corners that are between lines the corner code is both line segments; i.e., a corner in the SE1/4 of the SE1/4 of section 18 is designated MN-4-5.

BOOK 140 PAGE 149

	1	2	3	4	5	6	7	8	9	10	11	12	13	14	15	16	17	18	19	20	21	22	23	24	25
A																									
B																									
C		6				5				4					3				2					1	
D																									
E																									
F																									
G		7				8				9					10				11					12	
H																									
I																									
J																									
K																									
L		18				17				16					15				14					13	
M																									
N																									
O																									
P		19				20				21					22				23					24	
Q																									
R																									
S																									
T		30				29				28					27				26					25	
U																									
V																									
W																									
X		31				32				33					34				35					36	
Y																									
Z																									

RCW 58.09.060 (2) requires the following information on this form: an accurate description and location, in reference to the corner position, of all monuments and accessories (a) found at the corner and (b) placed or replaced at the corner; (c) list of bearings used to describe or locate such monuments or accessories; and (d) corollary information that may be helpful to relocate or identify the corner position.

SPACE FOR ADDITIONAL COMMENT:

GPS CONTROL #93

ADDRESS 18900

SET 2 1/2" DIA DOMED BRASS CAP IN BED
ROCK (SEE CAP DETAIL AT RT) TAKE USFS
ROAD #409 TO PARKING AREA (END OF
ROAD) PROCEED UP SILVER STAR TRAIL
#180 APPROX 600 FT THEN PROCEED WESTERLY
TO A FLAT ROCKY AREA WITH SMALL ROCK
BLUES TO THE WEST. POINT IS APPROX 312
FT E OF CLIFF EDGE AND 250 FT W
OF TRAIL. POINT IS 550 FT S. ALONG
TOP OF RIDGE FROM ROCK & GRASS BRUSH
COVERED HUMP

SET FOLLOWING RP'S: RP'S #1, #2, #3, #4 ARE
2" DIA DOMED BRASS CAP (SEE DETAIL AT
LOWER RT) WITH NUMBER SET IN BED ROCK

RP#1 BEARS N4°E 38 1/2 FT
RP#2 BEARS S89°E 52 3/4 FT
RP#3 BEARS S13°W 53 1/2 FT
RP#4 BEARS N72°W 15 1/2 FT

CLARK
COLD & VERY WINDY 15 OCT 92

COMPILED (HAND) CREW: GLENN
100 FT STEEL WIRE LEWIS
ELIE

