

118207
LAND CORNER RECORD

BOOK 740 PAGE 142

FILED FOR RECORD
 SKAMANIA CO. WASH
 BY David Hills
Clark Co. Surveyor
 Dec 10 4 26 PM '93

P. Olsson
 AUDITOR
 GARY M. OLSON

(THIS FORM PRESCRIBED BY THE PUBLIC LAND SURVEY OFFICE, DEPARTMENT OF NATURAL RESOURCES, PURSUANT TO RCW 58.09. ALPHA-NUMERIC INDEX DIAGRAM ON THE BACK.)

CORNER INDEXING INFORMATION:

TWP 2N RGE 5E CORNER CODE AB-1-2
(Willamette Meridian) (See instructions on back of LCR)

ADDITIONAL IDENTIFIER: (e.g., BLM designation for the corner, street intersection, plat name, block, lot, etc.)

CLARK COUNTY GPS DESIGNATION : 41310 NE 98 STREET
 GPS CONTROL SERIAL NUMBER : 0063
 POINT ALIAS : SKAMANIA MINES

COUNTY: CLARK/ SKAMANIA

LAND SURVEYOR INFORMATION: (or Public Officer as per RCW 58.08.090)

AUDITOR'S USE

This corner record correctly represents work performed by me or under my direction in conformance with the Survey Recording Act.

COMPANY OR AGENCY: CLARK COUNTY SURVEYOR'S OFFICE

ADDRESS: 1300 ESTHER STREET
SUITE 106
VANCOUVER, WA 98660

WASHINGTON PLANE COORDINATES: N: _____ E: _____

THIS POINT WAS OBSERVED BY THE 1992 CLARK COUNTY GLOBAL POSITIONING SYSTEM SURVEY. CONTACT THE COUNTY SURVEYOR'S OFFICE FOR POSITION INFORMATION.

ORDER: _____ ZONE: _____ DA: 1/6/93 (Date of adjustment): _____



SEAL/SIGNATURE/DATE

CORNER INFORMATION: Use the space below to provide the following information regarding the corner: (1) Pertinent Corner History, (2) Evidence Found at the Corner, and (3) Corner Perpetuation Information. Please title and number the parts of your discussion accordingly. If additional space is needed use the back. (For (3), diagram the references. Also, provide the cross-reference to a map of record, if applicable, the surveyor's field book no./page no., and the date of work.) (See the back of this form for the requirements of the Survey Recording Act.)

THE POINT IS A 2-1/2 IN DIAMETER BRASS DISK STAMPED "CLARK COUNTY CONTROL POINT 41310 1992" IN CONCRETE MONUMENT WITH MONUMENT BOX AND LID 15 FEET NE FROM THE END OF A GRAVEL LOGGING ROAD AND ON THE NW EDGE OF A GRAVEL JEEP TRAIL LEADING FROM A LOG LANDING IN A CLEARCUT. IT IS SE ABOUT 700 FEET FROM THE NE CORNER OF SECTION 1 T2N R4E NEAR THE CLARK-SKAMANIA COUNTY LINE.

THE POINT IS ABOUT 9 MILES NORTHEAST OF THE CITY OF WASHOUGAL. TO REACH THE POINT FROM THE INTERSECTION OF STATE ROUTE 14 AND 6TH STREET EXIT IN WASHOUGAL:

- GO NORTH ON 6TH STREET 0.5 MILES TO SE 3RD STREET,
- * WEST ON SE 3RD STREET 0.5 MILES TO THE INTERSECTION WITH SE SHEPHERD ROAD, * RIGHT (EAST) 1.0 MILES TO WASHOUGAL RIVER ROAD,
- * LEFT (NORTH) 6.5 MILES TO HUGHES ROAD
- * LEFT (NORTHEAST) ON HUGHES RD, NE 392 AVE, NE 28 ST, AND NE MILLER ROAD 2.8 MILES TO NE 39 ST.
- * RIGHT (EAST) ON 39 ST 0.1 MILES TO NE 412 AVE,
- * LEFT (NORTH) ON 412 AVE 0.75 MILES TO BRIDGE AND END OF PAVEMENT, CONTINUE ON ROAD 1200 (GRAVEL) 1.6 MILES TO FORK, TAKE LEFT FORK (ROAD 1200 WHERE SIGN SAYS 22 MILES TO YACOLT)
- * GO 1.2 MILES TO LOGGING ROAD ON LEFT (ROAD 1200 ENTERS THE TIMBER HERE FROM A CLEARCUT).
- * GO LEFT (SOUTHEAST) ON LOGGING ROAD 230 FEET TO FORK, TAKE RIGHT FORK GO 230 FEET TO THE POINT.

THERE ARE STEEL FENCE POSTS LOCATED BY REFERENCE POINTS AND MONUMENT. NOTE - FOREST ROAD NUMBERS ARE AS CALLED OUT ON WASHINGTON DEPARTMENT OF NATURAL RESOURCES MAP OF THE YACOLT BURN STATE FOREST.

SEE REVERSE FOR SKETCH AND REFERENCE POINTS.

NOTE: THIS DOCUMENT IS BEING RECORDED IN BOTH CLARK AND SKAMANIA COUNTIES. THE CLARK COUNTY VERSION IS INDEXED IN T2N R4E.

Registered
 Indexed, Dir
 Indirect
 Filed
 Mailed

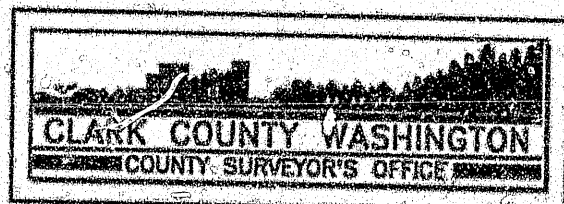

MARK THE CORNER LOCATION ON THE DIAGRAM BELOW AND FILL IN THE CORNER CODE BLANKS IN THE OTHER SIDE:
 (1) For corners located at the intersection of two lines (section corners, quarter corners and sixteenth corners):

(a) The corner code is the alpha-numeric coordinate from the diagram below that corresponds to the appropriate intersection of lines.

(2) For corners that are not located at the intersection of two lines (Meander corners, DLC's, NES's, reservation boundaries, mining claims, etc.):

(a) For corners that are on one line only the corner code is the line designation and the related line segment; i.e., a corner on line 5 between "8" and "9" is designated BC-5.

(b) For corners that are between lines the corner code is both line segments; i.e., a corner in the SE1/4 of the SE1/4 of section 18 is designated MN-4-5.

BOOK 140 PAGE 143

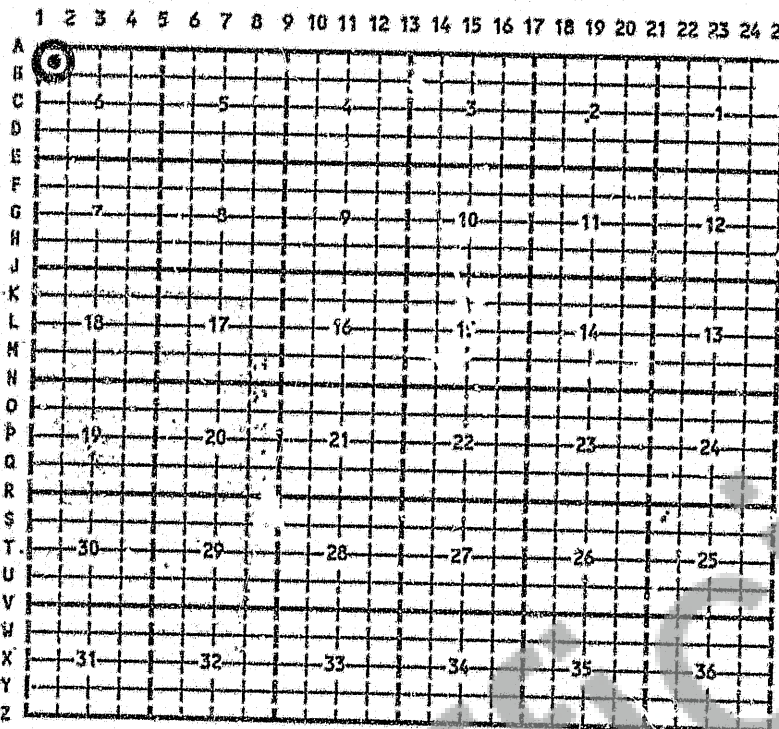

RCV 57.09.060 (2) requires the following information on this form an accurate description and location, in reference to the corner position, of all monuments and accessories (a) found at the corner and (b) placed or replaced at the corner; (c) basis of bearings used to describe or locate such monuments or accessories; and (d) corollary information that may be helpful to relocate or identify the corner position.

SPACE FOR ADDITIONAL COMMENT:

MONUMENT RECOVERY AND RESTORATION PROGRAM BOOK 2 1992

18

GPS CONTROL #163

Address #4310 E 9830N

SET CONCRETE MON W/ 2 1/2" DIA DOME BRASS CAP (SEE CAP DETAIL AT RT.) W/ MON BOX AND LID LOCATED AT THE NW END OF A LOG LANDING ROAD AT END OF GRAVEL IN A CLE

SET FOLLOWING RPS: RPS #1 #2 #3 #4 ARE 5/8" DIA X 30" REBAR W/ RED PLASTIC CLARK COUNTY CONTROL CAP

RP#1 BEARS N 0° 35' 31" E 35 3/4 FT LOCATED 3 5/8 FT S. OF STUMP

RP#2 BEARS N 48° E 37 28 FT LOCATED 11 FT E. FROM 3 STUMPS THE LARGEST OF WHICH IS 34"

RP#3 BEARS S 41° E 43 65 FT LOCATED 46 FT NW OF A STUMP

RP#4 BEARS S 77° W 30 37 FT LOCATED 46 FT NE OF A STUMP

22 OCT 92

