



112225

BOOK 7/5 PAGE 81

## LAND CORNER RECORD

HAMPSTUR CORPORATION  
1010 Douglas A3  
LONGVIEW, WASHINGTON 98632

T. 7 N.R. 5 E., W.M. SKAMANTA County  
 Segregated Surveys: Corner Code No. Z-13  
 Name: SW Section Corner--Section 34 Corner No.:  
 DLC, HES, Tract, Mining Claim, Indian Allotment, Federal Reserve, Townsite.

## 1. History of Corner Establishment and Subsequent Restoration:

This corner was originally set by the GLO in 1900, by Lewis Shelton, at which time he set a post and scribed 4 BT's. It was then located and used by Frank Rhodes during his GLO survey of the line leading to the South in 1909. The corner was then remonumented from original evidence in 1968 by the DNR, as indicated in the diagram below. The corner was then found and maintained by HAMPSTUR CORP. in 1989 and again in August of 1991, while performing a survey of the West line of Section 3, for PLUM CREEK TIMBER COMPANY, under the direction of C. Hampton, PLS #18,087.

## 2. Description of Evidence Found:

GLO corner: Hemlock post (1900): not found

GLO BT's (1900):

- 10" Hemlock, N74°E--29 lks.; gone (falls in old road grade).
- 20" Hemlock, S28°E--48 lks.; fd. a 30" Hem. stump, 3 ft. high at rec. position.
- 20" Cedar, S08°W--54 lks.; gone (falls in old road grade).
- 20" Cedar, N55°W--26 lks.; fd. a 36" stump w/old axe work.

## SUBSEQUENT RESTORATIONS:

Found the DNR concrete mon. and 2 references, as shown in the diagram below.

## 3. Describe Monument, Accessories and Corollary Data to Perpetuate this Corner Location. Diagram corner and indicate meridian and reference to map of record. Surveyor's Field Book No.

PS-127 Page No. 3-4 Date of work 4-28-89  
 (verified 8-16-91)

## LOCATION:

-on a steep East slope, just above the cut bank of old road grade, which bears N10°W and S25°E.

-approx. 550 ft. South of "10 road", at creek crossing; (fd. a 6"x6" DNR post on South side of road with tag which reads "South--554 S.D.")

-near SW. corner of 2nd growth timber and on edge of Old Growth timber.

Note: A Plum Creek location tag was added to each RP as well as the steel fence post. A R-R spike was driven into the side center of each RP.

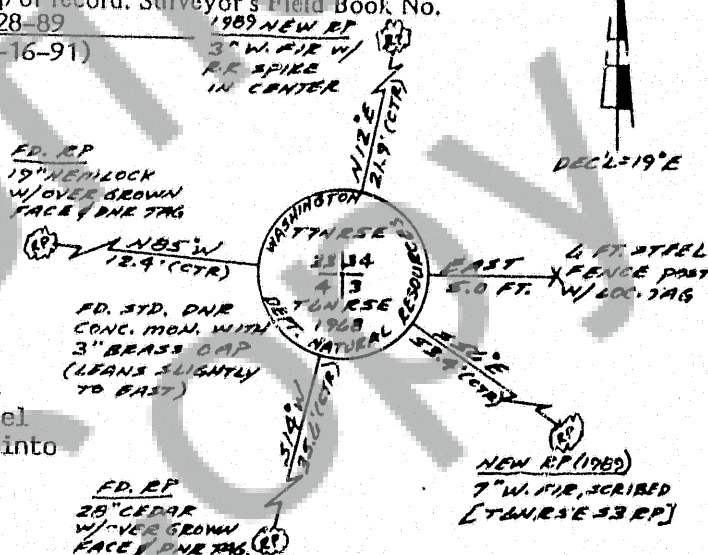

Washington Plane Coordinates: \_\_\_\_\_ Zone, Y \_\_\_\_\_ X \_\_\_\_\_  
 Order Accuracy. Derived From: \_\_\_\_\_

Pin Pointed on Photo No. \_\_\_\_\_ Date \_\_\_\_\_ Located at \_\_\_\_\_

## SURVEYOR'S CERTIFICATE

This corner record correctly represents work performed by me or under my direction in compliance with the provisions of Chapter 50, Laws of 1973. Date August 16, 1991

Signature Calvin J. Hampton, PLS

LS #18,087

Certificate No



## AUDITOR'S CERTIFICATE

Filed for record this 4th day of October 19 91 at 4:26 P. M. in Book 7/5 of Monuments at page 81 at the request of Hampstur Corp.

Gary M. Olson by P. Lowry  
 County Auditor

Registered P  
 Indexed P  
 Indirect P  
 Filed 10/16/91  
 Mailed

Form prescribed by Bureau of Surveys and Maps pursuant to the provisions of Section 5 (2), Chapter 50, Laws of 1973.

FILED FOR RECORD  
 SKAMANTA CO. WASH  
 BY Hampstur Corp.

OCT 4 4 26 PM '91

P. Lowry  
 AUDITOR  
 GARY M. OLSON