



112222

BOOK 6/5 PAGE 39

LAND CORNER RECORD

HAMPSTUR CORPORATION
1010 Douglas A3
LONGVIEW, WASHINGTON 98632

T. 6 N. R. 5 E. , W.M. SKAMANIA County
Segregated Surveys: Corner Code No. A-13
Name: NW Section Corner— Section 3 Corner No.: _____
DLC, HES, Tract, Mining Claim, Indian Allotment, Federal Reserve, Townsite.

1. History of Corner Establishment and Subsequent Restoration:

This corner was originally set by the GLO in 1900, by Lewis Shelton, at which time he set a post and scribed 4 BT's. It was then located and used by Frank Rhodes during his GLO survey of the line leading to the South in 1909. The corner was then remonumented from original evidence in 1968 by the DNR, as indicated in the diagram below. The corner was then found and maintained by HAMPSTUR CORP. in 1989 and again in August of 1991, while performing a survey of the West line of Section 3, for PLUM CREEK TIMBER COMPANY, under the direction of C. Hampton, PLS #18,087.

2. Description of Evidence Found:

GLO corner: Hemlock post (1900): not found

GLO BT's (1900):

- 10" Hemlock, N74°E--29 lks.; gone (falls in old road grade).
- 20" Hemlock, S28°E--48 lks.; fd. a 30" Hem. stump, 3 ft. high at rec. position.
- 20" Cedar, S08°W--54 lks.; gone (falls in old road grade).
- 20" Cedar, N55°W--26 lks.; fd. a 36" stump w/old axe work.

SUBSEQUENT RESTORATIONS:

Found the DNR concrete mon. and 2 references, as shown in the diagram below.

3. Describe Monument, Accessories and Corollary Data to Perpetuate this Corner Location. Diagram corner and indicate meridian and reference to map of record. Surveyor's Field Book No.

PS-127 Page No. 3-4 Date of work 4-28-89
(verified 8-16-91)

LOCATION:

-on a steep East slope, just above the cut bank of old road grade, which bears N10°W and S25°E.

-approx. 550 ft. South of "10 road", at creek crossing; (fd. a 6"x6" DNR post on South side of road with tag which reads "South--554 S.D.")

-near SW. corner of 2nd growth timber and on edge of Old Growth timber.

Note: A Plum Creek location tag was added to each RP as well as the steel fence post. A R-R spike was driven into the side center of each RP.

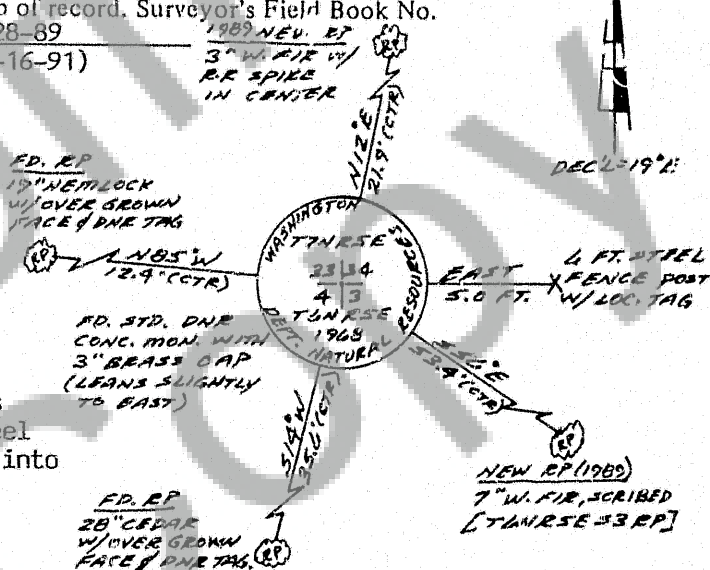

Washington Plane Coordinates: _____ Zone, Y _____ X _____
Order Accuracy. Derived From: _____

Pin Pointed on Photo No. _____ Date _____ Located at _____

SURVEYOR'S CERTIFICATE

This corner record correctly represents work performed by me or under my direction in compliance with the provisions of Chapter 50, Laws of 1973. Date August 16, 1991

Signature Calvin J. Hampton, PLS LS #18,087
Certificate No _____



AUDITOR'S CERTIFICATE

Filed for record this 4th day of October 1991 at 4:09 P. M. In
Book 6/5 of Monuments at page 39 at the request of Hampstur Corp

Gary M. Olson by P. Lowry
County Auditor

Form prescribed by Bureau of Surveys and Maps pursuant to the provisions of Section 5 (2).
Chapter 50, Laws of 1973.

Registered P
Indexed P
Indirect P
Filed 10/16/91
Mailed _____

FILED FOR RECORD
SKAMANIA CO WASH
BY Hampstur Corp

OCT 4 4 09 PM '91
GARY M. OLSON
COUNTY CLERK