

107750

BOOK 6/6 PAGE 58

LAND CORNER RECORD

HAMPSTUR CORPORATION
1010 Douglas A3
LONGVIEW, WASHINGTON 98632

T 6 N.R. 6 E. W.M. SKAMANIA County
Segregated Surveys: Corner Code No. J-5
Name: SE. corner of Section 7 Corner No.:
DLC, HES, Tract, Mining Claim, Indian Allotment, Federal Reserve, Townsite.

1. History of Corner Establishment and Subsequent Restoration:

In 1921, this corner was originally established by Chester Pecore, while working under GLO contract, group #19. A 2"x36" iron pipe with brass cap was set at that time. Then in 1984, B.L. Jones, LS #18,734, found the original monument and added additional references as indicated in the diagram below. Then on August 17, 1988, R. Bogdon (from HAMPSTUR CORP.), again found the above corner and added additional RP's and a reference post as indicated in the diagram below, while working on a "corner restoration" project for PLUM CREEK TIMBER COMPANY, under the direction of C. Hampton, LS #18,087.

2. Description of Evidence Found:

ORIGINAL 1921 GLO MONUMENT: found the 1"x36" iron pipe and brass cap, as originally set as mentioned above and shown in the diagram below.

ORIGINAL BT's:

- 8" Hemlock, N130E--27 lks.; gone--found depression in ground.
- 6" Hemlock, S530E--6 lks.; gone--found decayed wood at record location.
- 16" Fir, S110W--42 lks.; fd. 27" live tree with over grown face, see diagram below.
- 6" Hemlock, N380W--25 lks.; gone--no sign of any evidence.

SUBSEQUENT RESTORATION:

Found the 2 reference monuments along with RP's as indicated by Jones' LCR files in BOOK 6/6 at PAGE 22.

3. Describe Monument, Accessories and Corollary Data to Perpetuate this Corner Location. Diagram corner and indicate meridian and reference to map of record. Surveyor's Field Book No. 1284 RM PS-056 Page No. 33-34 Date of work 8-17-88

LOCATION:

- on a 65% East slope.
- on an existing E-W cutting line which has been posted with USFS posts and signs, (clearcut to North and mature conifers to the South).
- approx. 150 ft. West of a draw, which bears Southeast.
- approx. 200 ft. East of the top of an ascent.
- S300W--approx. 250 ft. from the end of a logging road landing.

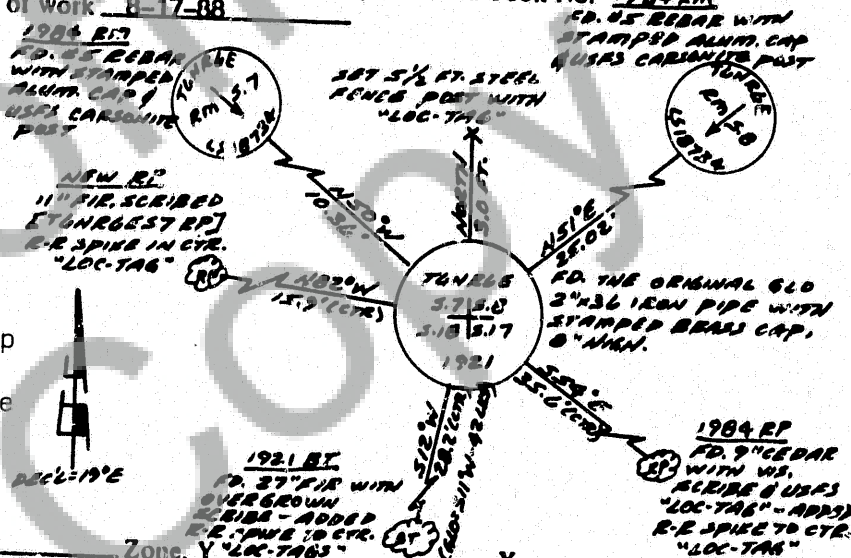

Washington Plane Coordinates: Zone, Y X
Order Accuracy. Derived From:

Pin Pointed on Photo No. Date Located at

SURVEYOR'S CERTIFICATE

This corner record correctly represents work performed by me or under my direction in compliance with the provisions of Chapter 50, Laws of 1973, Date August 28, 1989

Signature Calvin J. Hampton, PLS LS #18,087
Certificate No.



AUDITOR'S CERTIFICATE

FILED FOR RECORD
SKAMANIA CO. WASH
BY Hampstur Corp.
AUG 30 12 30 PM '89
GARY N. OLSON
Auditor
Filed for record this day of 19 at M. In
of at page at the request of

County Auditor

Form prescribed by Bureau of Surveys and Maps pursuant to the provisions of Section 5 (2), Chapter 50, Laws of 1973.

Registered P
Indexed, -ir P
Indirect P
Filed 9-1-89
Mailed