

107746

BOOK 6/6 PAGE 54

LAND CORNER RECORD

HAMPSTUR CORPORATION
1010 Douglas A3
LONGVIEW, WASHINGTON 98632

T 6 N R 6 E. W.M.

SKAMANIA

County

Segregated Surveys:

Corner Code No. E-13

Name:

SE. corner of Section 4

Corner No.:

DLC, HES, Tract, Mining Claim, Indian Allotment, Federal Reserve, Townsite.

1. History of Corner Establishment and Subsequent Restoration:

This corner was originally established by Chester Pecore during his 1921 GLO contract, under group #19. Since that time the corner has been used by various surveyors for different projects. Then on August 22, 1988, R. Bogdon (from HAMPSTUR CORP.) located the corner and re-referenced it as shown in the diagram below, while performing a "corner restoration" project for PLUM CREEK TIMBER COMPANY, under the direction of C. Hampton, PLS #18,087. See the diagram below.

2. Description of Evidence Found:

ORIGINAL GLO MONUMENT: Fd. the 2"x36" iron pipe with original brass cap, as set in 1921 under GLO contract, as mentioned above and shown in the diagram below.

ORIGINAL BT'S, (scribed in 1921):

- 24" Fir, N27 $\frac{1}{2}$ °E--27 lks.; fd. a burned-out shell at record location.
- 8" W. Pine, S48 $\frac{1}{2}$ °E--42 lks.; fd. only a burned/decayed root crown at rec. location
- 20" Fir, S76°W--19 lks.; fd. 32" Fir stump, 3 ft. high in fair condition, see diagram below.
- 18" Pine, N27°W--26 lks.; fd. a badly decayed stub only 1 ft. high, at rec. location.

3. Describe Monument, Accessories and Corollary Data to Perpetuate this Corner Location. Diagram corner and indicate meridian and reference to map of record. Surveyor's Field Book No.

PS-056 Page No. 43-44 Date of work 8-22-88

LOCATION:

- on a 20% West slope.
- 100 ft. South of a gentle draw, which bears to the Northwest.
- S87°E--approx. 350 ft. from a "Y" in logging road.
- N40°E--approx. 100 ft. from a rock pit on logging road.
- set a 4"x4" treated post with location tag on East side of logging road, West--318 ft.

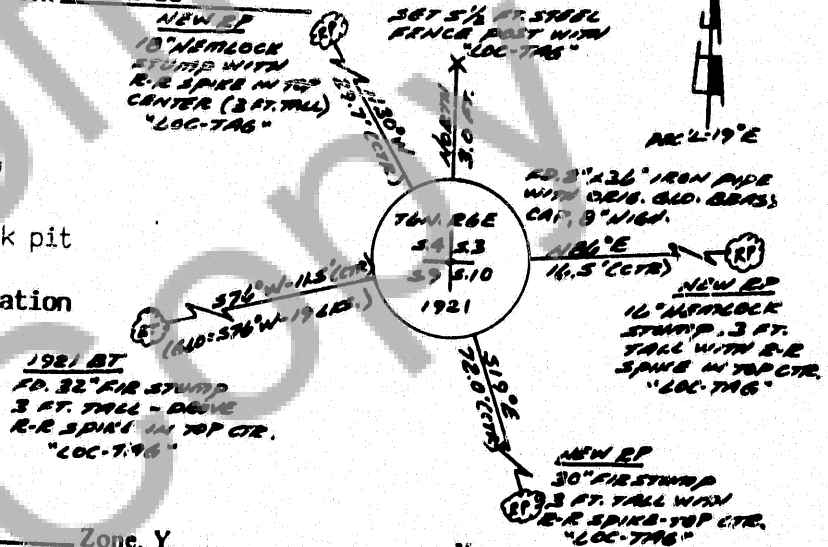

Washington Plane Coordinates: _____ Zone, Y _____

Order Accuracy. Derived From: _____ X _____

Pin Pointed on Photo No. _____

Date _____

Located at _____

SURVEYOR'S CERTIFICATE

This corner record correctly represents work performed by me or under my direction in compliance with the provisions of Chapter 50, Laws of 1973. Date August 28, 1989

Signature

Calvin J. Hampton, PLS

LS #18,087

Certificate No



AUDITOR'S CERTIFICATE

Filed for record this _____ day of _____ 19 _____ at _____ M. In _____ of _____ at page _____ at the request of _____

County Auditor

Form prescribed by Bureau of Surveys and Maps pursuant to the provisions of Section 5 (2), Chapter 50, Laws of 1973.

Registered

Indexed, Jir

Indirect

Filed 9-14-89

Mailed