

107745

BOOK 6/6 PAGE 53

LAND CORNER RECORD

HAMPSTUR CORPORATION
1010 Douglas A3
LONGVIEW, WASHINGTON 98632

T 6 N, R 6 E., W.M. SKAMANIA County
Segregated Surveys: Corner Code No. E-11
Name: S. 1/4 corner of Sec. 4 Corner No.:
DLC, HES, Tract, Mining Claim, Indian Allotment, Federal Reserve, Townsite.

1. History of Corner Establishment and Subsequent Restoration:

This corner was originally established in 1921, by Chester Pecore under GLO contract, group #19. The corner was found and used during a 1977 survey by Hagedorn, Inc. under the direction of W. Hagedorn LS #9579. (The corner was referenced at that time.) Then on August 22, 1988, R. Bogdon (from HAMPSTUR CORP.), located the corner and re-referenced the same during a "corner restoration" project for PLUM CREEK TIMBER CO. under the direction of C. Hampton, PLS #18,087. Refer to the diagram below.

2. Description of Evidence Found:

ORIGINAL GLO MONUMENT: fd. the 1"x36" iron pipe with stamped brass cap, as originally set in 1921 by the GLO.

ORIGINAL BT's, (scribed in 1921):

- 16" Fir, N52°W--12 lks.; fd. an 18" Fir stump, 4 ft. high, with chopped out face, see the diagram below.
- 8" Fir, S01°E--17 lks.; gone--probably uprooted and went down the hill.

SUBSEQUENT RESTORATIONS:

- found Hagedorn's 1977 RP to the NE. uprooted and on the ground, see diagram below.

3. Describe Monument, Accessories and Corollary Data to Perpetuate this Corner Location. Diagram corner and indicate meridian and reference to map of record. Surveyor's Field Book No. PS-056 Page No. 41 Date of work 8-22-88**LOCATION:**

- on a 100% NE. slope.
- 50 ft. East of a NW spur ridge.
- 150 ft. South of a steep NW draw.
- a culvert under a spur road, bears N49°E--approx. 300 ft.
- set a 4"x4"x8' treated post with location tag, South--50.0 ft.; located on the North edge of spur road.

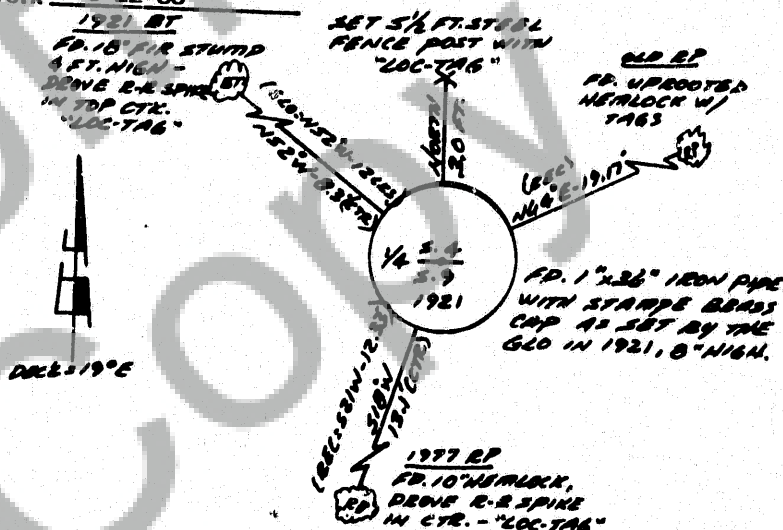

Washington Plane Coordinates: Zone, Y X
Order Accuracy. Derived From:
Pin Pointed on Photo No. Date Located at

SURVEYOR'S CERTIFICATE

This corner record correctly represents work performed by me or under my direction in compliance with the provisions of Chapter 50, Laws of 1973. Date August 28, 1989

Signature Calvin J. Hampton, PLS LS #18,087
Certificate No.



AUDITOR'S CERTIFICATE

Filed for record this day of 19 at M. In
Book of at page at the request of

County Auditor

Form prescribed by Bureau of Surveys and Maps pursuant to the provisions of Section 5 (2), Chapter 50, Laws of 1973.

Registered
Indexed,
Indirect
Filed 9-1-89
Mailed