



107744

BOOK 6/6 PAGE 52

LAND CORNER RECORD

HAMPSTUR CORPORATION
1010 Douglas A3
LONGVIEW, WASHINGTON 98632

T 6 N, R 6 E., W.M. SKAMANIA County
Segregated Surveys: Corner Code No. C-21
Name: 1/4 S.2/S.1 Corner No.: _____
DLC, HES, Tract, Mining Claim, Indian Allotment, Federal Reserve, Townsite.

1. History of Corner Establishment and Subsequent Restoration:

In 1921, Chester Pecore originally set a 1"x36" iron pipe with brass cap for the corner, under GLO contract, group #19. Then in 1966, the BLM noted finding the original monument and remains of both BT's. In 1976, C. Whitten, LS #12,412 found the monument missing and noted it was probably destroyed by fire trail construction. He remonumented the corner with the monument shown below and added 1 RP, as shown on his LCR filed in BOOK 6/6, at PAGE 1. On August 31, 1988, R. Bogdon (from HAMPSTUR CORP.), found the above mon. and remains of both BT's. A reference post was added and the corner was refreshed at that time, while working under the direction of C. Hampton, PLS #18,087.

2. Description of Evidence Found:

1921 ORIGINAL GLO MONUMENT: found no trace of the original iron pipe and brass cap.
ORIGINAL BT's (1921):

-20" Fir, S55 $\frac{1}{2}$ °E--23 lks.; fd. a 27" stump, one ft. tall at S50°E--15.3 ft., as shown in the diagram below.

-14" Fir, N39°W--9 lks.; fd. 15" Fir stump with vis. face, 6 ft. high, at N09°W--28.1 ft., as shown in the diagram below.

SUBSEQUENT RESTORATION:

Found the 2" galv. iron pipe and brass cap as set by Whitten in 1976 along with 1 RP., as mentioned above and shown in the diagram below.

3. Describe Monument, Accessories and Corollary Data to Perpetuate this Corner Location. Diagram corner and indicate meridian and reference to map of record. Surveyor's Field Book No. PS-056 Page No. 47 Date of work 8-31-88

LOCATION:

- in a North-South cutting line, with approx. 10 yr. old reprod. to the West.
- in an old fire trail that runs N-S.
- 215 ft. North of main logging road, which bears S72°E--N85°W.
- set a 4"x4"x8" treated post with location tag on the North edge of the above road; tag reads "North--200 ft."

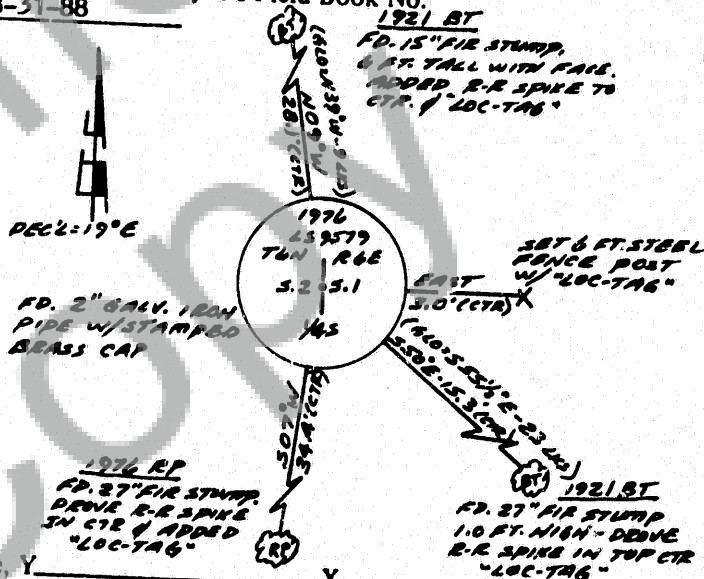

Washington Plane Coordinates: _____ Zone, Y _____ X _____
Order Accuracy. Derived From: _____

Pin Pointed on Photo No. _____ Date _____ Located at _____

SURVEYOR'S CERTIFICATE

This corner record correctly represents work performed by me or under my direction in compliance with the provisions of Chapter 50, Laws of 1973. Date August 28, 1989

Signature Calvin J. Hampton, PLS LS #18,087
Certificate No



AUDITOR'S CERTIFICATE

Filed for record this _____ day of _____ 19 _____ at _____ M. In _____
Book _____ of _____ at page _____ at the request of _____

County Auditor

Form prescribed by Bureau of Surveys and Maps pursuant to the provisions of Section 5 (2), Chapter 50, Laws of 1973.

Registered _____
Indexed, -ir _____
Indirect _____
Filed 9-1-89
Mailed _____