



107742

BOOK 6/6 PAGE 50

LAND CORNER RECORD

HAMPSTUR CORPORATION
1010 Douglas A3
LONGVIEW, WASHINGTON 98632

T. 6 N.R. 6 E. , W.M. SKAMANIA County
Segregated Surveys: Corner Code No. C-9
Name: 1/4 S.5/S.4 Corner No.: _____
DLC, HES, Tract, Mining Claim, Indian Allotment, Federal Reserve, Townsite.

1. History of Corner Establishment and Subsequent Restoration:

In 1921, Chester Pecore set a 1"x36" iron pipe with a brass cap for the original corner while working under GLO contract, group #19. Then in 1977, HAGEDORN, Inc. found the corner and added additional references, as indicated on their survey map recorded in BOOK 1 of SURVEYS at PAGE 142. Then on August 19, 1988, R. Bogdon (from HAMPSTUR CORP.), found the corner as referenced above and added scribe to 2 of the RP's and set a steel reference post, as shown in the diagram below, while working on a "corner restoration" project for PLUM CREEK TIMBER COMPANY, under the direction of C. Hampton, PLS #18,087.

2. Description of Evidence Found:

ORIGINAL GLO MONUMENT: found the 1"x36" iron pipe with brass cap, as originally established under GLO contract in 1921, as mentioned above and shown in the diagram below.

ORIGINAL GLO BT's:

- 10" Fir, S80°E--21 lks.; fd. a 2 ft. tall badly decayed stub at record location.
- 12" Fir, S35°W--20 lks.; fd. a 14" snag, 20 ft. high, with over grown face, at record location.

SUBSEQUENT RESTORATION:

Found the 3 RP's as noted by HAGEDORN, Inc. in 1977. (2 of the found RP's were scribed at this time, as shown in the diagram below.

3. Describe Monument, Accessories and Corollary Data to Perpetuate this Corner Location. Diagram corner and indicate meridian and reference to map of record. Surveyor's Field Book No.

PS-056 Page No. 30 Date of work 8-19-88

LOCATION:

- on a large flat area, approx. 450 ft. East of an inlet to Swift Reservoir.
- on an old North-South blazed line.
- approx. 400 ft. North of a creek, which bears to the Northwest.
- approx. 400 ft. West of another creek, which bears to the Northeast.
- in an existing stand of large Fir.

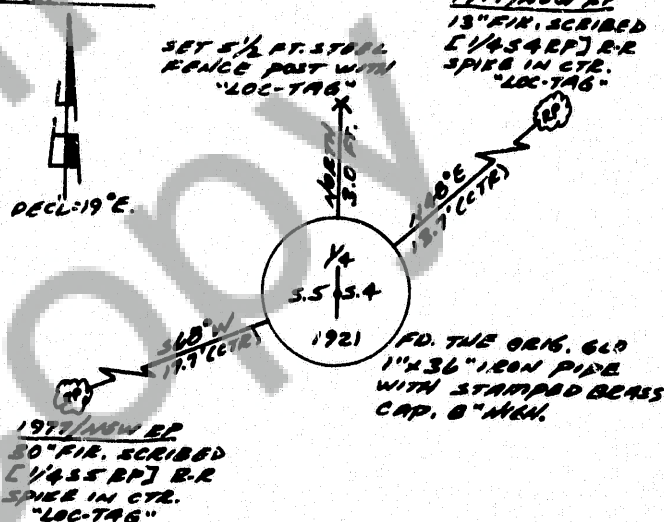

Washington Plane Coordinates: _____ Zone, Y _____ X _____
Order Accuracy. Derived From: _____

Pin Pointed on Photo No. _____ Date _____ Located at _____

SURVEYOR'S CERTIFICATE

This corner record correctly represents work performed by me or under my direction in compliance with the provisions of Chapter 50, Laws of 1973. Date August 28, 1989

Signature Calvin J. Hampton, PLS LS #18,087
Certificate No



AUDITOR'S CERTIFICATE

Filed for record this _____ day of _____ 19 _____ at _____ M. In _____ of _____ at page _____ at the request of _____

FILED FOR RECORD
BY Calvin J. Hampton
AUDITOR
GARY H. OLSON
30 12 35 AM 1989

Filed, as prescribed by Bureau of Surveys and Maps pursuant to the provisions of Section 5 (2), Chapter 50, Laws of 1973.

County Auditor

Registered p
Indexed, Dir p
Indirect p
Filed 9-18-89
Mailed p