



107738

BOOK 6/6 PAGE 46

LAND CORNER RECORD

HAMPSTUR CORPORATION
1010 Douglas A3
LONGVIEW, WASHINGTON 98632

T 6 NR 6 E. SKAMONTIA County
Segregated Surveys: Corner Code No. A-11
Name: N. 1/4 corner of Section 4 Corner No.:
DLC, HES, Tract, Mining Claim, Indian Allotment, Federal Reserve, Townsite.

1. History of Corner Establishment and Subsequent Restoration:

This corner was originally established by Lewis Shelton in 1900, while working under GLO contract #552. Then in 1921, Chester Pecore remonumented the corner with an iron pipe and brass cap while working under GLO contract, group #19. The corner was found and used in 1977 by HAGEDORN, Inc. during a survey of Section 4 and additional references were made. Then on August 30, 1988, R. Bogdon (from HAMPSTUR CORP.) found remains of both original BT's and 1 1977 RP, but the monument had been destroyed by a cat road. The monument shown in the diagram below was then established under the direction of C. Hampton, PLS #18,087.

2. Description of Evidence Found:

ORIGINAL GLO MONUMENT: a 1"x36" iron pipe with brass cap; missing (destroyed by cat work).

ORIGINAL BT's (scribed in 1900):

- 12" Fir, N30°E--16 lks.; now gone- position falls on North edge of fire trail.
- 24" Fir, S09°E--15 lks.; found a rotted stub one foot tall, at rec. location.

ORIGINAL BT's (scribed in 1921):

- 14" Hemlock, N4½°E--49 lks.; found a 20" stump, 2 ft. high at record location.
- 14" Fir, S58°W--38 lks.; now gone-- possibly destroyed by cat work.

3. Describe Monument, Accessories and Corollary Data to Perpetuate this Corner Location. Diagram corner and indicate meridian and reference to map of record. Surveyor's Field Book No. NEW RP

PS-056 Page No. 40 Date of work 8-30-88

LOCATION:

- on a 25% West slope.
- in an East-West fire trail.
- on an old East-West cutting line with approx. 8 yr. old reprod to the South.
- approx. 450 ft. West of a N-S ridge.
- S20°W--approx. 700 ft. from a slide on road # 1020.
- Found a USFS location tag on a 27" Cedar, marked "East--25 feet".

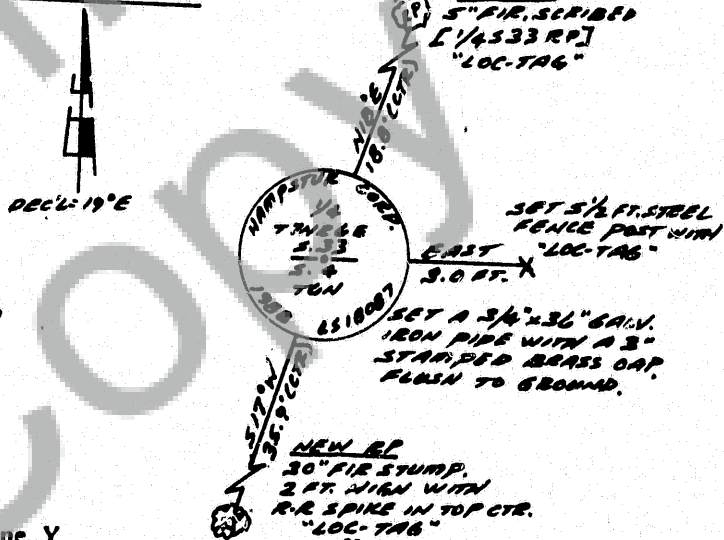

Washington Plane Coordinates: Zone, Y
Order Accuracy. Derived From: X
Pin Pointed on Photo No. Date Located at

SURVEYOR'S CERTIFICATE

This corner record correctly represents work performed by me or under my direction in compliance with the provisions of Chapter 50, Laws of 1973. Date August 28, 1989

Calvin S. Hampton, PLS

LS #18,087

Certificate No



AUDITOR'S CERTIFICATE

Filed for record this day of 19 at M. In
of at page at the request of

FILED FOR RECORD
SKAMONTIA CO. WASH.
BY
Aug 30 1989
GARY J. OLSON
CLERK

County Auditor:

Registered
Indexed, vir
Indirect
Filed 9-1-89
Mailed

Form prescribed by Bureau of Surveys and Maps pursuant to the provisions of Section 5 (2), Chapter 50, Laws of 1973.