

107734

BOOK 6/6 PAGE 42

HAMPSTUR CORPORATION
1010 Douglas A3
LONGVIEW, WASHINGTON 98632

LAND CORNER RECORD

T. 6 N. R. 6 E. , W.M.

SKAMANIA

County

Segregated Surveys:

Corner Code No. A-5

Name: NW. corner of Section 5

Corner No.:

DLC, HES, Tract, Mining Claim, Indian Allotment, Federal Reserve, Townsite.

1. History of Corner Establishment and Subsequent Restoration:

This corner was originally established in 1900 by Lewis Shelton, working under GLO contract #552. Then in 1921, Chester Pecore remonumented the corner with a 2"x36" iron pipe and brass cap, while working under GLO contract, group #19. The corner was visited by various surveyors since that time for various projects. On July 28, 1988, R. Bogdon (from HAMPSTUR CORP.), found the above monument along with remains of 2 BT's and 4 RP's, at which time he re-referenced the corner with 4 RP's and a steel reference post, while working on a "corner restoration" project for PLUM CREEK TIMBER COMPANY, under the direction of C. Hampton, LS #18,087.

2. Description of Evidence Found:

1921 ORIGINAL GLO MONUMENT: fd. the 2"x36" iron pipe with brass cap, set by Pecore in 1921 as mentioned above and shown in the diagram below.

ORIGINAL BT's (scribed in 1900):

- 10" Fir, N21 $\frac{1}{2}$ °E--25 lks.; fd. an uprooted, decayed 20 ft. stub, lying Northeasterly.
- 16" Fir, S48 $\frac{1}{2}$ °E--22 lks.; fd. 30" tree, uprooted and lying to the Northeast
- 8" Fir, S56°W--30 lks.; gone--position falls in old fire trail.
- 8" Fir, N17°W--32 lks.; gone--found scattered remains of decayed wood at record loc.

SUBSEQUENT RESTORATION:

Found 4 RP's being DNR tags on small trees.

3. Describe Monument, Accessories and Corollary Data to Perpetuate this Corner Location. Diagram corner and indicate meridian and reference to map of record. Surveyor's Field Book No.

PS-056 Page No. 25-26 Date of work 7-28-88

LOCATION:

- on a NE. slope, approx. 75 ft. South of abrupt descent.
- on an existing E-W cutting line, with mature timber to the North and clearcut to the South.
- approx. 100 ft. North of an E-W spur ridge.
- approx. 100 ft. West of an abrupt descent.
- 5 ft. North of an E-W fire trail.
- approx. 150 ft. North and 350 ft. East from the end of road #1062.

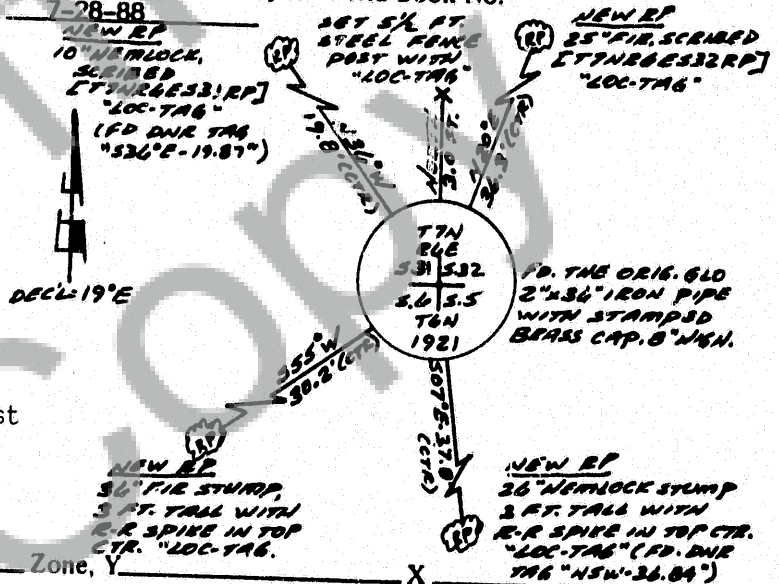

Washington Plane Coordinates:

Zone, Y

X

Order Accuracy. Derived From:

Pin Pointed on Photo No. Date Located at

SURVEYOR'S CERTIFICATE

This corner record correctly represents work performed by me or under my direction in compliance with the provisions of Chapter 50, Laws of 1973. Date August 28, 1989

Signature Calvin J. Hampton, PLS

LS #18,087

Certificate No



AUDITOR'S CERTIFICATE

day of 19 at M. In
of at page at the request of

County Auditor

Form prescribed by Bureau of Surveys and Maps pursuant to the provisions of Section 5 (2), Chapter 50, Laws of 1973.

Registered ☒
Indexed, Air ☒
Indirect ☒
Filed 9-1-89
Filed