

104578

State of Washington
DEPARTMENT OF NATURAL RESOURCES
BUREAU OF SURVEYS AND MAPS
LAND CORNER RECORD

32 | 33

Skamania County

T 4 N, R 7E, W.M.

Corner Code No. Z-9

Segregated Surveys:

Name: n/a

Corner Number: n/a

1. History of Corner Establishment and Subsequent Restoration:

Originally established in 1903 by GLO Surveyor Robert Witham with a post and two bearing trees.

Restored in 1969 by DNR employee John Lawson, with a 4"x4" DNR concrete monument, set record distance and bearing from the fir bearing tree.

2. Description of Evidence Found:

4"x4" DNR concrete monument

45" dead fir bearing tree at N5SW 7.35 feet to nail.

FILED FOR RECORD
SKAMANIA CO. WASH
BY D.N.R.

JAN 19 11 50 AM '88
A. News, Dep.
AUDITOR
GARY M. OLSON

3. Describe Monument, Accessories and Corollary Data to Perpetuate this Corner Location. Diagram corner and indicate meridian and reference to map of record. Surveyor's Field Book No. 600.27, Page No. 46. Date of work April 14, 1987.

See corner diagram on reverse side.

Washington Plane Coordinates: 1st Zone, Y 166,508.53, X 1,627,173.95 Third Order Accuracy.

Derived from: NGS "MOWICH," NGS "SEDUM," DNR 1,4N7E, DNR 11,3N7E.

Pin Pointed on Photo No. _____, Date _____, Located at _____.

SURVEYOR'S CERTIFICATE

This corner record correctly represents work performed by me or under my direction in compliance with the provisions of Chapter 50, Laws of 1973.
Date: January 6, 1988.

H. Thomas Laird Jr. 21490
Signature Certificate No.

[Seal]

Registered S
Indexed, Dir S
Indirect S
Filed S

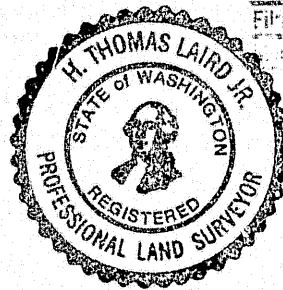
**AUDITOR'S CERTIFICATE**

Filed for record this _____ day of _____ 19 _____ at _____ M.
In Book _____ of _____ at page _____ at the request
of Washington State Department of Natural Resources.

County Auditor

'60 Survey of 1903
 EAST ON TRUE LINE ON S. Bdy SEC. 32
 T4N R7E
 80.00 CH. SET Maple Post from which
 7" DogWOOD N76°30'E, 481.
 30" FIR N55°30'W, 11 L

STD SEC. CORNER 32/33 T4N R7E

4X4 CONC. MON W/BRASS CAP SET
 by LAWSON, 1969
 45" DEAD FIR @ N55W 7.35 ft
 BT. (to RP NAIL)

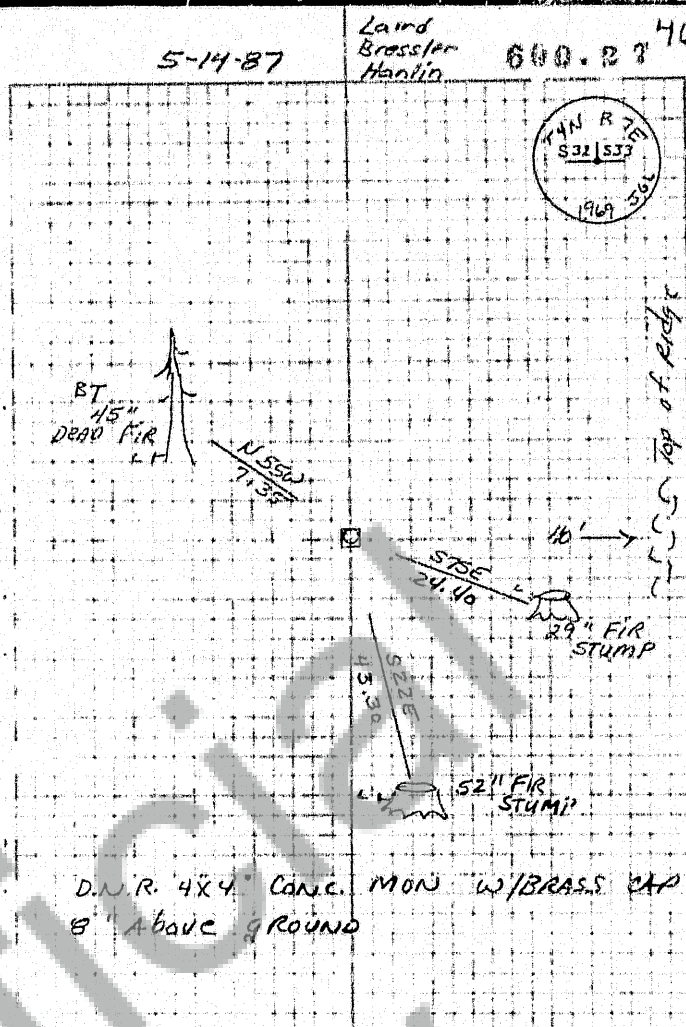

BOOK 4/7 PAGE 114