

102271

BOOK 612 PAGE 5

State of Washington
 DEPARTMENT OF NATURAL RESOURCES
BUREAU OF SURVEYS AND MAPS
LAND CORNER RECORD

14	13
23	24

Skamania County

T 6 N, R 5 E, W.M.

Corner Code No. N-21

Segregated Surveys:

Name: n/a

Corner Number: n/a

1. History of Corner Establishment and Subsequent Restoration:

Originally established in 1909 by GLO Surveyor C. Frank Rhodes with a notched stone and 1 live and 3 dead BTs.

No subsequent restoration found.

FILED FOR RECORD
 SKAMANIA CO. WASH
 BY TECHNICAL

DEC 1 1 16 PM '86

2. Description of Evidence Found:

Original stone with proper notches.
 23" fir stub BT at N18W 15.9 feet, with visible scribe.
 26" cedar BT at S61W 110.8 feet, with visible scribe.
 Remains of cedar BT at N67E 6.5 feet.

AUDITOR
 GARY M. OLSON

3. Describe Monument, Accessories and Corollary Data to Perpetuate this Corner Location.
 Diagram corner and indicate meridian and reference to map of record. Surveyor's Field Book No. 601.07, Page No. 57. Date of work September 10, 1985.

Replaced original stone with DNR aluminum monument with stamped cap.

See reverse side for corner diagram.

SURVEYOR'S CERTIFICATE

[Seal]

This corner record correctly represents work performed by me or under my direction in compliance with the provisions of Chapter 50, Laws of 1973.
 Date: November 18, 1986.

Signature

H. Thomas Laird Jr.

21490

Certificate No.

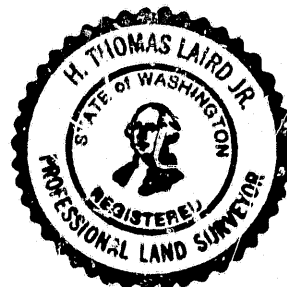
**AUDITOR'S CERTIFICATE**

Filed for record this _____ day of _____ 19____ at _____ M.
 In Book _____ of _____ at page _____ at the request
 of Washington State Department of Natural Resources.

Registered _____

County Auditor

FOUND ON SET 15X19 STONE WITH
3 NOTCHES ON SOUTH, 1 NOTCH ON EAST

18" Dead Cedar	N 09 E	10 L	460
15" Dead Hem.	S 47 3/4 E	34 L	22.49
15" Cedar	S 61 3/4 W	172 L	113.5
28" Dead fir	N 24 W	28 L	18.42

SECTION CORNER $\frac{1413}{2324}$ 76NRSE

FOUND 6X7X12 STONE WITH
SOUTH
FACED ON EAST AND NOTCH
ON EAST SIDE

28" FIR STUB w/ VIS. SCRIBE 4 CT

26th Fedor M. SCRIBE

Remains of Dead Cedar

9-10-83

GORDON
BRESELER
HAMILTON

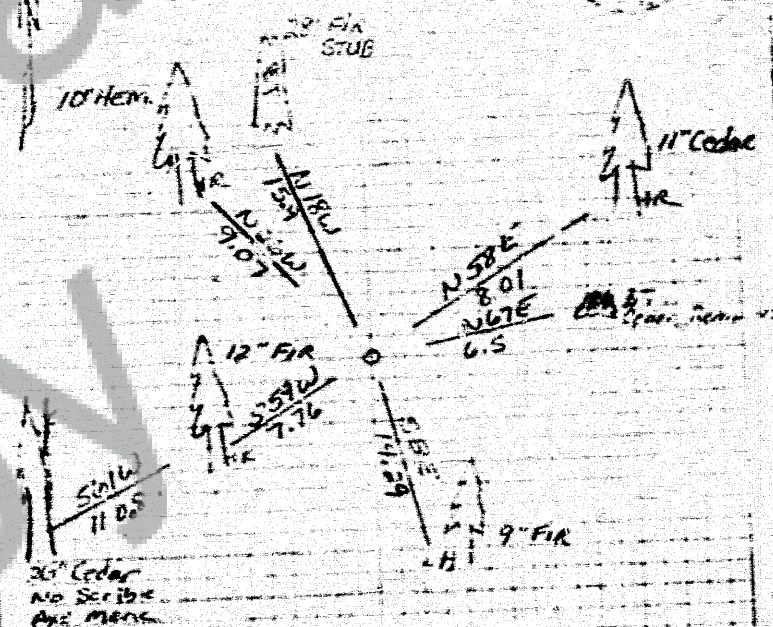

Replaced orig STONE WITH 2'x2' ALUM.
PIPE W/ D.N.R. ALUM. CAP 7' ABOVE GROUND
PLACED STONE TO SOUTH OF PIPE

BOOK 215 - 1880