

102270

BOOK 6/5 PAGE 3

State of Washington  
DEPARTMENT OF NATURAL RESOURCES  
BUREAU OF SURVEYS AND MAPS  
**LAND CORNER RECORD**

15	14
22	23

Skamania County

T 6 N, R 5 E, W.M.

Corner Code No. N-17

Segregated Surveys:

Name: n/a

Corner Number: n/a

1. History of Corner Establishment and Subsequent Restoration:

Originally established in 1909 by GLO Surveyor C. Frank Rhodes with a notched stone and 4 BTs.  
Found and referenced by Zoltan Kosa, LS 9871 in 1983.

FILED FOR RECORD  
SKAMANIA CO. WASH  
BY [illegible]

Dec 1 15 PM '86

2. Description of Evidence Found:

Original stone with proper notches.  
37" cedar BT at N83E 24.99 feet to nail. Visible scribe.  
29" hemlock BT snag at S68W 18.04 feet to nail. Visible scribe.  
35" true fir BT at N11W 27.0 feet. Not chopped out.  
Bt tags and 3 RP tags by Kosa.

3. Describe Monument, Accessories and Corollary Data to Perpetuate this Corner Location.  
Diagram corner and indicate meridian and reference to map of record. Surveyor's Field Book No. 601.07A, Page No. 56. Date of work July 16, 1986.

Replaced original stone with a DNR aluminum monument with stamped cap.  
See reverse side for corner diagram.

**SURVEYOR'S CERTIFICATE**

This corner record correctly represents work performed by me or under my direction in compliance with the provisions of Chapter 50, Laws of 1973.  
Date: November 18, 1986.

H. Thomas Laird Jr. 21490  
Signature Certificate No.

[Seal]

**AUDITOR'S CERTIFICATE**

Filed for record this \_\_\_\_\_ day of \_\_\_\_\_ 19 \_\_\_\_\_ at \_\_\_\_\_ M.  
In Book \_\_\_\_\_ of \_\_\_\_\_ at page \_\_\_\_\_ at the request  
of Washington State Department of Natural Resources.

County Auditor

SLD Survey of 1909

20.00 set of sandstone 20x16x8 w/  
3 notches on south and 2 on east edges.

20' cedar N84E 40L 26.4

10' hemlock S13½E 34L 22.4

12' hemlock S73W 29L 19.1

12' fir N11W 29L 19.1

Section Corner  $\frac{E14}{22 \times 22}$  T6N R5E

Found original stone w/ all notches.

37" cedar BT @ N83E 24.99' to nail.  
visible scribe.

27" hemlock snag BT @ S68W 18.04' to  
nail. visible scribe

35" true fir BT @ N11W 27.0'

BT tags & 3 RP tags by Z. Kosa,  
July 1983.

7-16-83

Laird  
Hartlin

56  
601.67A

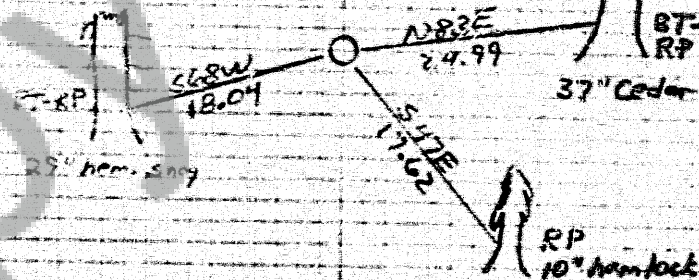
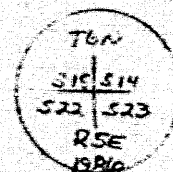

Measurements to existing nails in near edge  
of trees.

Replaced only stone w/ DNR alum mon.  
Placed stone on east side.