

113961

NOTICE OF MINING LOCATION  
state of washingtonSKAMANIA county  
Noggerhead mining district

BOOK 129 PAGE 690

FILED FOR RECORD  
STATE OF WASHINGTON  
BY Debra Tucksen

JUL 13 9 55 AM '92

P. Lowry

GARY H. OLSON

NOTICE IS HEREBY GIVEN, that the undersigned, having complied with the requirements of chapter six, Title thirty-two of the revised statutes of the united states, and the laws of the above state, and the local customs and regulations of said district, has located and does hereby locate 1500 linear feet in length, and 600 feet in width on the Big Daddy lode, vein, ledge situated in above state, county or mining district, and further described as follows: commencing at a post marked no 1 at the discovery shaft (cut or tunnel) from thence 300 feet in a easterly direction to an end post marked no 2, thence 1500 feet in a Southerly direction to a corner post marked no 3, thence 300 feet in a westerly direction to a corner post marked no 4 thence 300 feet in a westerly direction to a corner post marked no 5 thence 1500 feet in a Northerly direction to corner post marked no 6 thence 300 feet in a easterly direction to said end post no 2; hereby locating and intending to claim 106 feet in a Northerly direction from discovery to the North end line, and 1400 feet in the opposite direction from discovery to the South end line, and 300 feet on each side of the middle of said lode or ledge, for the purpose of mining the same and claiming all surface rights, privileges minerals, with all dips, spurs, angles and variations, and other rights granted by existing laws and customs. This claim is further described as follows: Discovery post is 100 feet up McCoy from Camp ck.  
Claim is bordered on the north end by even dozen's claim

This notice is placed at discovery on post no 1; posts are placed at each corner, and the name of this lode and date of location, are placed on all posts.

LOCATED THIS 12 day of July, 1992Debra L. Tucksen  
locatorsstates of washington, county of Skamania

I, Debra L. Tucksen, do solemnly swear that I am a citizen of the United states of America, and that I am acquainted with the mining ground described in this location, and herein called the Big Daddy lode, ledge or claim; that I have opened up new ground on said claim to the extent and depth of ten feet, as required by the laws of the state of washington, to-wit:

Subscribed and sworn to before me this 13<sup>th</sup> day of July, a.d., 1992Notary Public in and for the state of washington, residing at Canon Wash.My Commission Expires 2/23/95

PEGGY B. LOWRY  
STATE OF WASHINGTON  
NOTARY - PUBLIC  
My Commission Expires 2-23-95

Registered P  
Indexed, Dir P  
Indirect P  
Filed 7/2/92  
Mailed

Signature of Claimant Debra L. Lucksen date 7-12-92

MAP of Mining Claim(s)

Township 10 N Range 6 E Section 10 State of WASH

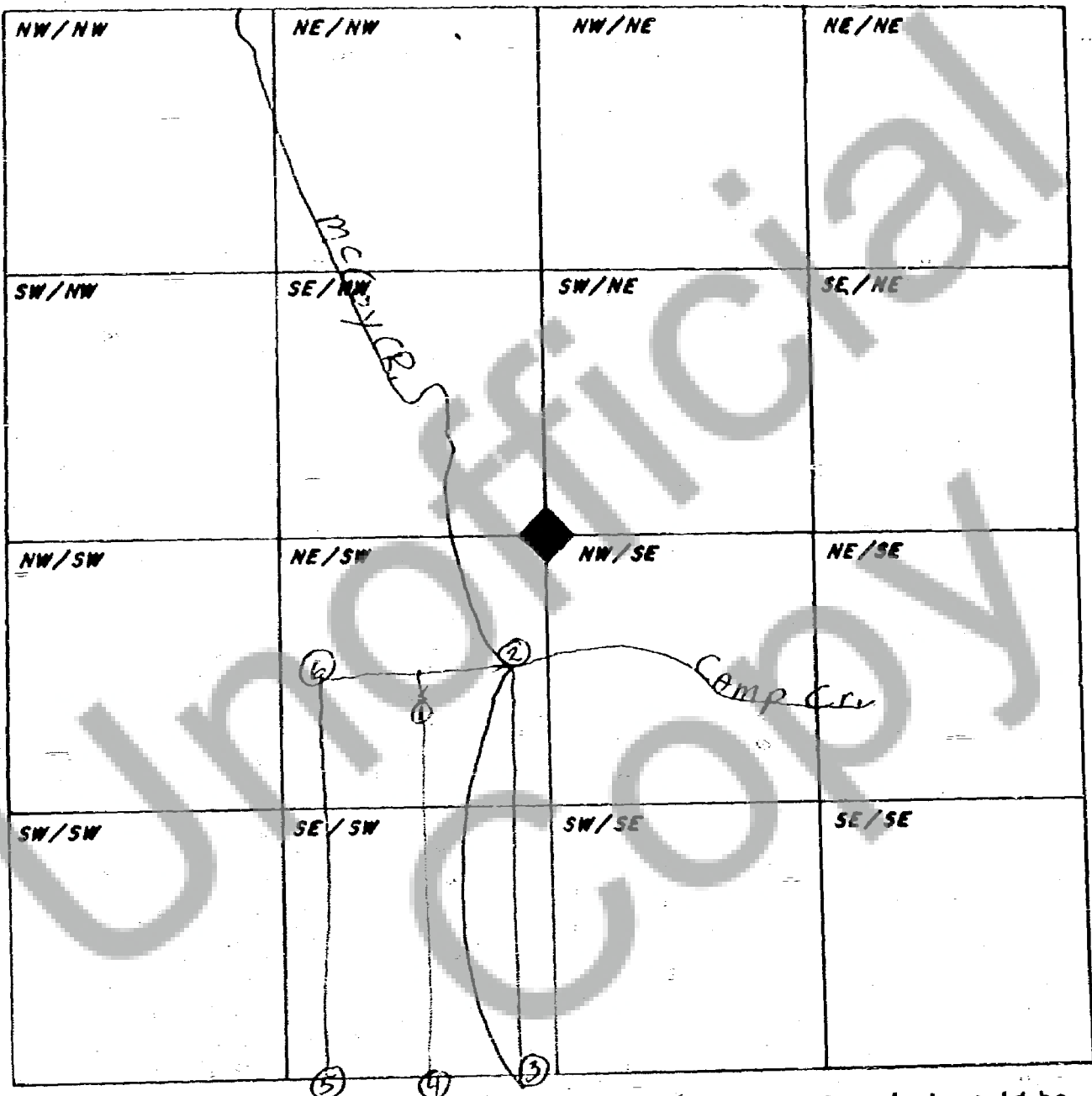

When drawing your claim(s) use an ordinary ruler. 1/8th of an inch would be 100 feet so a full size lode (600' x 1500') would be 3/4" by 1 7/8". A full size placer (1320' x 660') would be 1 5/8" by 13/16".