

111942

BOOK 124 PAGE 796

## NOTICE OF MINING LOCATION

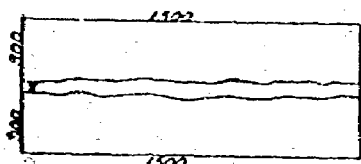

X Discovery

This diagram explains method of description of claim.

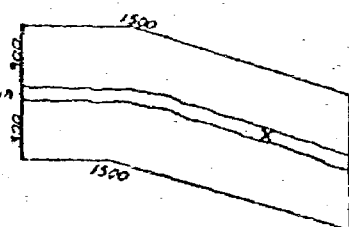

Washington

State

SKAMANIA

County

(or Recording Precinct

Mining District

NOTICE IS HEREBY GIVEN That the undersigned who is/are (ha declared intention to become) citizen of the United States, have discovered and have located and claimed and do hereby locate 1320 linear feet in length, and 2640 feet in width on the

Gold Sting Ray #4

Lode, vein, ledge or deposit (or placer ground), situated in the above State, County (or Recording Precinct) and Mining District, and further described as follows: Commencing at a post marked No. 1 at the Discovery

shaft (cut or tunnel), from thence 660 feet in a EAST direction to an

end post marked No. 2, thence 2640 feet in a South direction to a corner

post marked No. 3, thence 1320 feet in a WEST direction to a corner post

marked No. 4, thence 2640 feet in a NORTH direction to a corner post

marked No. 5, thence 660 feet in a EAST direction to a corner post

marked No. 6, thence feet in a direction to said end post

No. 2; hereby locating and intending to claim feet in a

direction from discovery to the end line,

and feet in the opposite direction from discovery to the end

line and feet on each side of the middle of said lode or ledge, for the pur-

pose of mining the same and claiming all surface rights, privileges, and minerals, with all dips, spurs, angles and variations, and other rights granted by existing laws and customs.

This claim is further described by reference to natural objects or permanent monuments, as follows:

The above dimensions describe the physical dimensions of Gold Sting Ray #4 located in Township 3N, Range 5E and section 4. This claim is a 80 acre placer claim described by:

E 1/2, SW 1/4, Sec 4, T. 3N, R. 5E. [SEE MAP for Gold Sting Ray #4] on RD 109.

This notice is placed at Discovery on post No. 1; posts are placed at each corner, and the name of this lode, and date of location, are placed on all posts.

Located the 27 day of August, 1991.

Registered  
Indexed, Dir  
Indirect  
Filed 8/30/91  
91-2-4

WITNESSES:

Virginia Salmeron  
Helen Felt

David Fisher David Rubin  
Randy Griffin  
J. S. Ruten

FILED FOR RECORD Locators.  
SEPT 1991 WASH  
BY David Ruten

AUG 27 4 30 PM '91

P. Lowry

Notice of Mining Location

© Washington Legal Blank Inc., Bellevue, WA Form No 264D 6/84

MATERIAL MAY NOT BE REPRODUCED IN WHOLE OR IN PART IN ANY FORM WHATSOEVER. GARY L. OLSON

STATE OF Washington } ss. (Individual Acknowledgment)  
 County of Skamania

I, David Lee Rutan, do solemnly swear that I am a citizen of the United States of America (or have declared my intention to become such) and that I am acquainted with the mining ground described in the notice of location, and herein called the Gold Sting Rav #4 Placer Mining Claim; that the ground and claim herein described, or any part thereof, has not, to the best of my knowledge and belief, been located according to the laws of the United States and this State, or if so located, that the same has been abandoned or forfeited by reason of failure of such former locators to comply in respect thereto with the requirements of said laws; and that I have performed the equivalent of at least \$100.00 in labor on such claim and have complied with all applicable laws of this State pertaining to this claim.

David Rutan

Subscribed and sworn to before me this 27 day of August, 1991.

Peggy B Lowry

Notary Public in and for the State of Washington  
 residing at Carson in said County.

PEGGY B. LOWRY  
 STATE OF WASHINGTON  
 NOTARY - - - PUBLIC  
 My Commission Expires 2-23-95

Unofficial Copy

Signature of Claimant Randy G. Ritz / David Ritz date August 27, 1991  
Randy G. Ritz Dale E. Ritz  
 MAP of Mining Claim(s)

Township T3N Range R5E Section 4 State of Washington

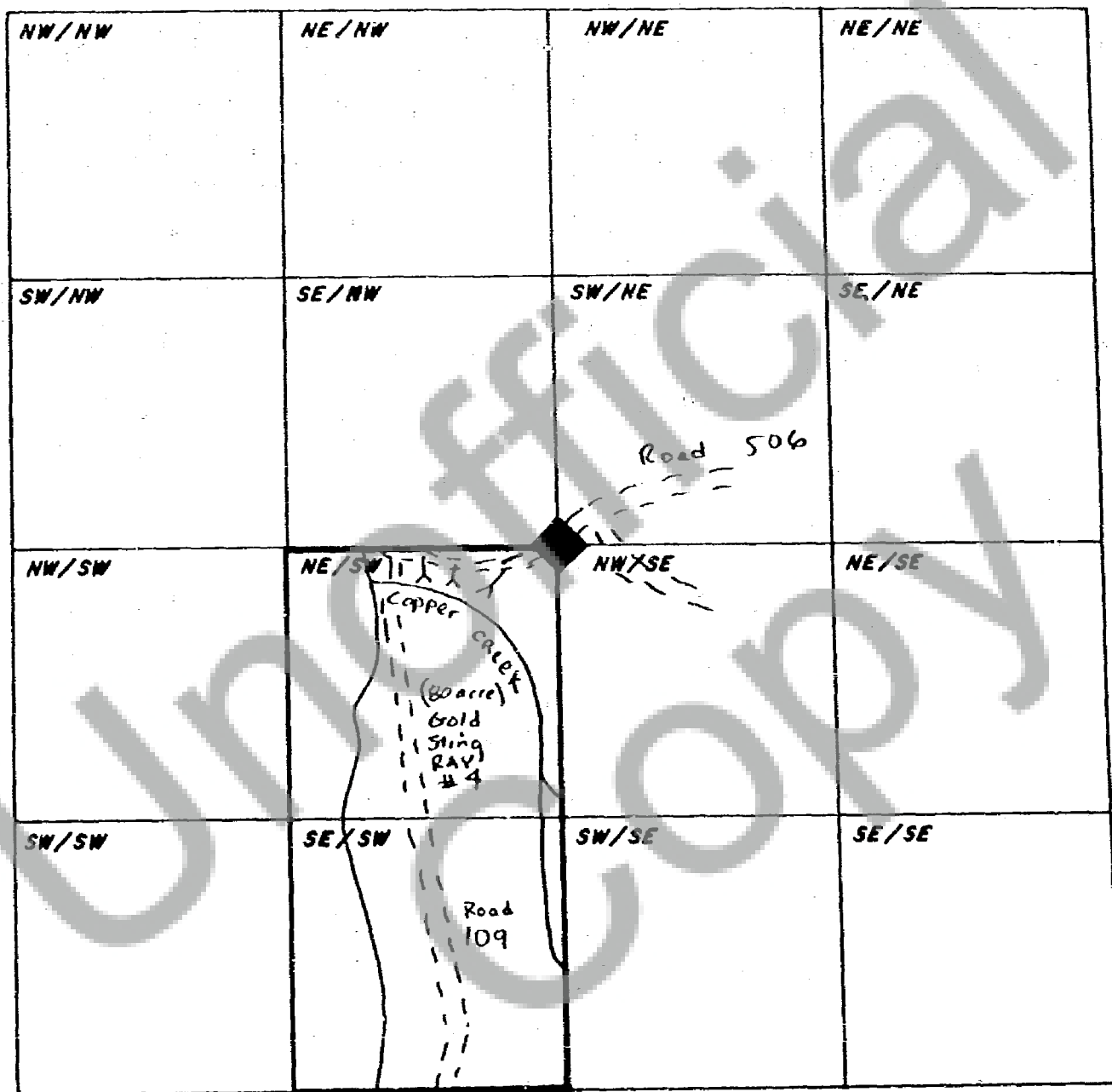

When drawing your claim(s) use an ordinary ruler. 1/8th of an inch would be 100 feet so a full size lode (600' x 1500') would be 3/4" by 1 7/8". A full size placer (1320' x 660') would be 1 5/8" by 13/16".

NOTE: Road numbers were taken from The U.S. Geological Survey maps, edition 1986, Gumbat MTN, Wash..