

SANDBERG SHORT PLAT IN THE NW 1/4 OF THE NW 1/4 SEC. 23, T 4 N, R 7 E, WM SKAMANIA COUNTY, WASHINGTON

Planning Dept.
SEP 26 1990
P. Lowry

We, owners of the above tract of land, hereby declare and certify this Short Plat to be true and correct to the best of our abilities, and that this Short Subdivision has been made with our free consent and in accordance with our desires. Further, we dedicate all Roads as shown, not noted as private, and waive all claims for damages against any governmental agency arising from the construction and maintenance of said Roads.

Owner Harold Sandberg 6/27/90
Ralph Sandberg
or Sandberg
Owner Gloria Sandberg

Notary Public Martin Mohr 6/27/90 Date
OFFICIAL SEAL
MARTIN MOHR
NOTARY PUBLIC - OREGON
SKAMANIA COUNTY
My Comm. Expires Oct. 5, 1993

The lots in this Short Plat contain adequate area and proper soil, topographic and drainage conditions to be served by an onsite sewage disposal system unless otherwise noted on the Short Plat map. Adequacy of water supply is not guaranteed unless so noted on the Short Plat map.

Martin Smith ES 9-2-90
S.W. Washington Health District Date

This Short Plat complies with all County Road regulations and is of adequate description for purposes of subdividing.

CURT SKAAR 9-19-90
County Engineer Date

All taxes and assessments on property involved with this Short Plat have been paid, discharged or satisfied. 4-7-23-101

Laundon Telling Deputy 9-26-90
County Treasurer Date

The layout of this Short Subdivision complies with Ordinance 1980-07 requirements, and the Short Plat is approved subject to recording in the Skamania County Auditor's Office.

Robert Lee 9/19/90
County Planning Department Date

Surveyor's Certificate

This map correctly represents a survey made by me or under my direction in conformance with the requirements of the Survey Recording Act at the request of

John Sandberg
in April 1990

John C. Klein
PLS # 22098

STATE OF WASHINGTON
COUNTY OF SKAMANIA)

I hereby certify that the within instrument of writing filed by Bob Lee
of Planning Dept. at 12:15

PM September 26 1990 was

recorded in Book 3 of Short Plats

at Page 174

P. Lowry
Recorder of Skamania County, Wash.

Mary M. Olson by P. Lowry - Deputy
County Auditor

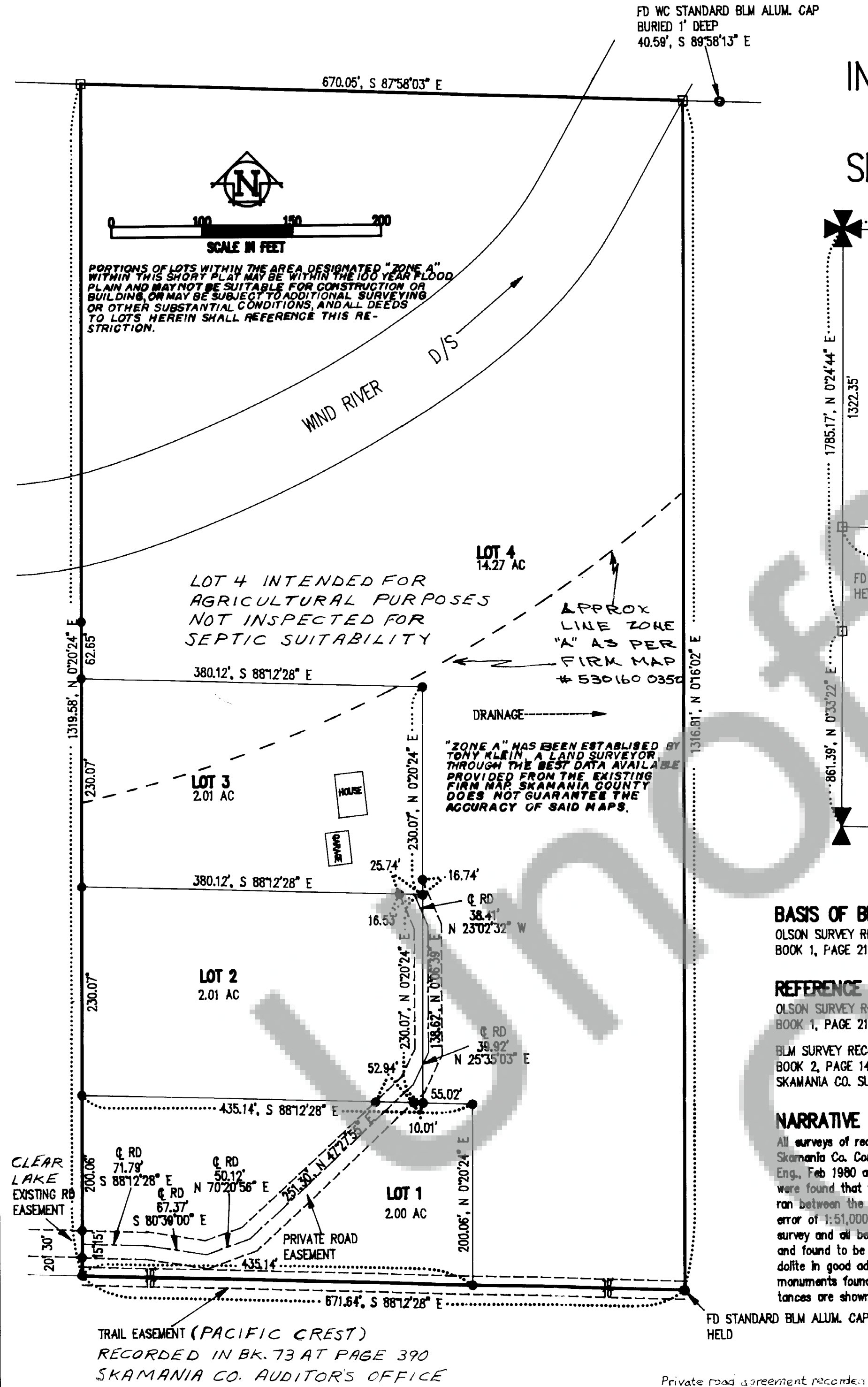

BASIS OF BEARING
OLSON SURVEY RECORDED
BOOK 1, PAGE 211, SKAMANIA CO. SURVEYS

REFERENCE SURVEYS
OLSON SURVEY RECORDED
BOOK 1, PAGE 211, SKAMANIA CO. SURVEYS

BLM SURVEY RECORDED
BOOK 2, PAGE 141-A (FILM #97295)
SKAMANIA CO. SURVEYS

NARRATIVE

All surveys of record of Section 23 were reviewed at the Auditor's Office at the Skamania Co. Courthouse and two were found to be most reliable; one by Olson Eng. Feb 1980 and one by BLM in 1982. A field search was done and 3 monuments were found that were set by the above mentioned surveys. A traverse was then run between the monuments with an angular error of 1" per angle and a linear error of 1:51,000 after angle adjustment. The traverse was rotated to the Olson survey and all bearings and distance were compared with the previous surveys and found to be within acceptable tolerances. A 10 second total station theodolite in good adjustment was used to measure all angles and distance. All monuments found and established along with the measured bearings and distances are shown herein.

FD STANDARD BLM ALUM. CAP
HELD

Private road agreement recorded in book 120, page 735 of Skamania County Auditor's records.

LEGEND

- = SET 5/8" IR WITH PLASTIC CAP
- = FOUND MONUMENT AS NOTED
- = CALCULATED POSITION AS PER OLSON SURVEY RECORDED BOOK 1, PAGE 211, SKAMANIA CO. SURVEYS

LEGAL DESCRIPTION

THE EAST HALF OF THE NORTHWEST QUARTER OF THE NORTHWEST QUARTER OF SECTION 23, TOWNSHIP 4 NORTH, RANGE 7 EAST, WILLAMETTE MERIDIAN, SKAMANIA COUNTY, WASHINGTON.

Klein & Assoc.
LAND SURVEYING
1109 Country Club Road
Hood River, Oregon 97031
Tele: (503) 336-3322
DATE: APRIL 25, 1990
JOB NO: 89054

Land within this subdivision shall not be further subdivided for a period of 5 years unless a final plat is filed pursuant to Skamania County Code, Title 17, Subdivisions, Chapter 17.04 through 17.60 inclusive.

WARNING
Purchasers of a lot, or lots, in this plat are advised to consult the Skamania County Development Assistance Handbook with regard to private roads because the lot, or lots, in this plat are serviced by private roads. Private roads are not maintained by Skamania County. Lot owners within this plat must pay for the maintenance of the private roads serving this plat, including grading, drainage, snow plowing, etc. The condition of the private road may affect subsequent attempts to divide your lot or lots. Private roads must comply with Skamania County's private road requirements. Maintenance Of Private Roads NOT Paid For By Skamania County.