

106197

BOOK 111 PAGE 914

FORM No. 697—NOTICE OF PLACER LOCATION—OREGON.

© 1982 STEVENS-NESS LAW PUBLISHING CO., PORTLAND, OREGON 97204

CL

Lode Notice of Location of Placer Claim

STATE of Wash County of Shannon Mining District.

NOTICE HEREBY IS GIVEN That the undersigned locators, each a citizen of the United States or one who has declared his intention to become such, have discovered a placer deposit of locatable minerals upon the public domain of the United States which is open to mineral entry and location within the above state, county and mining district; and, in accordance with the laws of the United States and the State of Oregon, have located and hereby do locate a placer claim of 2.0 acres by posting this notice of location on a post or monument in a conspicuous place inside the boundaries of the claim. The claim is named the Red SQUAW

Claim, which is described as follows (fill out one of the two sections below):

(1)
If claim is on surveyed land:

This claim comprises the is in the NW/SE of Section 30, Township 4N, Range 5E, of the Willamette Meridian, Copper Creek Bridge #4109 is 600' South & West of Red SQUAW marker.

(2)
If claim is on unsurveyed public land or if on surveyed land, and it is not practicable to describe claim by legal subdivisions:

The distance between posts may not exceed 1,320 feet. The number of posts will vary depending on the size of the claim.

The location of this claim is distinctly marked on the ground so that the boundaries of the claim may be readily traced; Starting at Copper Creek Bridge #4109 is 600' South & West of Red SQUAW marker thence in a

(If possible, name some government survey corner; otherwise describe some natural object or permanent monument in the vicinity)

Magnet, Back West 300 feet, more or less, to the beginning point of the description of the placer claim hereby located, to-wit: a substantial post set in the ground, marked Post No. 1;

thence 300' feet in a West direction to a post marked No. 2;

thence 1500' feet in a South direction to a post marked No. 3;

thence 600' feet in a East direction to a post marked No. 4;

thence 1500' feet in a North direction to a post marked No. 5;

thence 300 feet in a West to marker direction to a post marked No. 6;

thence _____ feet in a _____ direction to a post marked No. 7;

thence _____ feet in a _____ direction to a post marked No. 8;

thence _____ feet in a _____ direction to the post marked No. 1.

This claim is situated in the SE (quarter section) of Section 30, Township, 4 North, Range 5 East, of the Willamette Meridian, either as surveyed by the U.S. Government or protracted if the land is unsurveyed,

The locators intend to hold and work the above described claim as provided by the laws of the United States and the State of Oregon and claim all of the rights and privileges granted by existing laws and customs. In construing this location notice, the singular includes the plural and vice versa if the context so requires.

The adjoining claims are _____

Located 11-11-88, 1988

Red SQUAW Claim

Subscribed and sworn to this 16th day of November, 1988.

Rosalind M. Davis, Notary Public

Della Shidtrout

RT Nelson 35447

Garcia, Wash.

Zip 98675

Locators.*

* If this is an association placer claim, list all individual members of the association and state that they are locating the claim as an association placer claim.

N

BOOK 111 PAGE 915

FILED FOR RECORD
SKAMMIA CO. WASH
BY Della Short

Nov 16 1 42 PM '88

E. Mayfield
AUDITOR

Signature of Claimant Della Short GARY M. OLSON date Nov 16 1988

MAP of Mining Claim(s)

Township 4N Range 5E Section 30 State of Washington

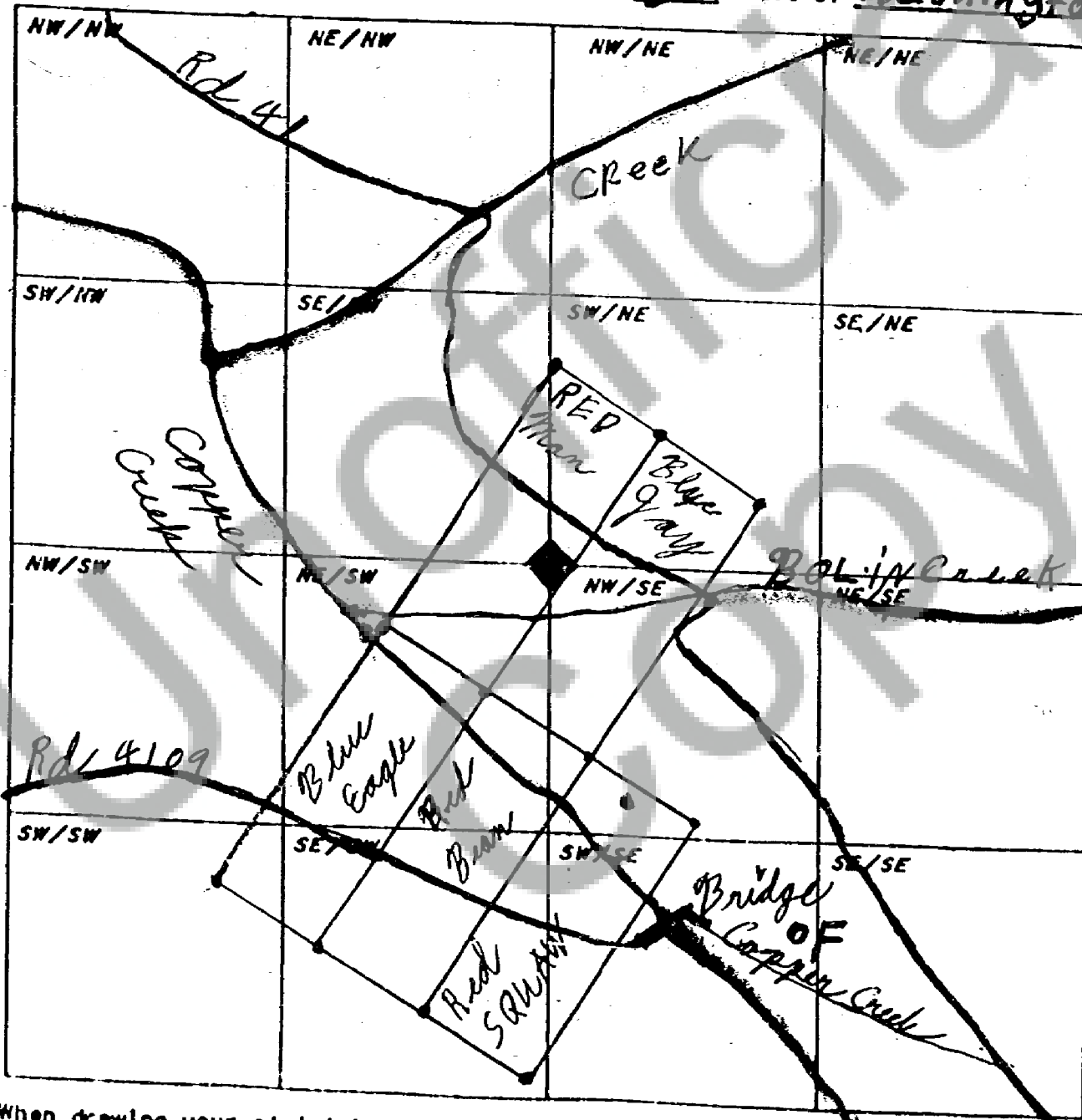

When drawing your claim(s) use an ordinary ruler. 1/8th of an inch would be 100 feet so a full size lode (600' x 1500') would be 3/4" by 1 7/8". A full size placer (1320' x 660') would be 1 5/8" by 13/16".

S