

Notice of Location of Placer Claim

Notice is hereby given that the undersigned, who is a ~~one~~ (or have declared There intention to become) citizen s of the United States, have on this 5 day of Sept, 1988 discovered at the place where this notice is posted a valuable placer deposit bearing Gold Silver - Coppy and other valuable minerals, and do No 1 hereby locate and claim same as the CORINA Placer Mining Claim.

This claim is situated in the Yellow Jacket Mining District, Section 5 Southeast 1/4, in Township 8 9 North Range 8 East, SKAMANIA County

The point of discovery whereon this notice is posted is situated on the East side of Yellow Jacket River off Road 2810 at mile Post 4 and Road 051

and from thence the boundaries of said claim are marked and described as follows:

from Point of discovery 300 FT East to Post (Red) No 1 Then along Road 051 1500 FT to Post No 2 Then West 600 FT across the River to Post No 3 Then 1500 FT North to Post No 4 then Back EAST 300 FT to Point of discovery

FILED FOR RECORD
SKAMANIA CO. WASH
BY DOYLE MURPHY
1015 NE 152TH
BUTHELL, WA 98011
SEP 9 4 52 PM '88
d. J. Dep.
AUDITOR
GARY H. OLSON

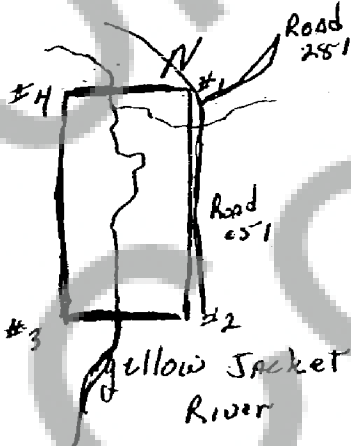

Address
9015 NE 152TH
BUTHELL WASH
98011

Notice dated and posted on the day aforesaid.

Discovered 5 Sept, 1988 by Doyle E Murphy
Located _____, 19____ by Doyle E Murphy
Locator Doyle E Murphy

Notice of location must be recorded within thirty days from the date of discovery at the office of the auditor of the county in which such discovery was made. Twenty Acres may be included in one placer claim and if located on surveyed land it must be according to legal subdivisions.

Care must be taken to fully describe the claim with reference to natural objects and permanent monuments or survey description, so that the boundaries can be readily traced. The blank spaces in this form must be carefully and properly filled out.

The discoverer must perform labor upon such location in developing the same to an amount which shall be equivalent in the aggregate to at least \$10.00 worth of such labor for each twenty acres, or fractional part thereof, contained in such location or claim, within sixty days from the date of discovery, and upon performance of such labor, file with the auditor of county an affidavit showing such performance and generally the nature and kind of work so done. Provided however, that certain federal regulations may apply, in addition or in place of the above.