

105460

FORM No. 830—NOTICE OF VEIN OR LODE LOCATION, OREGON

© 1982 STEVENS-NESS LAW PUBLISHING CO., PORTLAND, OREGON 97204

(CN)

OL

FILED FOR RECORD
SKAMANIA CO. WASH
BY LOREN D. MEYERS

NO. 4

Notice of Mining Location
VEIN OR LODE CLAIM

NO. 5

LOCATION DISCOVERY
POST NO. 1

Jul 15 2 00 PM '88

NO. 2

AUDITOR
GARY M. NELSON

STATE OF OREGON,

County of SKAMANIA

NO. 6

THIS DIAGRAM EXPLAINS METHOD OF
DESCRIPTION OF CLAIM.

NO. 7

SKAMANIA Mining District

NOTICE HEREBY IS GIVEN that the undersigned locators, each a citizen of the United States or one who has declared his intention to become such, have discovered a vein or lode of locatable mineral bearing rock in place upon the public domain of the United States which is open to mineral entry and location within the above state, county and mining district; and, in accordance with the laws of the United States and of the State of Oregon, have located and do hereby locate a claim upon such vein or lode by posting this notice of such discovery and location on a substantial post or monument at the point of discovery, marked Post No. 1. The name of the claim is:

LUCKY 1

Claim, further described as follows:

Commencing at a post marked No. 1 (Discovery Post), thence

100

feet in a

EASTERLY

direction to an end post marked No. 2, thence

300

feet in a

SOUTHERLY

direction to a corner post marked No. 3, thence

1500

feet in a

WESTERLY

direction to a corner post marked No. 4, thence

300

feet in a

NORTHERLY

direction to an end post marked No. 5, thence

300

feet in a

NORTHERLY

direction to a corner post marked No. 6, thence

1500

feet in a

EASTERLY

direction to a corner post marked No. 7, thence

300

feet in a

SOUTHERLY

direction to said end post marked No. 2.

The locators claim

100

feet in a EASTERLY

direction from point of discovery to the

EAST

end line and 1400

feet in the opposite direction from point of discovery to the

WEST

end line and

300

feet on each side of the middle of said vein or lode, further claiming all the surface rights, privileges and minerals, with all dips, spurs, angles and variations, and other rights granted by existing laws and customs. This claim is further described as being 3500

to-wit: ABOVE BRIDGE ON ROAD 531 THAT CROSSES THE
BIG WHITE SALMON RIVER THE CLAIM BEING
LOCATED 3500' UP THE RIVER

The general course or strike of the vein or lode as nearly as may be determined is WEST

This claim is situated in the SW 1/4 (designate quarter section) of Section 24, Township 8N, Range 9E, of the WILLAMET Meridian, as surveyed by the U.S. Government or protracted if the land is unsurveyed

The end lines of the claim are parallel to each other. The adjoining claims are

This notice is placed conspicuously at discovery post No. 1; posts are placed at each corner and both center ends. The location of this claim is distinctly marked on the ground so that the boundaries of the claim may be readily traced. In construing this location notice, the singular includes the plural and vice versa, where the context so requires.

Located

7/11/

1988

Loren D. Meyers

GENERAL ACKNOWLEDGMENT

NO 201

State of WASHINGTON

On this the 15th day of JULY 1988, before me,

County of SKAMANIA

SS.

SHIRLEY ANN NEVIS

the undersigned Notary Public, personally appeared

LOREN D. MEYERS

personally known to me
proved to me on the basis of satisfactory evidence
to be the person(s) whose name(s) IS subscribed to the
within instrument, and acknowledged that HE executed it.
WITNESS my hand and official seal.

Notary's Signature

Shirley Ann Nevis

my COMMISSION EXPIRES SEP 10, 1989



Signature of Claimant Loren D. Meepers date 7/11/88

MAP of Mining Claim(s)

Township 8 N Range 9 E Section 24 State of WASH.

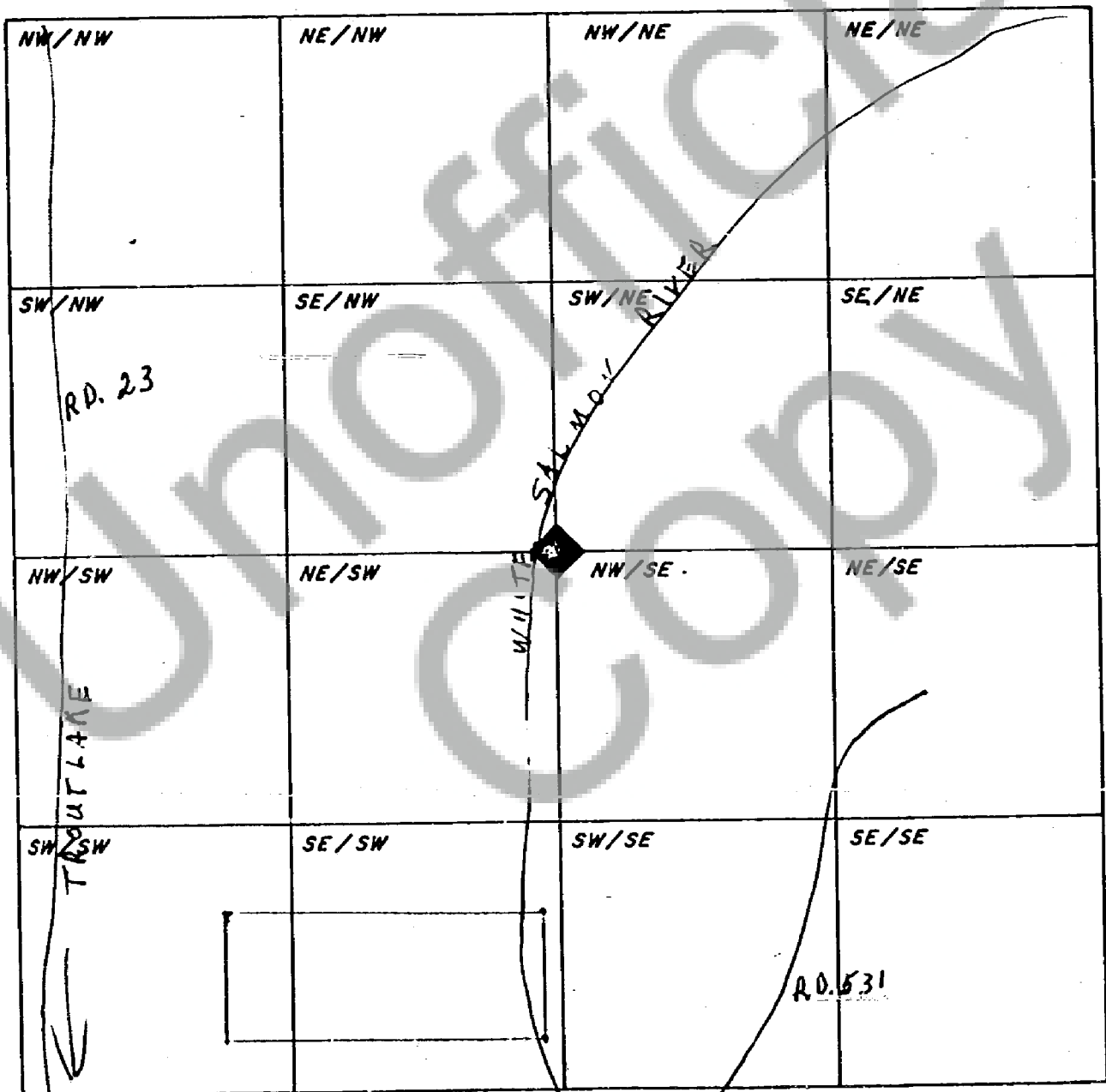

When drawing your claim(s) use an ordinary ruler. 1/8th of an inch would be 100 feet so a full size lode (600' x 1500') would be 3/4" by 1 7/8". A full size placer (1320' x 660') would be 1 5/8" by 13/16".

BRIDGE

105460

BOOK 110 PAGE 166

FORM No. 830—NOTICE OF VEIN OR LODE LOCATION—OREGON

© 1982 STEVENS NESS LAW P.C. SHING CO., PORTLAND, OREGON 97204

OL

NO. 4

SKAMANIA CO. WASH
BY LOREN D. MEYERSNotice of Mining Location
VEIN OR LODE CLAIM

NO. 5

LOCATION DISCOVERY
POST NO. 1

Jul 15 2 00 PM '88

AUDITOR
GARY M. L. SON

STATE OF OREGON,

County of SKAMANIA

SKAMANIA

Mining District

NO. 6 THIS DIAGRAM EXPLAINS METHOD OF
DESCRIPTION OF CLAIM.

NOTICE HEREBY IS GIVEN that the undersigned locators, each a citizen of the United States or one who has declared his intention to become such, have discovered a vein or lode of locatable mineral bearing rock in place upon the public domain of the United States which is open to mineral entry and location within the above state, county and mining district; and, in accordance with the laws of the United States and of the State of Oregon, have located and do hereby locate a claim upon such vein or lode by posting this notice of such discovery and location on a substantial post or monument at the point of discovery, marked Post No. 1. The name of the claim is:

LUCKY 1

Claim, further described as follows:

Commencing at a post marked No. 1 (Discovery Post), thence

100

feet in a

EASTERLY

direction to an end post marked No. 2, thence

300

feet in a

SOUTHERLY

direction to a corner post marked No. 3, thence

1500

feet in a

WESTERLY

direction to a corner post marked No. 4, thence

300

feet in a

NORTHERLY

direction to an end post marked No. 5, thence

300

feet in a

NORTHERLY

direction to a corner post marked No. 6, thence

1500

feet in a

EASTERLY

direction to a corner post marked No. 7, thence

300

feet in a

SOUTHERLY

direction to said end post marked No. 2.

The locators claim

100

direction from point of discovery to the

EAST

feet in a

EASTERLY

end line and

1400

feet in the opposite direction from point of discovery to the

WEST

end line and

300

feet on each side of the middle of said vein or lode, further claiming all the surface rights, privileges and minerals, with all dips, spurs, angles and variations, and other rights granted by existing laws and customs. This claim is further described as being 3500

feet from a natural object or permanent monument in the vicinity,

to-wit: ABOVE BRIDGE ON ROAD 531 THAT CROSSES THE

BIG WHITE SALMON RIVER THE CLAIM BEING

LOCATED 3500' UP THE RIVER

The general course or strike of the vein or lode as nearly as may be determined is

WEST

This claim is situated in the

SW 1/4

(designate quarter section) of Section

24

Township

8N Range 9E of the WILLAMET Meridian, as surveyed by the U.S. Government

or protracted if the land is unsurveyed

The end lines of the claim are parallel to each other. The adjoining claims are

This notice is placed conspicuously at discovery post No. 1; posts are placed at each corner and both center ends. The location of this claim is distinctly marked on the ground so that the boundaries of the claim may be readily traced. In construing this location notice, the singular includes the plural and vice versa, where the context so requires.

Located

7/11/

1988

Loren D. Meyers

GENERAL ACKNOWLEDGMENT

NO 201

State of WASHINGTON

County of SKAMANIA

SS.

On this the 15th day of JULY 1988, before me,

SHIRLEY ANN NEVIS

the undersigned Notary Public, personally appeared

LOREN D. MEYERS

K personally known to me

proved to me on the basis of satisfactory evidence

to be the person(s) whose name(s) IS subscribed to the

within instrument, and acknowledged that HE executed it.

WITNESS my hand and official seal.

Notary's Signature

Shirley Ann Nevis

my commission expires 5/17/91

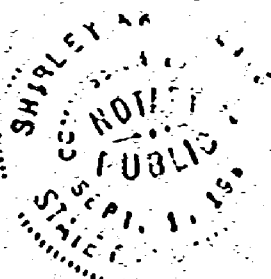

Signature of Claimant Loren D. Meffer date 7/11/88

MAP of Mining Claim(s)

Township 8 N Range 9 E Section 24 State of WASH.

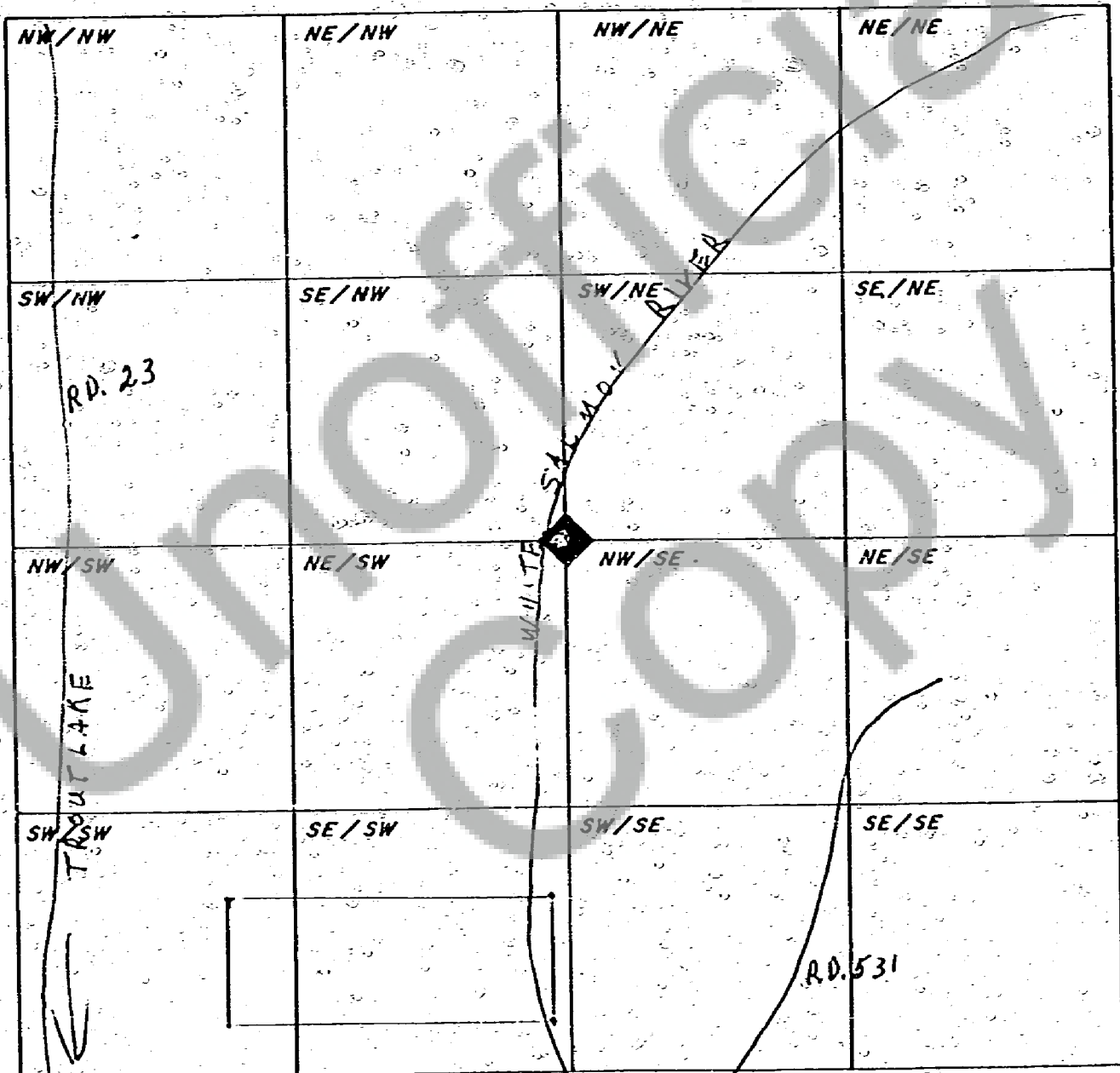

When drawing your claim(s) use an ordinary ruler. 1/8th of an inch would be 100 feet so a full size lot (600' x 1500') would be 3/4" by 1 7/8". A full size placer (1320' x 660') would be 1 5/8" by 13/16".

BRIDGE