

NOTICE OF MINING LOCATION

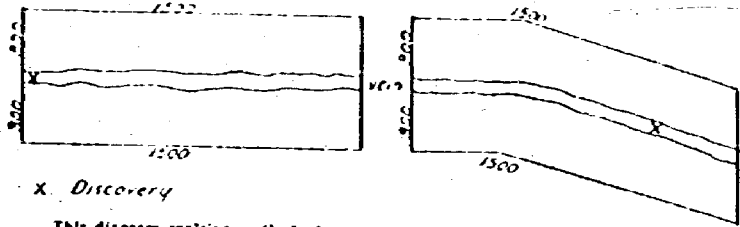

X. Discovery
This diagram explains method of description of claim.

WASHINGTON State
SKAMANIA County
(or Recording Precinct
Mining District)

NOTICE IS HEREBY GIVEN That the undersigned who ~~is~~ (has declared intention to become) citizen of the United States, has discovered and has located and claimed and do hereby locate 1500 linear feet in length, and 600 feet in width on the BRAND Lode, vein, ledge or deposit (or placer ground), situated in the above State, County (or Recording Precinct) and Mining District, and further described as follows: Commencing at a post marked No. 1 at the Discovery shaft (cut or tunnel), from thence 300 feet in a NORTH westerley direction to an end post marked No. 2, thence 1500 feet in a Westerley direction to a corner post marked No. 3, thence 600 feet in a Southerley direction to a corner post marked No. 4, thence 1500 feet in a Easterley direction to a corner post marked No. 5, thence 300 feet in a NORTH westerley direction to a corner post marked No. 6, thence _____ feet in a _____ direction to said end post No. 2; hereby locating and intending to claim _____ feet in a _____ direction from discovery to the _____ end line, and _____ feet in the opposite direction from discovery to the _____ end line and _____ feet on each side of the middle of said lode or ledge, for the purpose of mining the same and claiming all surface rights, privileges, and minerals, with all dips, spurs, angles and variations, and other rights granted by existing laws and customs.

This claim is further described by reference to natural objects or permanent monuments, as follows:

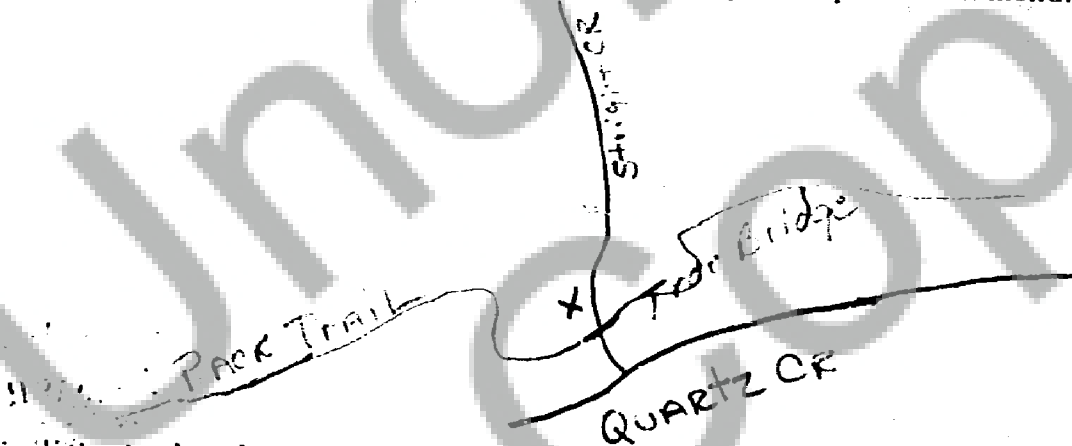

This notice is placed at Discovery on post No. 1; posts are placed at each corner, and the name of this lode, and date of location, are placed on all posts.

Located the 3 day of APRIL, 1988.

Robert Alan Bayman

16502 NE 11TH ST

VANCOUVER WA 98684

WITNESSES:

FILED FOR RECORD Locators.
SKAMANIA CO. WASH
BY ROBERT A. BAYMAN

APR 8 1 55 PM '88
d. New, Dep.
AUDITOR
GARY M. OLSON

S
S
S

STATE OF WASHINGTON

County of SKAMAWIA

ss. (Individual Acknowledgment)

I, Robert A. Baymaw, do solemnly swear that I am a citizen of the United States of America (or have declared my intention to become such) and that I am acquainted with the mining ground described in the notice of location, and herein called the LAWDI Placer Mining Claim; that the ground and claim herein described, or any part thereof, has not, to the best of my knowledge and belief, been located according to the laws of the United States and this State, or if so located, that the same has been abandoned or forfeited by reason of failure of such former locators to comply in respect thereto with the requirements of said laws; and that I have performed the equivalent of at least \$100.00 in labor on such claim and have complied with all applicable laws of this State pertaining to this claim.

Robert Alan Baymaw

Subscribed and sworn to before me this 8 day of April, 1988.

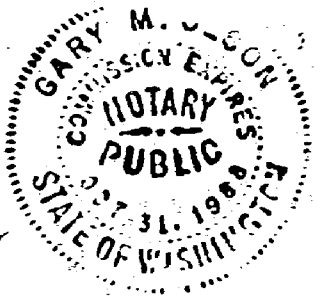

Gary M. Conroy

Notary Public in and for the State of Washington,
residing at North Boveville in said County.

UNOFFICIAL COPY