

104733

State of Washington
 DEPARTMENT OF NATURAL RESOURCES
BUREAU OF SURVEYS AND MAPS
LAND CORNER RECORD

CE 1/16
 Section 18

Skamania County

Corner Code No. L-4

T 2 N, R 5 E, W.M.

Segregated Surveys:

Name: n/a

Corner Number: n/a

1. History of Corner Establishment and Subsequent Restoration:

Set by Dorrell Germunson in his subdivision of Section 18 in 1983, recorded in Book 2, Page 114 in the Skamania County Auditor's office.

2. Description of Evidence Found:

5/8" rebar with plastic cap marked LS 10997.

FILED FOR RECORD
 SKAMANIA CO. WASH
 BY DNR

FEB 22 2 37 PM '88
 AUDITOR
 GARY H. OLSON

3. Describe Monument, Accessories and Corollary Data to Perpetuate this Corner Location. Diagram corner and indicate meridian and reference to map of record. Surveyor's Field Book No. 600.29, Page No. 15. Date of work February 4, 1988.

See reverse side for corner diagram.

Pin Pointed on Photo No. _____, Date _____, Located at _____.

SURVEYOR'S CERTIFICATE

[Seal]

This corner record correctly represents work performed by me or under my direction in compliance with the provisions of Chapter 50, Laws of 1973.
 Date: February 17, 1988.

Signature

H. Thomas Laird Jr.

21490

Certificate No.

**AUDITOR'S CERTIFICATE**

Filed for record this _____ day of _____ 19 _____ at _____ M.
 In Book _____ of _____ at page _____ at the request
 of Washington State Department of Natural Resources.

County Auditor

Indexed, Mr.

Indexed

Filed

Mailed

LAIRD
GORDON
BRESLER

600.29

2-4-88

C. E. 1/16 CORNER SEC. 18. T2N, R5E.

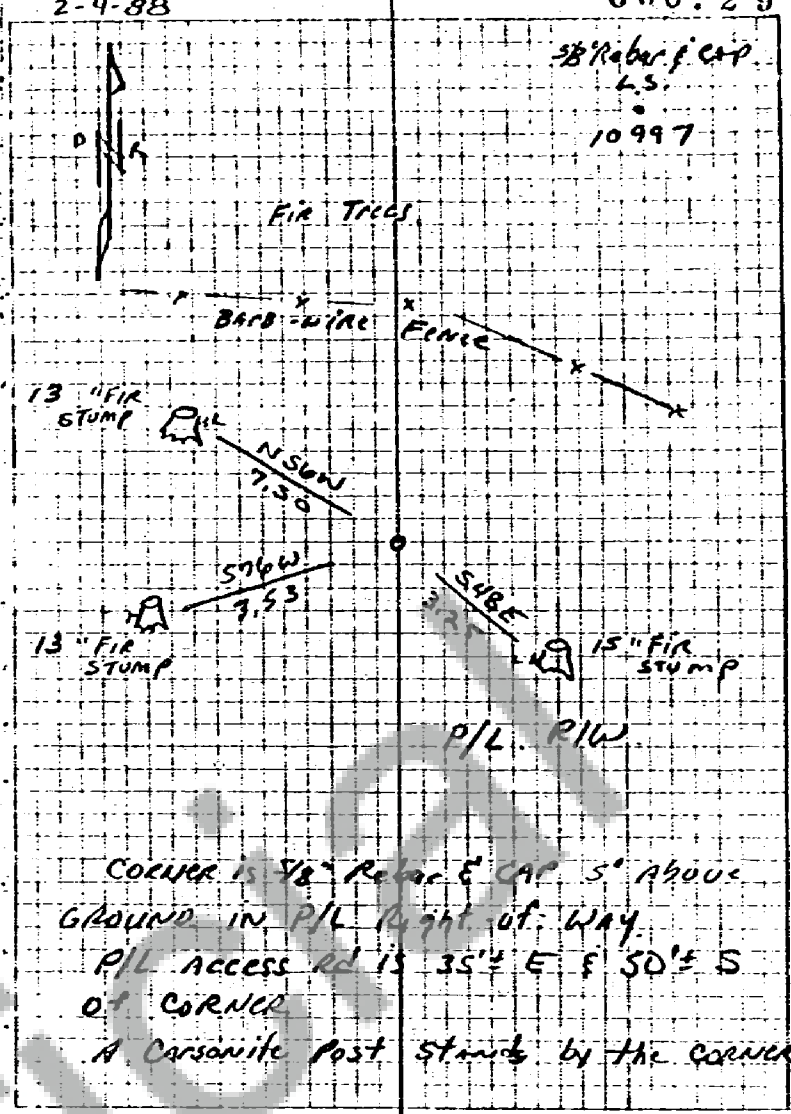

BOOK 45 PAGE 49