

104730

State of Washington
DEPARTMENT OF NATURAL RESOURCES
BUREAU OF SURVEYS AND MAPS
LAND CORNER RECORD

1/4
13 | 18

Skamania County

T 2 N, R 5 E, W.M.

Corner Code No. L-1

Segregated Surveys:
Name: n/a

Corner Number: n/a

1. History of Corner Establishment and Subsequent Restoration:

Originally established by GLO in 1857 with a post and two bearing trees. Subsequently restored with a 2" iron pipe by persons unknown.

2. Description of Evidence Found:

2" iron pipe.

1965 DNR reference tag.

FILED FOR RECORD
SKAMANIA CO. WASH
BY DNR

FEB 22 2 21 PM '88
D. News. Dep.
AUDITOR
GARY M. OLSON

3. Describe Monument, Accessories and Corollary Data to Perpetuate this Corner Location. Diagram corner and indicate meridian and reference to map of record. Surveyor's Field Book No. 600.29, Page No. 2. Date of work January 20, 1988.

Corner is a DNR aluminum cap epoxied into found pipe.

See reverse side for corner diagram.

Pin Pointed on Photo No. _____, Date _____, Located at _____.

SURVEYOR'S CERTIFICATE

[Seal]

This corner record correctly represents work performed by me or under my direction in compliance with the provisions of Chapter 50, Laws of 1973. Date: February 17, 1988.

Signature H. Thomas Laird Jr. Certificate No. 21490



AUDITOR'S CERTIFICATE

Filed for record this _____ day of _____ 19____ at _____ M.
In Book _____ of _____ at page _____ at the request
of Washington State Department of Natural Resources.

Registered S
Indexed Dir
County Auditor Dir
Filed _____
Mailed _____

1-20-88

Laird

600.2

GLO Survey
 40.00 Set post -
 12" hemlock S52E 6 Links
 4" vine maple N67W 45 Links

1/4 corner 13 1/8 T2N R 4E SE

No orig. evidence found.
 Found 2" iron pipe in fence line (E-W)
 1 1963 DNR RP

Other Surveys:
 Germanson Book 2, pg 114 Skamania Co.

Hagedorn Book 13, pg 190 Clark Co.

BPA - 1938

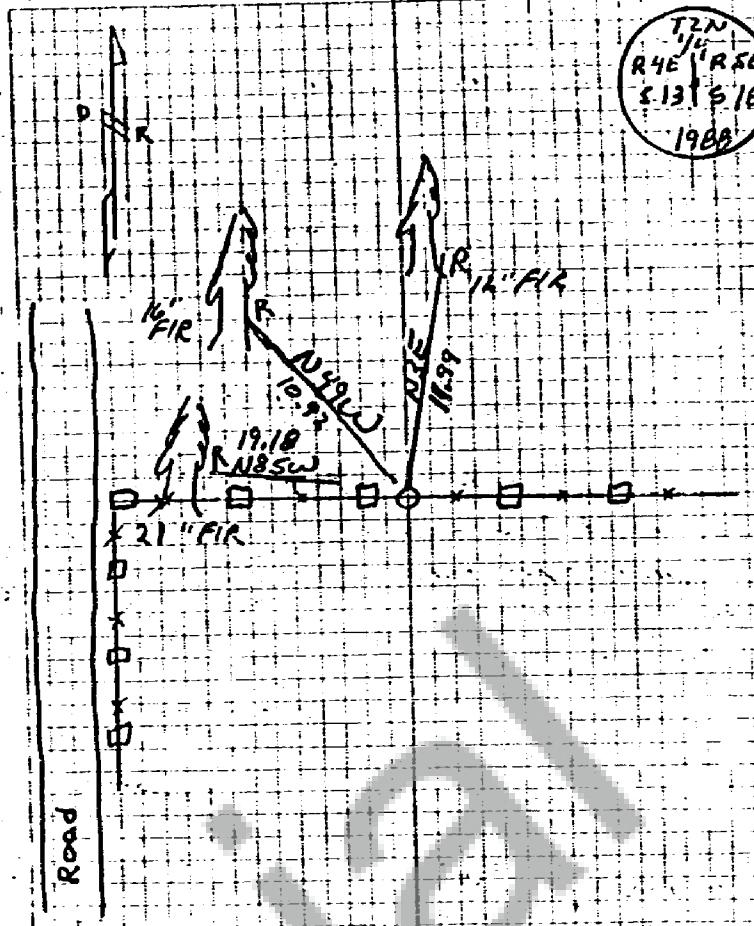

T2N
 R4E
 S13 1/8
 1988

Corner is a DNR Alu cap epoxied into
 found 2" iron pipe, 43' east of Rd E