

RES 20-1818 (N 01/84)
104729

BOOK 2/5 PAGE 40

State of Washington
DEPARTMENT OF NATURAL RESOURCES
BUREAU OF SURVEYS AND MAPS
LAND CORNER RECORD

1/4
18 | 17

Skamania County

Corner Code No. L-5

T 2 N, R 5 E, W.M.

Segregated Surveys:
Name: n/a

Corner Number: n/a

1. History of Corner Establishment and Subsequent Restoration:

Originally established by GLO in 1859 with a post and two bearing trees. Subsequently restored from one scribed bearing tree by Olson Engineering with a 1" galvanized pipe with plastic cap.

2. Description of Evidence Found:

Above-described pipe.

60" BT fir stump at N40W 18.31 feet.

FILED FOR RECORD
SKAMANIA CO. WASH
BY DNR

FEB 22 2 12 PM '88
d. New, Ap.
AUDITOR
GARY M. OLSON

3. Describe Monument, Accessories and Corollary Data to Perpetuate this Corner Location. Diagram corner and indicate meridian and reference to map of record. Surveyor's Field Book No. 600.29, Page No. 1. Date of work January 19, 1988.

See reverse side for corner diagram.

Pin Pointed on Photo No. _____, Date _____, Located at _____.

SURVEYOR'S CERTIFICATE

This corner record correctly represents work performed by me or under my direction in compliance with the provisions of Chapter 50, Laws of 1973. Date: February 17, 1988.

H. Thomas Laird Jr. 21490
Signature Certificate No.

[Seal]

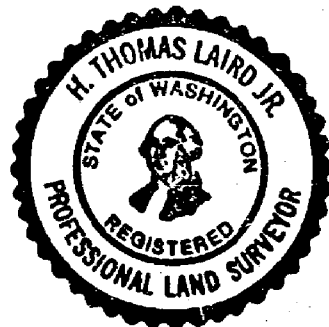

AUDITOR'S CERTIFICATE

Filed for record this _____ day of _____ 19 _____ at _____ M.
In Book _____ of _____ at page _____ at the request
of Washington State Department of Natural Resources.

Registered 5
County Auditor Indexed 5
Indirect _____
Filed _____
Mailed _____

GLO Survey of 1859
 39.43 Set post
 60" Fir N40W 28 L.
 8" Chittum SUE SOL.

1/4 corner 18 1/2 17 TAN RSE

Found 60" Fir stump BT with old
 axe marks, no scribe visible on face.

1" OD galvanized iron pipe with
 Jerry Olson's plastic cap driven into
 it.

Corner is 49' north of the northerly
 transmission wire

Other surveys:

Olson Engr. Bk 1 pg 213 Skamania Co.
 Gunnison # 2 pg 114 " "

1-19-88

Laird

600.2

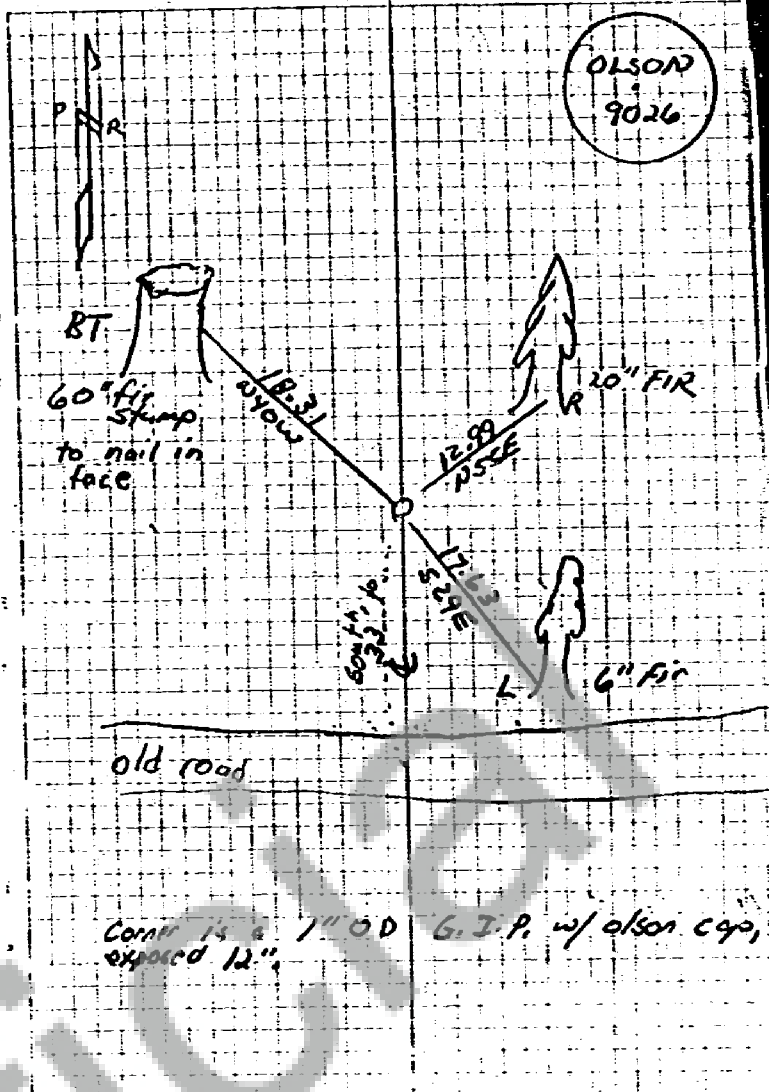

BOOK 2/5 PAGE 41