

104351

270
Page
2
Book

FILED IN RECORD
STATE OF WASH
BY BISHOP SURVEYING
Nov 24 12 27 PM '87
A. D. Bishop, Reg.
AUDITOR
GARY M. OLSON

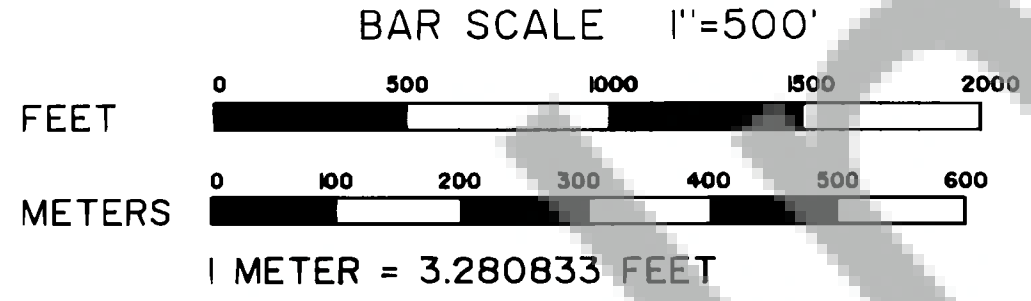
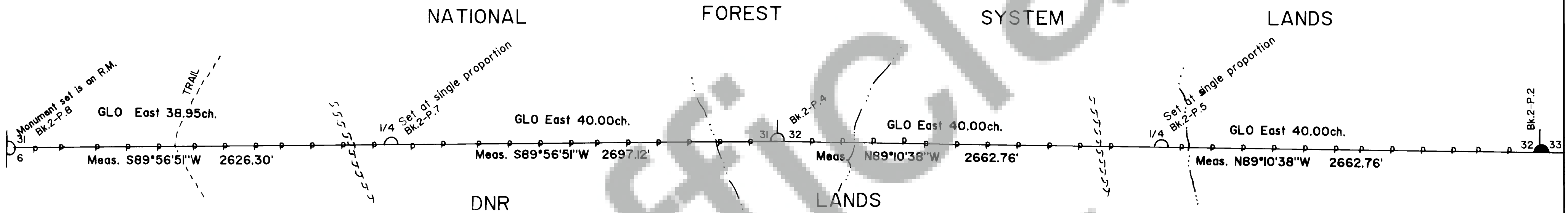

- Set 2 1/2" X 30" Aluminum pipe with a 2 1/2" Aluminum cap
- Found DNR concrete post with a brass cap
- Bearings are based on a solar observation near the corner to sections 32 & 33-hour angle method
- — — — — The lines are posted with 6' polymer posts (orange) with decal 54-2a
- Bk. 1-P. 1 Field book and page number
- Drainage
- Ridge top
- DNR Department of Natural Resources

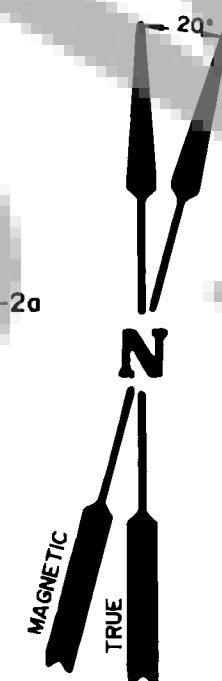

HISTORY OF SURVEYS
These lines were originally surveyed by Deputy Robert F. Whitham in 1903 under Contract No. 600. The corner to sections 32 & 33 was monumented by the State of Washington Department of Natural Resources in 1969.

SURVEYOR'S CERTIFICATE
THIS MAP CORRECTLY REPRESENTS A SURVEY MADE BY ME AND MY ASSISTANT IN CONFORMANCE WITH THE REQUIREMENTS OF THE SURVEYING ACT AT THE REQUEST OF U.S.D.A. Forest Service IN SHAMANIA CO.

CERTIFICATE
I, Larry D. Bishop a Registered Land Surveyor in the State of Washington hereby certify that this plat and the notes hereon are a correct representation of a survey I performed during July 1986-June/Sept. 1987 at the request of the U.S.D.A. Forest Service in accordance with the statutes of the State of Wash. and the articles of my contract.

Larry D. Bishop
Registered Land Surveyor No. 16337



AUDITOR'S CERTIFICATE
FILED IN RECORD
STATE OF WASH
BY BISHOP SURVEYING
Nov 24 12 27 PM '87
A. D. Bishop, Reg.
AUDITOR
GARY M. OLSON

PLAT OF SURVEY
ATLANTIS CADASTRAL SURVEY
U.S.D.A. FOREST SERVICE, REGION 6
GIFFORD PINCHOT NATIONAL FOREST
Contract No. 40-05K3-6-884
South lines of sections 31 & 32
T. 4 N., R. 7 E., W.M.
SKAMANIA COUNTY, WASHINGTON

BISHOP SURVEYING, INC..
P.O. Box 729, Hood River, Or.
(503) 386-5122
Date: SEPT. 21, 1987
PROJECT NO. 86010