

102267

State of Washington
DEPARTMENT OF NATURAL RESOURCES
BUREAU OF SURVEYS AND MAPS
LAND CORNER RECORD

$$\frac{1/4}{33/4}$$

Skamania County

T 5 N, R 5 E, W.M.

Corner Code No. A-11

Segregated Surveys:

Name: n/a

Corner Number: n/a

1. History of Corner Establishment and Subsequent Restoration:

Originally established in 1909 by GLO surveyor C. Frank Rhodes with a marked stone and 1 dead BT and 1 live BT.

No subsequent restoration found.

2. Description of Evidence Found:

Original stone marked 1/4 (closed four).
26" BT stub at N81E 56 feet.
30" BT stub S45E 26.4 feet.
36" fir line tree at west, 265 feet.
36" fir line tree at west, 392 feet.

FILED FOR RECORD
SKAMANIA CO. WASH
BY

DEC 1 12 PM '86

AUDITOR
GARY M. OLSON

3. Describe Monument, Accessories and Corollary Data to Perpetuate this Corner Location.
Diagram corner and indicate meridian and reference to map of record. Surveyor's Field Book No. 601.07, Page No. 52. Date of work June 25, 1986.

Replaced original stone with DNR aluminum monument with stamped cap.

See reverse side for corner diagram.

SURVEYOR'S CERTIFICATE

[Seal]

This corner record correctly represents work performed by me or under my direction in compliance with the provisions of Chapter 50, Laws of 1973.
Date: November 18, 1986.

Signature

21490
Certificate No.



AUDITOR'S CERTIFICATE

Filed for record this _____ day of _____ 19 _____ at _____ M.
In Book _____ of _____ at page _____ at the request
of Washington State Department of Natural Resources.

Registered S
Indexed S
Indexed
Filed
Indexed

County Auditor

5-5 SURV. OF 1909 Rhodes
 45.00 Set sandstone, 14x9x9 w. 14
 1/4 marks on north face
 24" dead fir N79 1/2° E 85 L 56.1'
 26" pine S47 E 40 L 26.4'

1/4 corner $\frac{33}{4}$ T S 60° R 5 E

FOUND 16x7x6" STONE 20, 1/4
 ON NORTH FACE
 SET STUB 36" DIA 25' TALL N 81 E
 26 FT. NO SCRIBE
 SET STUB 30" DIA 10' TALL N 45 E
 26.1 FT. NO SCRIBE
 36" D. FIR LINE TREE 26.5' WEST
 IS NOW A STUB 25' HIGH
 36" D. FIR LINE TREE 39.2' WEST
 IS NOW A STUB 10' HIGH

52

6-25-86 Gordon MacPherson

76.1
 53.2
 54
 128.3

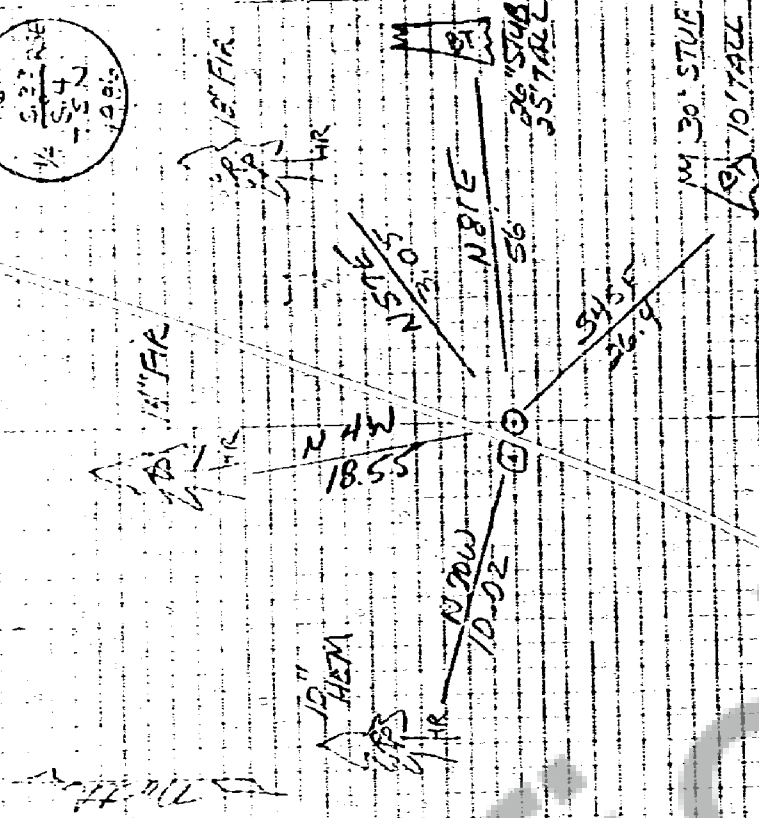

SET STUB D.I.R. ALUM. MON. CAP WITH
 CAP 5\"/>

102267

State of Washington
DEPARTMENT OF NATURAL RESOURCES
BUREAU OF SURVEYS AND MAPS
LAND CORNER RECORD

$$\frac{1}{4}$$

$$\frac{33}{4}$$

Skamania County

Corner Code No. A-11

T 5 N, R 5 E, W.M.
Segregated Surveys:
Name: n/a

Corner Number: n/a

1. History of Corner Establishment and Subsequent Restoration:

Originally established in 1909 by GLO surveyor C. Frank Rhodes with a marked stone and 1 dead BT and 1 live BT.

No subsequent restoration found.

2. Description of Evidence Found:

Original stone marked 1/4 (closed four).

26" BT stub at N81E 56 feet.

30" BT stub S45E 26.4 feet.

36" fir line tree at west, 265 feet.

36" fir line tree at west, 392 feet.

FILED FOR RECORD
SKAMANIA CO. WASH
BY TIM LAIRD

Dec 1 12 PM '86

AUDITOR
GARY M. OLSON

3. Describe Monument, Accessories and Corollary Data to Perpetuate this Corner Location. Diagram corner and indicate meridian and reference to map of record. Surveyor's Field Book No. 601.07, Page No. 52. Date of work June 25, 1986.

Replaced original stone with DNR aluminum monument with stamped cap.

See reverse side for corner diagram.

SURVEYOR'S CERTIFICATE

[Seal]

This corner record correctly represents work performed by me or under my direction in compliance with the provisions of Chapter 50, Laws of 1973.
Date: November 18, 1986.

Signature

H. Thomas Laird Jr.

21490
Certificate No.

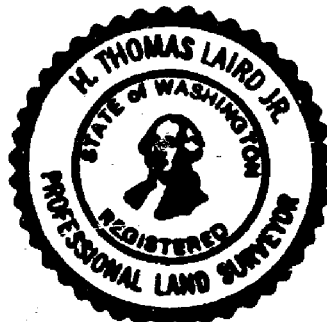

AUDITOR'S CERTIFICATE

Filed for record this _____ day of _____ 19____ at _____ M.
In Book _____ of _____ at page _____ at the request
of Washington State Department of Natural Resources.

Registered S
Indexed S
Indexed
Filed
Mailed

County Auditor