

4-5-80

Notice of Location of Placer Claim

Notice is hereby given that the undersigned, who ~~is a~~ ~~are for ha~~ declared ~~intention~~
~~to become~~ citizen of the United States, has on this 20 day of June
1985 discovered at the place where this notice is posted a valuable placer deposit bearing
Gold, Platinum and other valuable
 minerals, and does hereby locate and claim same as the Kathy Lee
 Placer Mining Claim.

This claim is situated in the Skamania County
 Mining District, Section 30, in Township 4N
 Range 5E.

The point of discovery whereon this notice is posted is situated in the
SE 1/4 NE 1/4 SW 1/4 of Sec. 30, T4N.
Range 5E, of the Willamette Meridian

and from thence the boundaries of said claim are marked and described as follows:

330' from the center line of Copper Creek on
 Both Sides (North & South), Extending 1,320' in the
 downstream direction, starting at the Steel
 Bridge. ~~at the~~ ~~the~~ ~~the~~ (Located upstream from the
 point of this notice)



Notice dated and posted on the day aforesaid.

Discovered June 20 1985
 Located June 20 1985

Locator Anthony P. Migas
Anthony P. Migas

Notice of location must be recorded within thirty days from the date of discovery at the office of the auditor of the county in which such discovery was made. Twenty Acres may be included in one placer claim and if located on surveyed land it must be according to legal subdivisions.

Care must be taken to fully describe the claim with reference to natural objects and permanent monuments or survey description, so that the boundaries can be readily traced. The blank spaces in this form must be carefully and properly filled out.

The discoverer must perform labor upon such location in developing the same to an amount which shall be equivalent in the aggregate to at least \$10.00 worth of such labor for each twenty acres, or fractional part thereof, contained in such location or claim, within sixty days from the date of discovery, and upon performance of such labor, file with the auditor of county an affidavit showing such performance and generally the nature and kind of work so done. Provided however, that certain federal regulations may apply, in addition or in place of the above.

STATE OF WASHINGTON
County of CLARK } ss.

(Individual Acknowledgment)

I, Anthony P. Migas, do solemnly swear that I am a citizen of the United States of America (or have declared my intention to become such) and that I am acquainted with the mining ground described in the notice of location, and herein called the Ruthy Lee Placer Mining Claim; that the ground and claim herein described, or any part thereof, has not, to the best of my knowledge and belief, been located according to the laws of the United States and this State, or if so located, that the same has been abandoned or forfeited by reason of failure of such former locators to comply in respect thereto with the requirements of said laws; and that I have performed the equivalent of at least \$10,000 in labor on such claim and have complied with all applicable laws of this State pertaining to this claim.

Anthony P. Migas

Subscribed and sworn to before me this 25th day of JUNE, 1985.

Loren B. White

Notary Public in and for the State of WASHINGTON
residing at VANCOUVER in said County.

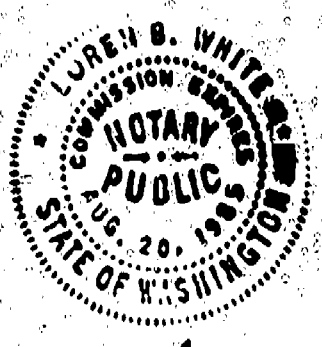

OF WASHINGTON } ss.
I HEREBY CERTIFY THAT THE WITHIN

INSTRUMENT OF WRITING FILED BY

Anthony P. Migas 2195 E 156 Ave Seattle 104 98108

AT 10:55 7-5 85

RECORDED 103

BY Harry M. Alcorn

E. McFarland CLERK

99499

BOOK P PAGE 105

Signature of Claimant _____ date _____

MAP of Mining Claim(s)

Township 4N Range 5 Section 7 State of WV

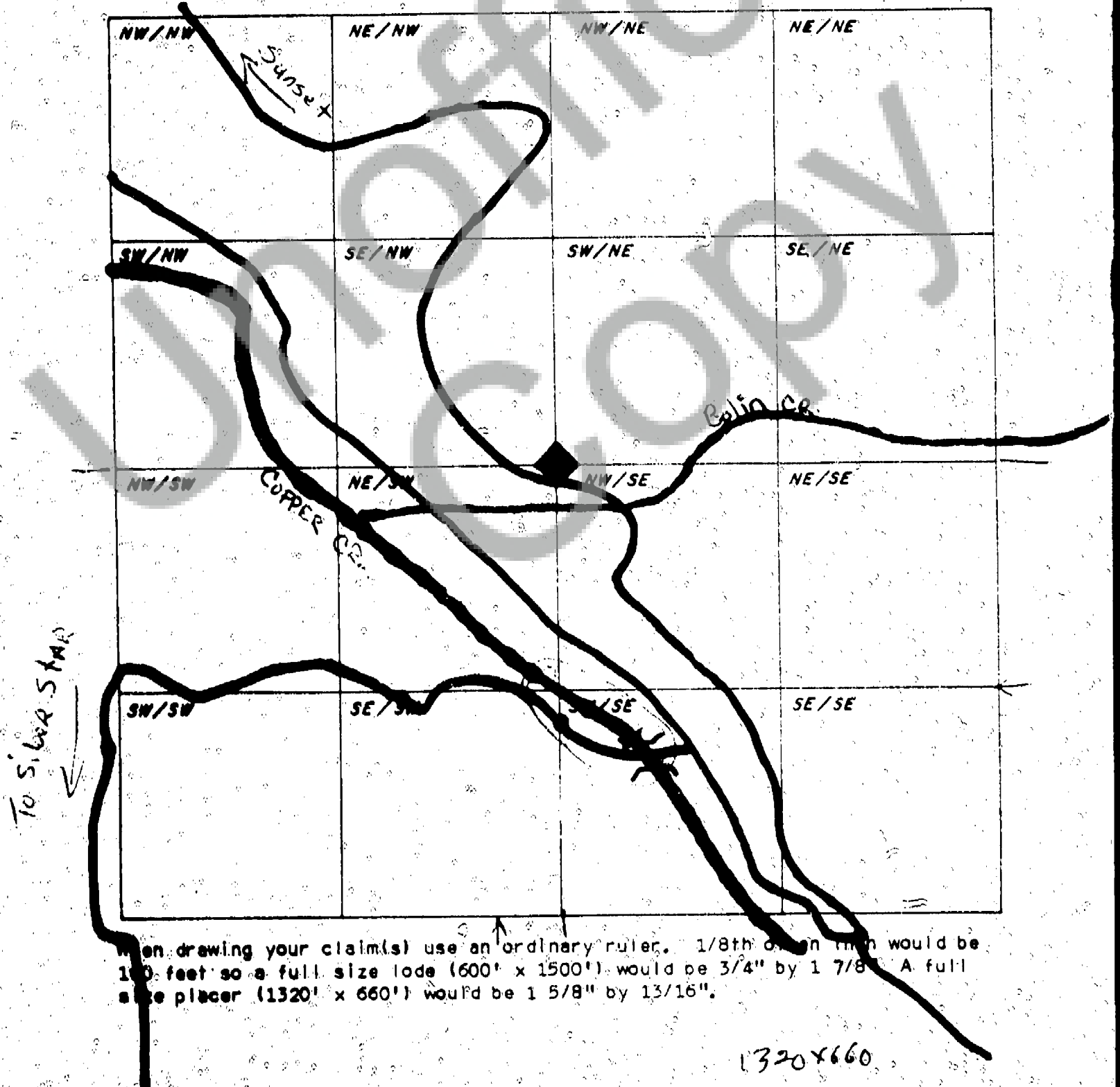

1320x660