

2-5-1910
3-7-12-800
3-8-1200

EASEMENT SUPPLEMENT

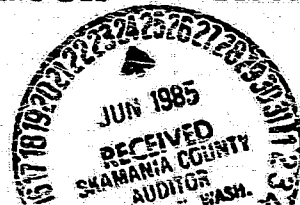

THIS SUPPLEMENTAL AGREEMENT, made and entered into this 12th day of June, 1985, by and between S.D.S. COMPANY, of Bingen, Washington, and LONGVIEW FIBRE COMPANY, a Delaware corporation, herein called "S.D.S.," and "Longview," and STATE OF WASHINGTON, acting by and through the Department of Natural Resources, herein called "State," WITNESSETH:

Whereas, on the 7th day of November, 1984, S.D.S., Longview, and the State entered into an easement exchange, hereinafter called Original Easement, which was recorded in the records of Skamania County, Washington, on the 20th day of November, 1984, in Volume 84 of Deeds, pages 98-127 under Auditor's File No. 98520, and in the records of Klickitat County, Washington, on the 10th day of December, 1984, in Volume 229 of Deeds, pages 67-96 under Auditor's File No. 196474, and in the records of Clark County, Washington, on the 27th day of December, 1984, on pages 163-192 under Auditor's File No. 8412270113. Said Original Easement is hereby supplemented as follows:

I

- A. S.D.S., for and in consideration of similar grants hereby grants and conveys to State, its successors and assigns, a permanent easement upon, over, and along rights of way sixty (60) feet in width, over and across the lands in Klickitat County, Washington, described on the attached "Exhibit A-1," being thirty (30) feet on each side of the centerlines of a road or roads located approximately as shown in lavender on the attached "Exhibits 8-3, 4, 5, 7 and 9."

Subject as to said lands to all matters of public record.

- B. Longview, for and in consideration of similar grants hereby grants and conveys to State, its successors and assigns, a permanent easement upon, over, and along rights of way sixty (60) feet in width, over and across the lands in Klickitat County, Washington, described on the attached "Exhibit A-2," being thirty (30) feet on each side of the centerlines of a road or roads located approximately as shown in blue on the attached "Exhibit B-4."

Subject as to said lands to all matters of public record.

- C. Longview, for and in consideration of similar grants hereby grants and conveys to State, its successors and assigns, a permanent easement upon, over, and along rights of way sixty (60) feet in width, over and across the lands in Klickitat County, Washington, described on the attached "Exhibit A-2," being thirty (30) feet on each side of the centerlines of a road or roads located approximately as shown in yellow on the attached "Exhibits B-4, 7 and 8."

Subject as to said lands to all matters of public record.

- D. State, for and in consideration of similar grants hereby grants and conveys to S.D.S., its successors and assigns, a permanent easement upon, over, and along rights of way sixty (60) feet in width over and across the lands in Klickitat County, Washington, described on the attached "Exhibit A-3," being thirty (30) feet on each side of the centerlines of a road or roads located approximately as shown in green on the attached "Exhibits B-4, 5, 6, 7 and 8."

Subject as to said lands to all matters of public record.

- E. State, for and in consideration of similar grants hereby grants and conveys to Longview, its successors and assigns, a permanent easement upon, over, and along rights of way sixty (60) feet in width over and across the lands in Skamania and Klickitat Counties, Washington, described on the attached "Exhibit A-3," being thirty (30) feet on each side of the centerlines of a road or roads located approximately as shown in orange on the attached "Exhibits B-1, 2 and 5."

Subject as to said lands to all matters of public record.

Except as herein supplemented all of the terms, conditions and reservations of the Original Easement shall remain in full force and effect.

Registered	S
Indexed	S
Indirect	S
Filmed	
Mailed	X

IN WITNESS WHEREOF, the parties hereto have executed this instrument, in duplicate, to become effective as of the day and year first above written.

S.D.S. COMPANY

By John Z. Cleary

LONGVIEW FIBRE COMPANY

By W. Lee Robinson Title
VICE PRESIDENT-TIMBER

Attest Barbara J. Dwyer Title



Affix Seal of Corporation

STATE OF WASHINGTON
DEPARTMENT OF NATURAL RESOURCES

Brian J. Doyle
Commissioner of Public Lands

Affix Seal of Commissioner
of Public Lands

Easement No. 2085
400505

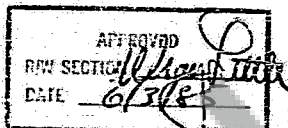

STATE OF Washington }
County of Cowlitz } ss

On this 21st day of May, 1985, before me personally appeared
W. Lee Robinson and
S. D. Mc Dermott, to me known to be the
V.P. - Timber and Secretary
respectively, of Longview Fibre Company, the
corporation that executed the within and foregoing instrument, and acknowledged said
instrument to be the free and voluntary act and deed of said corporation, for the uses and
purposes therein mentioned, and on oath stated that they were authorized to execute said
instrument and that the seal affixed is the corporate seal of said corporation.

IN WITNESS WHEREOF, I have hereunto set my hand and affixed my official seal the day
and year first above written.



Michael M. Dwyer
Notary Public in and for the State of
Washington, residing at Bellevue

STATE OF WASHINGTON)
 County of Spokane) ss

On this 28th day of May, in the year 1985, before me personally appeared John K. Cherry, known to me to be one of the partners in the partnership of SDS Company

(Name of Partnership)

and the partner or one of the partners who subscribed said partnership name to the foregoing instrument, and acknowledged to me that he executed the same in said partnership name.

John K. Cherry
 Signature
Partner
 Title

Anthony M. [Signature]
 Notary Public in and for the State of
 Washington, residing at 1111 [Address]

STATE OF WASHINGTON)
 COUNTY OF THURSTON) ss

On this 12th day of June, 1985, before me personally appeared BRIAN J. BOYLE, to me known to be the Commissioner of Public Lands, and ex officio administrator of the Department of Natural Resources of the State of Washington, the Department that executed the within and foregoing instrument on behalf of the State of Washington, and acknowledged said instrument to be the free and voluntary act and deed of the State of Washington for the uses and purposes therein mentioned, and on oath stated that he was authorized to execute said instrument and that the seal affixed is the official seal of the Commissioner of Public Lands for the State of Washington.

IN WITNESS WHEREOF, I have hereunto set my hand and seal the day and year set forth above.

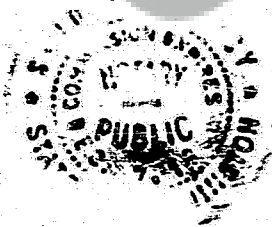

Sandra S. Garry
 Notary Public in and for the State of
 Washington, residing at Olympia.

STATE OF WASHINGTON)
 COUNTY OF SKAMAHIA) ss

I HEREBY CERTIFY THAT THE WITHIN

INSTRUMENT OF WRITING FILED BY

DEPARTMENT OF NATURAL RESOURCES
OF OLYMPIA, WA 98504

AT 2:30 P.M. JUNE 24, 1985

WAS RECORDED IN BOOK 84

DEED AT PAGE 656

RECORDS OF SKAMAHIA COUNTY WITH

Jim Olson
 COUNTY AUDITOR
[Signature] DEPUTY

EXHIBIT A 1

S.D.S. LANDS

A. S.D.S. Grants to State

<u>Section</u>	<u>Township</u>	<u>Range</u>	<u>Subdivision</u>
1	4N	10E	Government Lot 3, SE $\frac{1}{4}$ NW $\frac{1}{4}$
11	4N	10E	Part E $\frac{1}{2}$ SW $\frac{1}{4}$
30	4N	11E	S $\frac{1}{2}$ SE $\frac{1}{4}$
5	4N	12E	SW $\frac{1}{4}$ SE $\frac{1}{4}$
6	4N	12E	NE $\frac{1}{4}$ SE $\frac{1}{4}$
25	4N	12E	E $\frac{1}{2}$ NE $\frac{1}{4}$
30	4N	13E	Government Lot 2
34	5N	11E	SW $\frac{1}{4}$ SW $\frac{1}{4}$
8	6N	10E	NE $\frac{1}{4}$ SE $\frac{1}{4}$

EXHIBIT A 2

LONGVIEW LANDS

B. Longview Grants to S.D.S.

<u>Section</u>	<u>Township</u>	<u>Range</u>	<u>Subdivision</u>
8	4N	11E	S1/2NW1/4, N1/2SW1/4

C. Longview Grants to State

<u>Section</u>	<u>Township</u>	<u>Range</u>	<u>Subdivision</u>
8	4N	11E	S1/2NW1/4, N1/2SW1/4
28	4N	11E	W1/2NE1/4
35	5N	11E	SW1/4NE1/4
8	5N	12E	NE1/4SE1/4

EXHIBIT A 3

STATE LANDS

D. State Grants to S.D.S.

<u>Section</u>	<u>Township</u>	<u>Range</u>	<u>Subdivision</u>
28	4N	11E	NW1/4SW1/4
29	4N	12E	NE1/4NE1/4
11	5N	10E	NE1/4NE1/4
25	5N	11E	E1/2SE1/4
31	5N	11E	NE1/4
33	5N	11E	E1/2SE1/4
35	5N	11E	SW1/4SE1/4
36	5N	11E	SW1/4SW1/4
30	5N	12E	SW1/4NE1/4

E. State Grants to Longview

	<u>Section</u>	<u>Township</u>	<u>Range</u>	<u>Subdivision</u>
2-5-1900	21	2N	5E	W1/2NW1/4
3-7 1/2 - 800	24	3N	7 1/2E	SE1/4NE1/4
3-8 - 1230	19	3N	8E	Government Lot 2
	29	4N	12E	NE1/4NE1/4

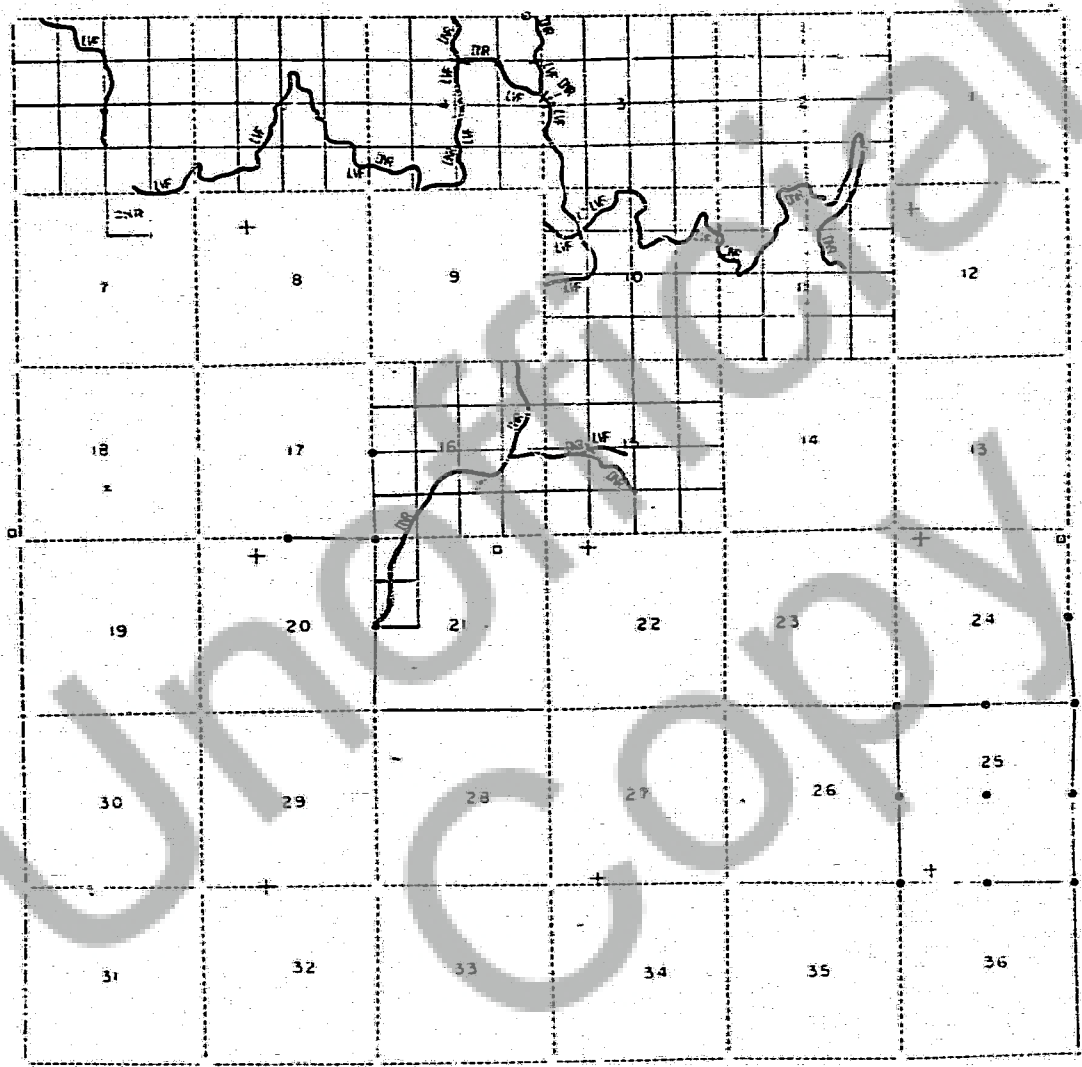

SCALE 1" = 1 MILE
LEGEND
LVP - LONGVIEW PAPER COMPANY
LNF - LONGVIEW FIBRE COMPANY
LNR - DEPARTMENT OF NATURAL RESOURCES

T2N R5E

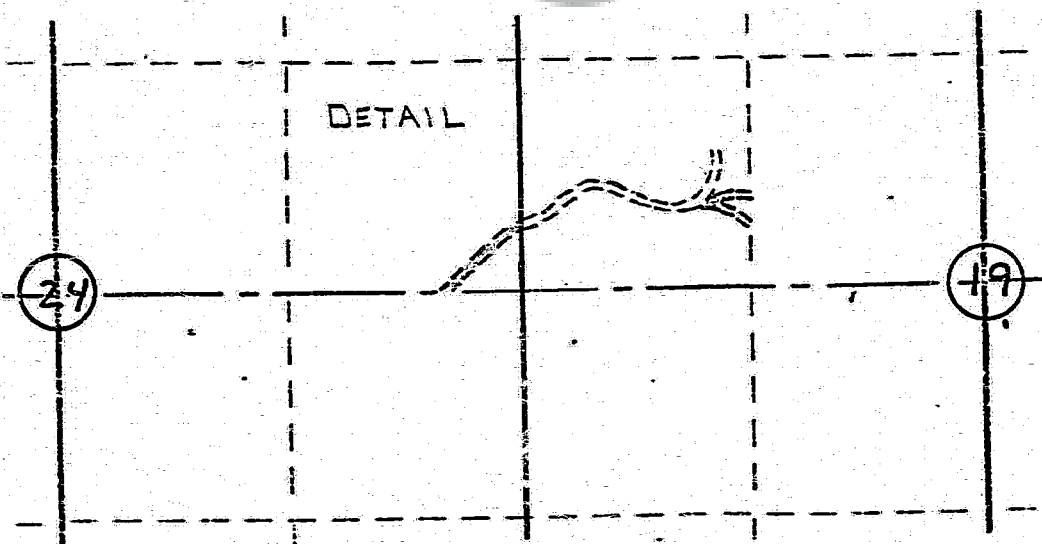
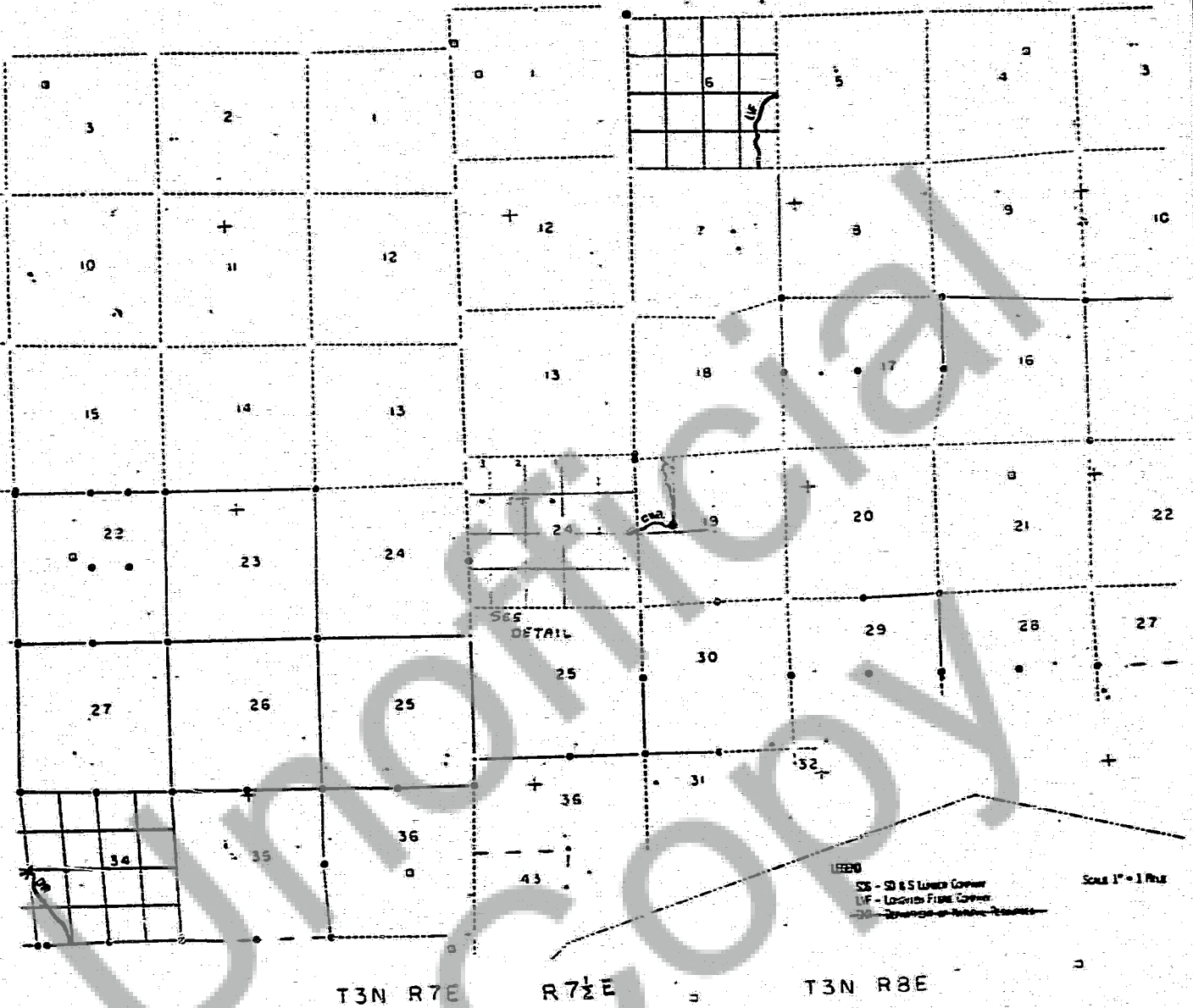





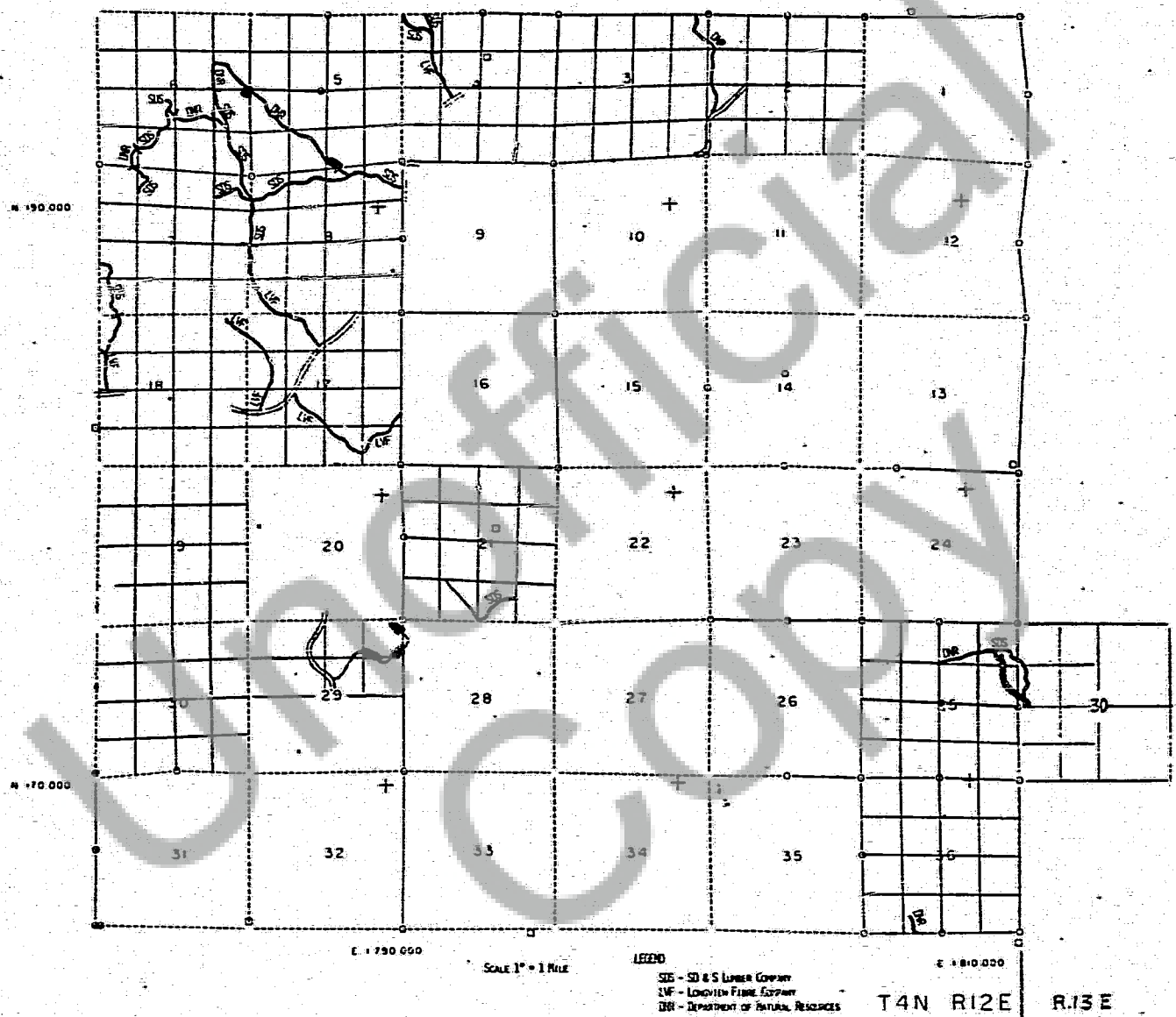

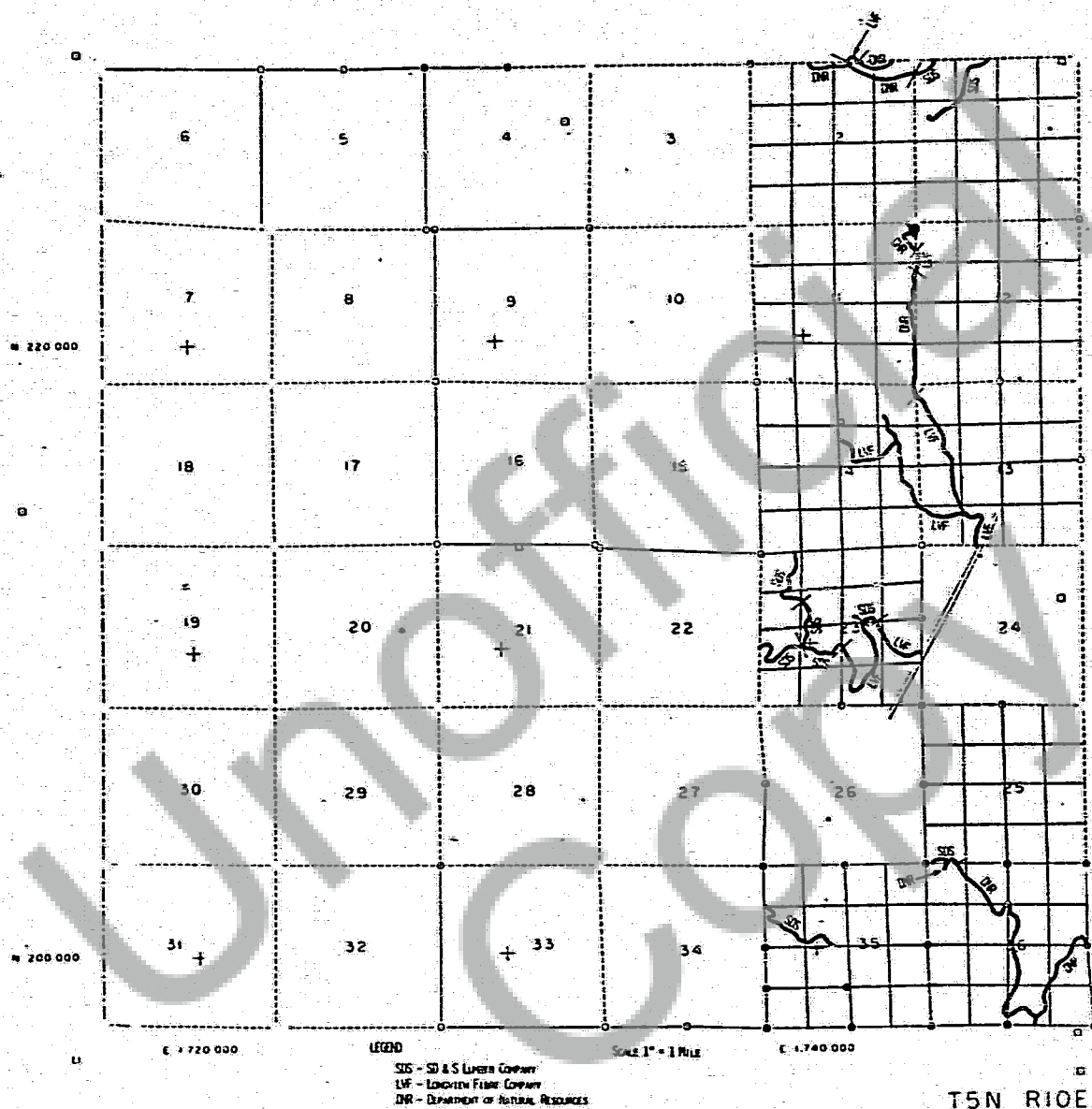

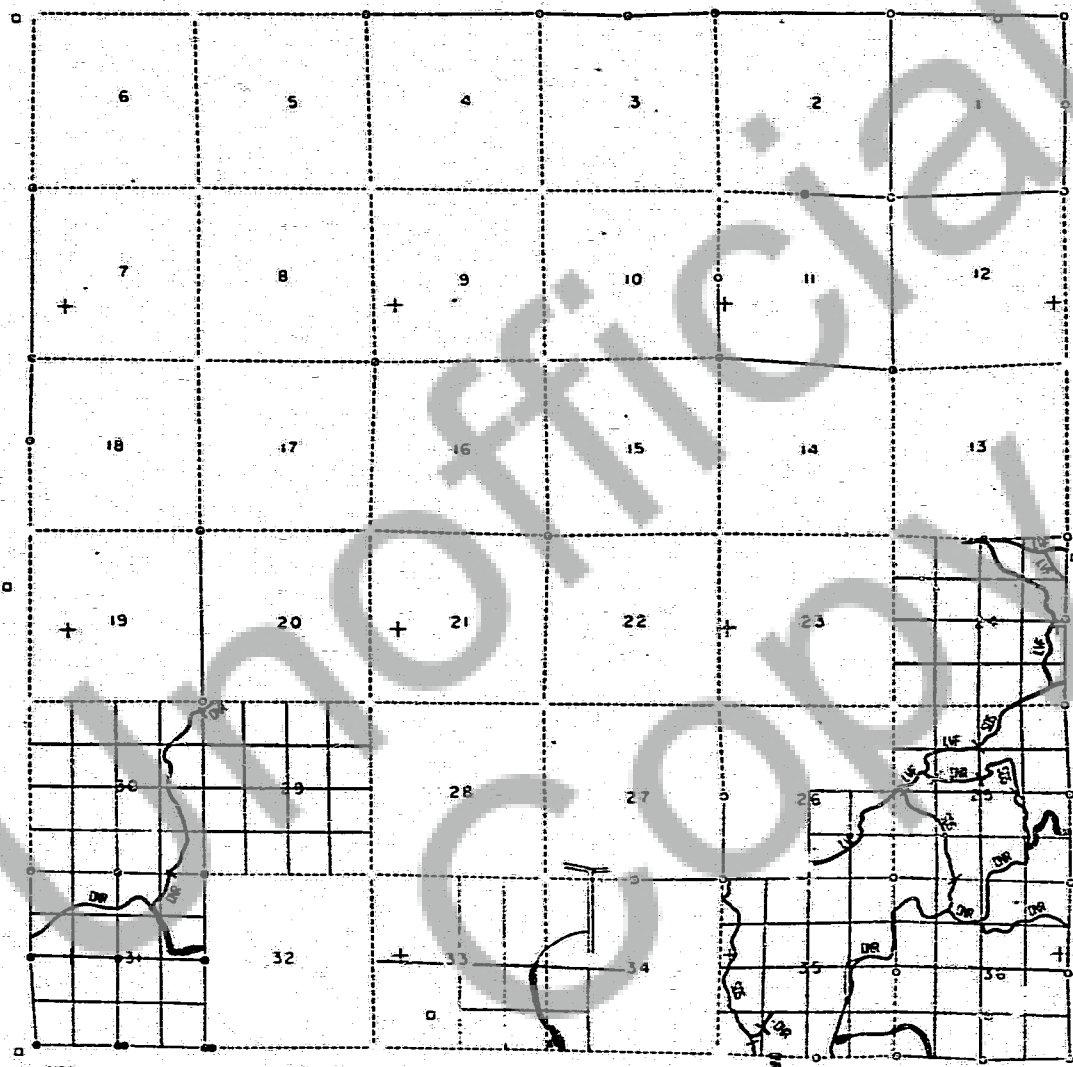

T5N R11E

TAB 4-2

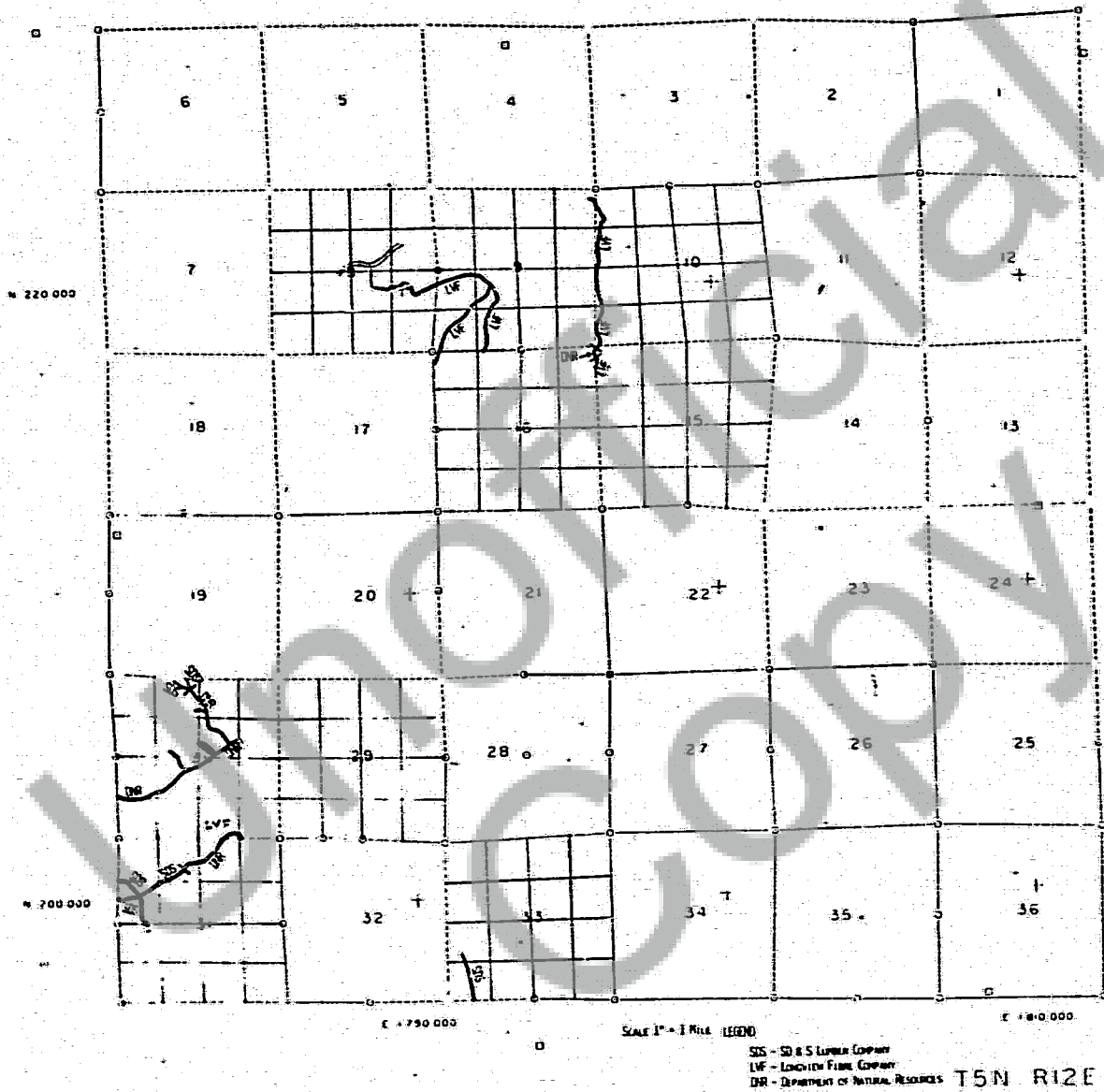

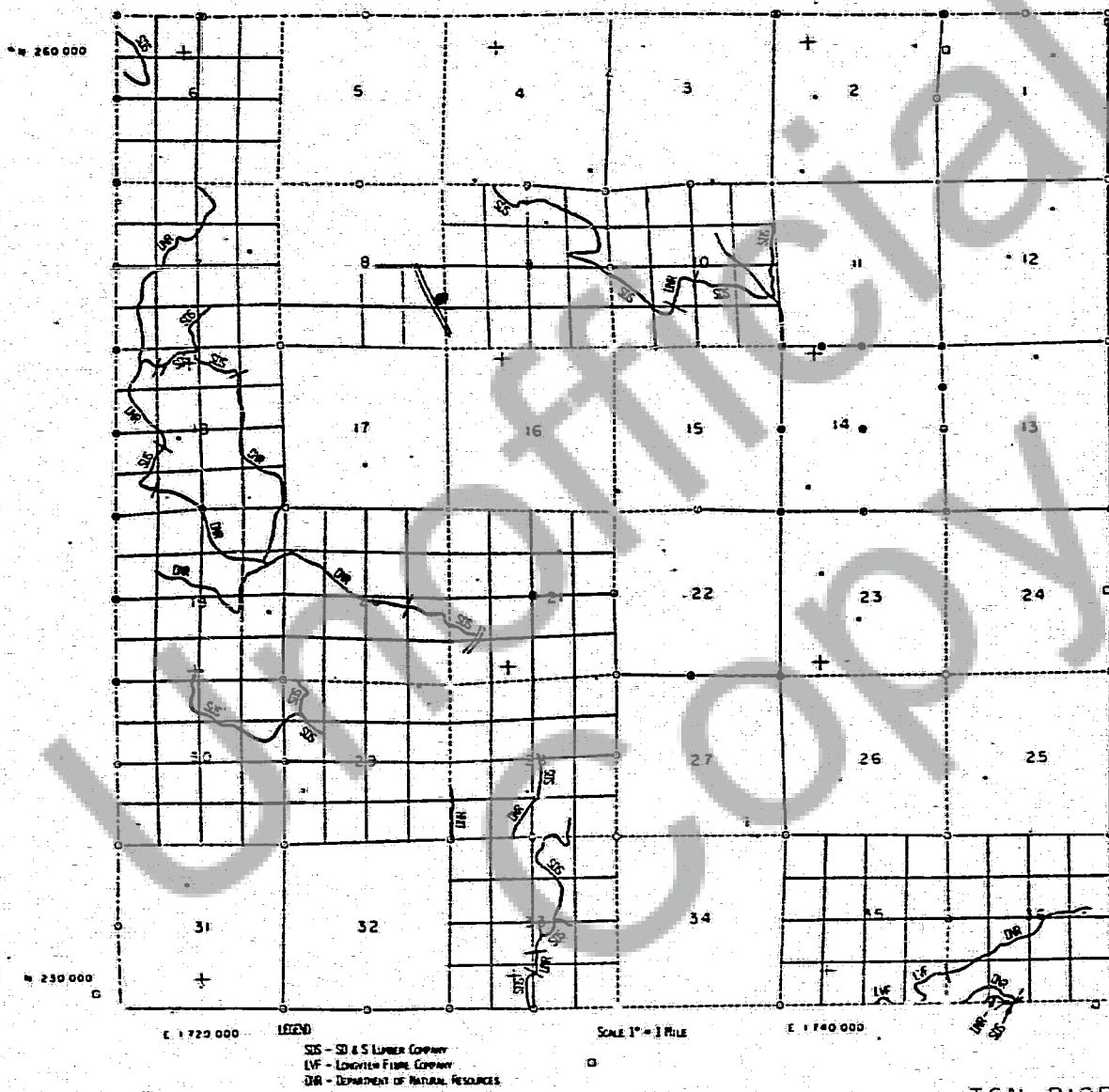

T6N R10E