



WEYERHAEUSER COMPANY  
LONGVIEW AREA

LAND CORNER RECORD

SKAMANIA

County

Corner Code No.

119  
130

R-1

T 10 N. R 5E W.M.  
Segregated Surveys:

Name:

Corner No. ....  
DLC, HES, Tract, Mining Claim, Indian Allotment, Federal Reserve, Townsite.

1. History of Corner Establishment and Subsequent Restoration: GLO. CORNER FOUND BY MAPPING CREW IN 1940. W/ REET 2 1/2" ALUMINUM MAGNETIZED PIPE WITH CAP FROM BT AT RECORD BEARING AND DISTANCE.

2. Description of Evidence Found:

34" HEMLOCK STP N20E 61.38 Visible Scribe "BT" DISTANCE TO CENTER  
GLO 24" HEMLOCK N20E 93.85 61.38

3. Describe Monument, Accessories and Corollary Data to Perpetuate this Corner Location. Diagram corner and indicate meridian and reference to map of record. Surveyor's Field Book No. 1-84 Page No. 5 Date of work 8-29-84

- REFERENCE PLATE
- USFS SIGN SA-9
- 4x2 1/4 GALVANIZED NAIL

SEE SURVEY  
Vol 2 Page 173

26" PINE STUB  
6' HIGH

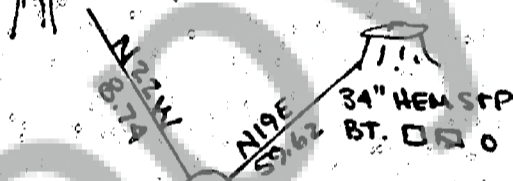

2 1/2" ALUMINUM  
PIPE - CAP

30" FIR STUB  
8' HIGH

MAGNETIC

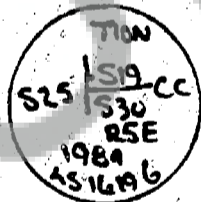

CAP AS STAMPED

Washington Plane Coordinates: ..... Zone, Y, X  
Order Accuracy. Derived From: .....

Pin Pointed on Photo No. .... Date ..... Located at .....

SURVEYOR'S CERTIFICATE

This corner record correctly represents work performed by me or under my direction in compliance with the provisions of Chapter 50, Laws of 1973. Date 1-25-85

Signature: *Dennis S. Carpenter*

Certificate No. LS16196



AUDITOR'S CERTIFICATE

Filed for record this 29th day of MARCH 1985 at 11:00 AM. In Book 10/5 of MONUMENTS at page 55 at the request of

WEYERHAEUSER COMPANY, LONGVIEW

Signature: *William J. D. New, Dep*  
County Auditor