

## NOTICE OF MINING LOCATION

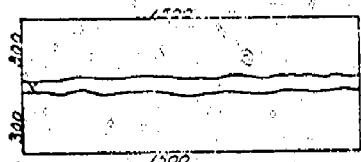

x Discovery

This diagram explains method of description of claim.

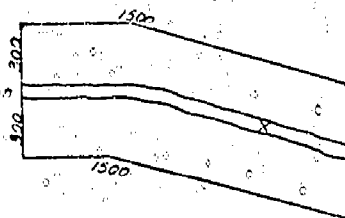

Washington State  
 SKAMANIA County  
 GIFFORD PIKEHOT (or Recording Precinct)  
 National Forest Mining District

NOTICE IS HEREBY GIVEN That the undersigned who ~~is~~ are (has declared ~~his~~ intention to become) citizen of the United States, has discovered and has located and claimed and do hereby locate 1500 linear feet in length, and 100 feet in width on the

x FRY CLAIM #1 Lode, vein, ledge or deposit (or placer ground), situated in the above State, County (or Recording Precinct) and Mining District, and further described as follows: Commencing at a post marked No. 1 at the Discovery shaft (cut or tunnel), from thence \_\_\_\_\_ feet in a \_\_\_\_\_ direction to an end post marked No. 2, thence \_\_\_\_\_ feet in a \_\_\_\_\_ direction to a corner post marked No. 3, thence \_\_\_\_\_ feet in a \_\_\_\_\_ direction to a corner post marked No. 4, thence \_\_\_\_\_ feet in a \_\_\_\_\_ direction to a corner post marked No. 5, thence \_\_\_\_\_ feet in a \_\_\_\_\_ direction to a corner post marked No. 6, thence \_\_\_\_\_ feet in a \_\_\_\_\_ direction to said end post No. 2; hereby locating and intending to claim 1500 FT. feet in a NORTHERLY DIRECTION direction from discovery to the \_\_\_\_\_ end line, and \_\_\_\_\_ feet in the opposite direction from discovery to the \_\_\_\_\_ end line and \_\_\_\_\_ feet on each side of the middle of said lode or ledge, for the purpose of mining the same and claiming all surface rights, privileges, and minerals, with all dips, spurs, angles and variations, and other rights granted by existing laws and customs.

This claim is further described by reference to natural objects or permanent monuments, as follows:

LOCATED APPROX 1 MILE SOUTH OF BRIDGE CROSSING  
 EAST CANYON CREEK ON NATIONAL FOREST RD NO 123  
 APPROX 25 MI. SOUTH OF GRAYD HILL, CLAIM RUNNING  
 NORTHERLY 60° from Road 123

This notice is placed at Discovery on post No. 1; posts are placed at each corner, and the name of this lode, and date of location, are placed on all posts.

Located the 1st day of September, 1983

Mer. Fry  
Lethe Magee

Locators.

WITNESSES:

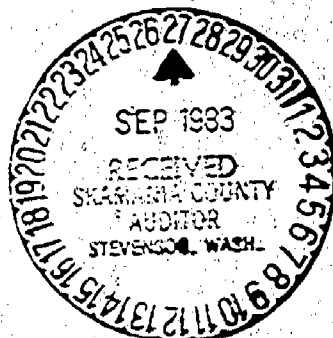

96441

BOOK 0

PAGE 658

STATE OF WASHINGTON  
 County of SKAMMIA } ss.

(Individual Acknowledgment)

I, GLEN FRY, do solemnly swear that I am a citizen of the United States of America (or have declared my intention to become such) and that I am acquainted with the mining ground described in the notice of location, and herein called the FRY CLAIM #1 Placer Mining Claim; that the ground and claim herein described, or any part thereof, has not, to the best of my knowledge and belief, been located according to the laws of the United States and this State, or if so located, that the same has been abandoned or forfeited by reason of failure of such former locators to comply in respect thereto with the requirements of said laws; and that I have performed the equivalent of at least \$100.00 in labor on such claim and have complied with all applicable laws of this State pertaining to this claim.

Subscribed and sworn to before me this 27TH day of SEPTEMBER 1983

Whitney Ann Davis  
 Notary Public in and for the State of WASHINGTON  
 residing at STANFORD in said County.

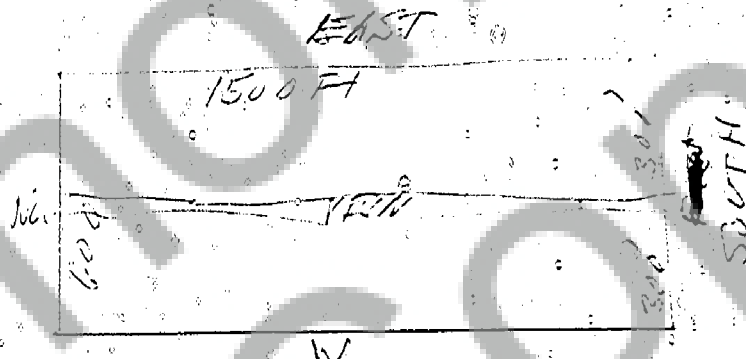

STATE OF WASHINGTON  
 COUNTY OF SKAMMIA } ss.  
 HEREBY CERTIFY THAT THE WITHIN

INSTRUMENT OF WRITING FILED BY

GLEN FRY

OF LONGVIEW, WA 98632

AT 3:50 PM SEP 27 1983

WAS RECORDED BY D

OF MINES 657

RECORD OF SKAMMIA CO., WASH

J. M. Olson

A. Davis