

## SHORT PLAT APPLICATION

Name Wilbur H. and Patricia Marsh (Home) Phone (Business) 493-2757  
Address Box 70 Underwood

Property to be divided

Location: Sec. 15 Twp. 3 N Range R 10 Tax Lot No. 3-10-15-1800

Water Supply Source P.M.D.

Sewage Disposal Method Septic Tanks

Date You Acquired Property 26 day of November 1966

To be signed by the Applicant:

I hereby certify that the legal description of the land to be divided, and accompanying this application, shows the entire contiguous land in which there is an interest by reason of ownership, contract for purchase, earnest money agreement, or option by any person, firm or corporation in any manner connected with the development, and listed below are the names, addresses, and telephone numbers of all such persons, firms or corporations. (If same as applicant named above, leave blank.)

(1) Name Veterans Administration Phone: \_\_\_\_\_  
Address Federal Building, 1220 S.W. Third Ave., Portland, Ore. 97204

(2) Name \_\_\_\_\_ Phone: \_\_\_\_\_  
Address \_\_\_\_\_

Wilbur H. Marsh + Patricia Marsh March 13, 1977  
(Signature of Applicant) (Date)

To be signed by the Applicant for Partial Exemption

I hereby certify the lots in this proposed short subdivision are not intended for residential, commercial or industrial purposes, and that the purpose is

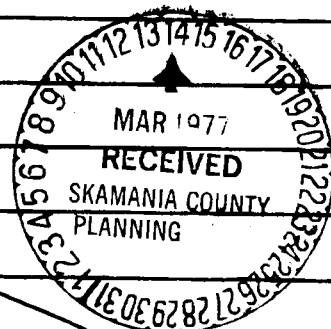
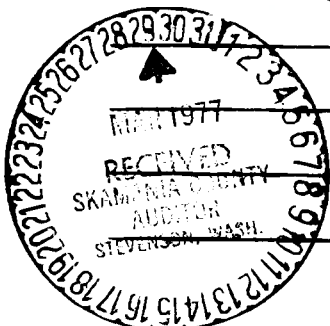

Signature of Applicant

Date

Klickitat Co  
Skamania Co

Northwestern  
Lake



Buck

Creek

Spring Cr

Marsh Short  
Plat

Underwood  
Heights

SKAMANIA CO | KLINKITAT CO  
HOOD RIVER

RIVER

VICINITY MAP

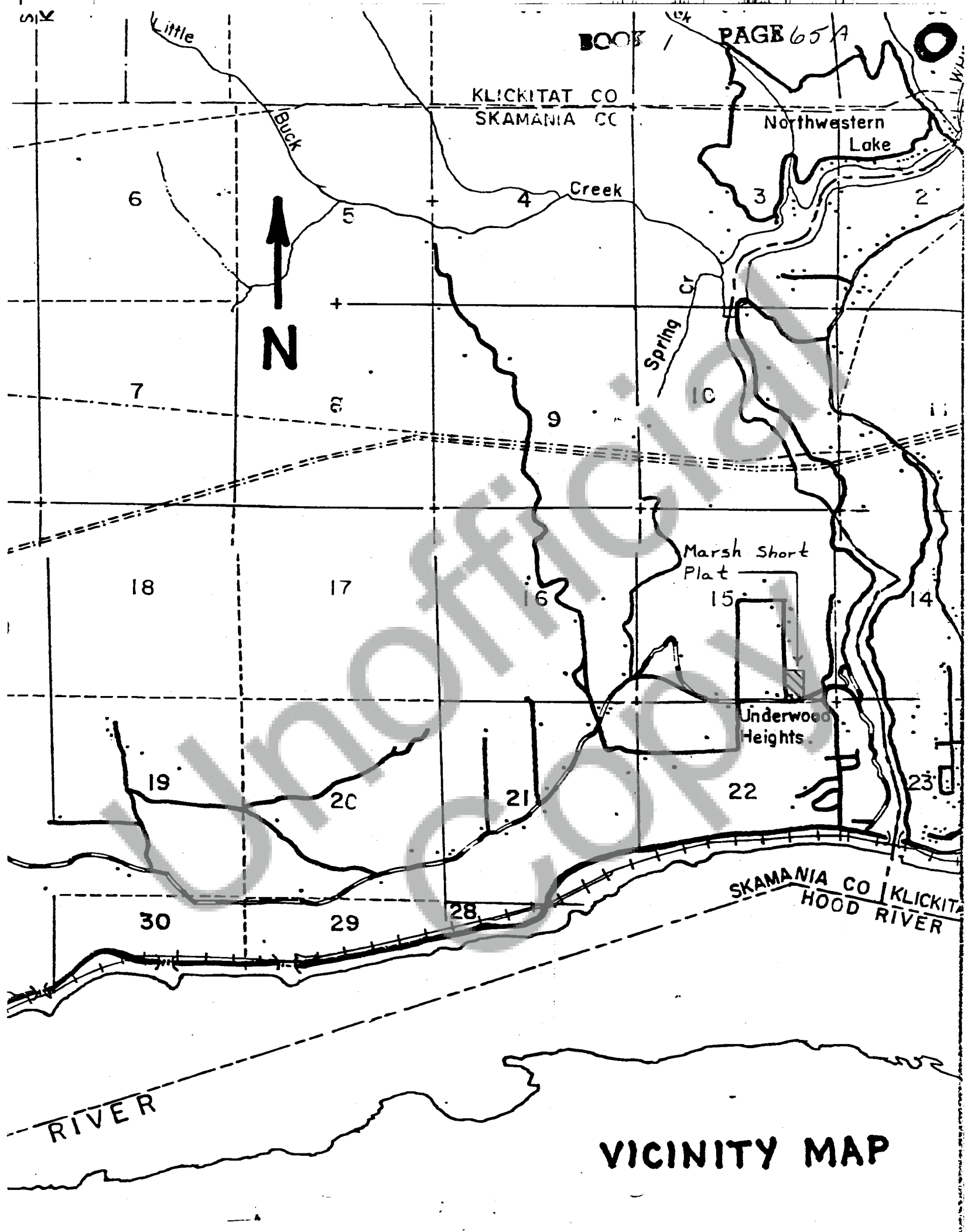

That portion of the Southeast  $\frac{1}{4}$  of the Southeast  $\frac{1}{4}$  of Section 15, Township 3 North, Range 10 East of the W. M., described as follows:

Beginning at a point on the West line of the Southeast  $\frac{1}{4}$  of the Southeast  $\frac{1}{4}$  of said Section 15 North  $00^{\circ} 24'$  East 220 feet from the Southwest corner of the Southeast  $\frac{1}{4}$  of the Southeast  $\frac{1}{4}$  of said Section 15; thence North  $00^{\circ} 24'$  East 660 feet; thence North  $89^{\circ} 43'$  East 698.78 feet; thence South  $00^{\circ} 18'$  East 536.28 feet to the Northerly right of way line of the County Road known and designated as the Cook-Underwood Road; thence South  $57^{\circ} 10'$  West along said Northerly right of way line 290.99 feet; thence South  $57^{\circ} 10'$  West along said Northerly right of way line 290.99 feet; thence South  $32^{\circ} 50'$  East 20 feet; thence following said Northerly right of way line South  $57^{\circ} 10'$  West 59.63 feet to the beginning of a curve to the right whose radius is 686.2 feet whose radius point bears North  $32^{\circ} 50'$  West of the beginning of said curve; thence Southwesterly along said curve 335 feet; more or less, to a point 106 feet East of the West line of the Southeast  $\frac{1}{4}$  of said Section 15; thence North  $00^{\circ} 24'$  East 185 feet, more or less, to a point North  $89^{\circ} 50'$  East from the point of beginning; thence South  $89^{\circ} 50'$  West 106 feet to the point of beginning.

Lot 1:

Beginning at the Southwest corner of the Southeast  $\frac{1}{4}$  of the Southeast  $\frac{1}{4}$  of said Section 15; thence North  $00^{\circ} 24'$  East 880 feet along the West line of said subdivision; thence South  $00^{\circ} 24'$  West along said West line, 93.5 feet to the True Point of Beginning of said Lot 1; thence North  $89^{\circ} 43'$  East 233 feet; thence South  $00^{\circ} 24'$  West 187 feet; thence South  $89^{\circ} 43'$  West 233 feet to said West line of said Southeast  $\frac{1}{4}$  of the Southeast  $\frac{1}{4}$  of said Section 15; thence North along said West line to the True Point of Beginning.

Lot 2:

Beginning at the Southwest corner of the Southeast  $\frac{1}{4}$  of the Southeast  $\frac{1}{4}$  of said Section 15; thence North  $00^{\circ} 24'$  East 880 feet along the West line of said subdivision; thence South  $00^{\circ} 24'$  West 280.5 feet to the True Point of Beginning; thence North  $89^{\circ} 43'$  East 233 feet; thence South  $00^{\circ} 24'$  West 187 feet; thence South  $89^{\circ} 43'$  West 233 feet to said West line of said Southeast  $\frac{1}{4}$  of the Southeast  $\frac{1}{4}$  of said Section 15; thence North along said West line to the True Point of Beginning.

TOGETHER with an easement for ingress, egress and utilities over, under and across the South 10 feet of the West 233 feet of the North 477.5 feet of the above described entire contiguous ownership, and subject to an easement for ingress, egress and utilities over, under and across the South 10 feet of said Lot 2.

Lot 3:

Beginning at the Southwest corner of the Southeast  $\frac{1}{4}$  of the Southeast  $\frac{1}{4}$  of said Section 15; thence North  $00^{\circ} 24'$  East 880 feet along the West line of said subdivision; thence South  $00^{\circ} 24'$  West along said West line 280.5 feet; thence North  $89^{\circ} 43'$  East 233 feet to the True Point of Beginning; thence continue North  $89^{\circ} 43'$  East 233 feet; thence South  $00^{\circ} 24'$  West 187 feet; thence South  $89^{\circ} 43'$  West 233 feet; thence North  $00^{\circ} 24'$  East 187 feet to the True Point of Beginning.

TOGETHER with an easement for ingress, egress and utilities over, under and across the South 20 feet of the West 233 feet of the North 477.5 feet of the above described entire contiguous ownership.

continued

Lot 4:

BOOK 1 PAGE 65C

That portion of the Southeast  $\frac{1}{4}$  of the Southeast  $\frac{1}{4}$  of Section 15, Township 3 North, Range 10 East of the W.M., described as follows:

Commencing at a point on the West line of the Southeast  $\frac{1}{4}$  of the Southeast  $\frac{1}{4}$  of said Section 15, North  $00^{\circ} 24'$  East 220 feet from the Southwest corner of the Southeast  $\frac{1}{4}$  of the Southeast  $\frac{1}{4}$  of said Section 15; thence North  $00^{\circ} 24'$  660 feet to the point of beginning; thence North  $89^{\circ} 43'$  East 698.78 feet; thence South  $00^{\circ} 18'$  East 536.28 feet to the Northerly right of way line of the County Road known and designated as the Cook-Underwood Road; thence South  $57^{\circ} 10'$  West along Said Northerly right of way line 290.99 feet; thence South  $32^{\circ} 50'$  East 20 feet; thence following said Northerly right of way line South  $57^{\circ} 10'$  West 59.63 feet to the beginning of a curve to the right whose radius is 686.2 feet and whose radius point bears North  $32^{\circ} 50'$  West of the beginning of said curve; thence Southwesterly along said curve 335 feet, more or less, to a point 106 feet East of the West line of the Southeast  $\frac{1}{4}$  of the Southeast  $\frac{1}{4}$  of said Section 15; thence North  $00^{\circ} 24'$  East 185 feet, more or less, to a point North  $89^{\circ} 50'$  East from the commencement point of this description; thence South  $89^{\circ} 50'$  West 106 feet to a point on the West line of said SE  $\frac{1}{4}$  of the SE  $\frac{1}{4}$ ; thence North  $00^{\circ} 24'$  East 192.5 feet, more or less, to a point 467.5 feet South of the point of beginning; thence North  $89^{\circ} 43'$  East 466 feet; thence North  $00^{\circ} 24'$  East 187 feet; thence South  $89^{\circ} 43'$  West 233 feet; thence North  $00^{\circ} 24'$  East 187 feet; thence South  $89^{\circ} 43'$  West 233 feet to the West line of said Southeast  $\frac{1}{4}$  of the Southeast  $\frac{1}{4}$  of said Section 15; thence North  $00^{\circ} 24'$  East along said West line 93.5 feet to the point of beginning.

This Company hereby certifies that the foregoing legal description is sufficient for title insurance purposes.

SKAMANIA COUNTY TITLE COMPANY

By:

*[Signature]*  
Manager

Wilbur & Patricia Marsh  
Short Plat  
Section 15, T. 3 N., R. 10 E., W. M.

BOOK 1

PAGE 55A

Phyllis Everett

N 89° 43' E  
698.78'

Martha Lehman

Kermit Brown

Orchard Lane Road

James  
Creighton

S.W. Cor SE 1/4 - SE 1/4

Lot - 1  
1 Ac.

Lot - 2  
1 Ac.

Lot - 3  
1 Ac.

Lot - 4  
7.68 Ac.

Curve Radius  
686.2' @ N 32° 50' W  
From Beginning of  
Curve



Phyllis Everett

Scale: 1" = 100'

George De Groot

Cook-Underwood Road

SHORT PLAT APPLICATION: CERTIFICATIONS BY COUNTY OFFICERSMinimum Lot Size

I hereby recommend that a minimum lot size of 12,000 ft<sup>2</sup> will apply to the above proposed Short Subdivision for the following reasons:

*public water available to each lot.*

Signed Tom Bernhard R.S. Date 3/18/77  
Southwest Washington Health District.

The above recommendation is for the short subdivision as a whole, and each lot may be subject to inspection and analysis in regard to sewage disposal systems, on an individual basis. Although the ordinance specifies minimum lot sizes, the district health officer may recommend larger lot sizes because of limited soil conditions, steep slopes, protection of surface and ground waters, and other site features.

Taxes and Assessments

I hereby certify that the taxes and assessments have been duly paid, discharged or satisfied in regard to the lands involved with the above proposed Short Subdivision.

Skamania County Treasurer

Signed Karen Wyringer Date 3-29-1977

Summary Approval

I hereby certify that this Short Subdivision complies with County Ordinance No. 1974-2, relating to Short Plats, and is approved subject to recording in the Skamania County Auditor's Office within thirty days.

Skamania County Planning Department

Signed Robert P. Lee Date March 29, 1977

NOTE: The original and one copy of your Short Plat map and related data will be forwarded to the County Auditor for recording by you within thirty (30) days.

83762

STATE OF WASHINGTON }  
COUNTY OF SKAMANIA }

I HEREBY CERTIFY THAT THE WITHIN

INSTRUMENT OF WRITING, FILED BY

Pharmacy Dept

OF Skamania Co.

AT 10:30 A.M. THIS 29<sup>th</sup> 1927

WAS RECORDED IN BOOK 1

OF Skamania AT PAGE 65

RECORDS OF SKAMANIA COUNTY, WASH

W. P. Todd  
COUNTY AUDITOR

E. Meador  
DEPUTY

|                    |
|--------------------|
| REGISTERED         |
| INDEXED: DIR.      |
| INDEXED: <u>✓</u>  |
| RECORDED: <u>✓</u> |
| COPIED: <u>✓</u>   |
| MAILED             |